

There was an effort so construct the roof using sustainable methods. I achieved this by using a thermoplastic polyolefin (TPO) roofing material. This particular type of roofing system is referred to as a cool roof, since it counteracts the heat island effect experienced with traditional bitumen roof. This cool roof reflects the sun's rays instead of absorbing them.  
 1. TPO membrane; 2. Fastening element for thermal insulation; 3. Fastening element for TPO membrane; 4. Thermo insulation; 5. Vapor insulation; 6. Corrugated board; 7. Roof beam.

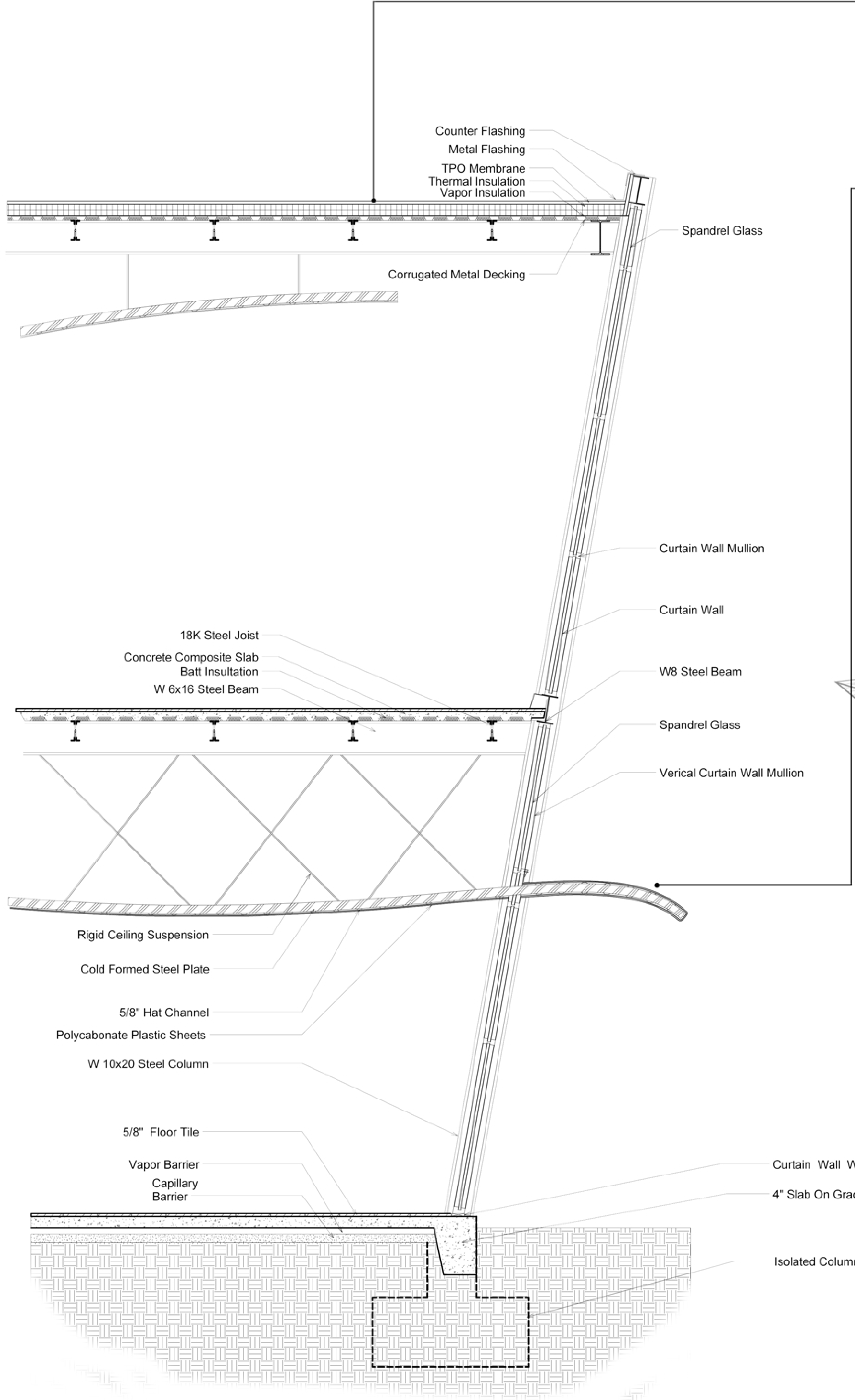

Wall Detail  
 Scale: 3/4" = 1'

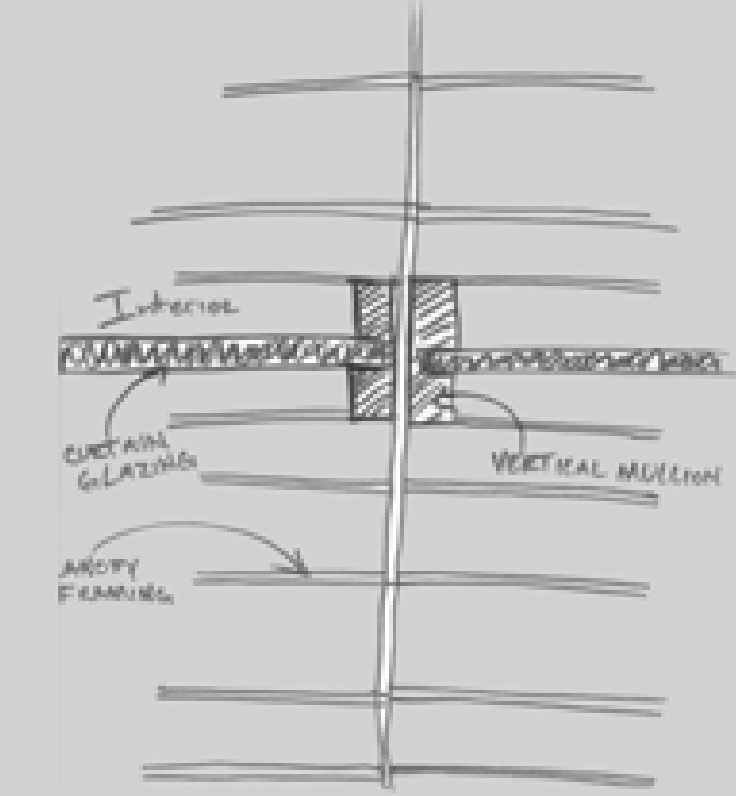

The interior ceiling and exterior canopy is covered with translucent poly carbonate plastic sheets. The framing that supports the ceiling/canopy system is diagramed to the left. The vertical mullions are two separate ones instead of one continuous one. This allows the framing elements to slip between the mullion to continue to the exterior to frame the canopy.

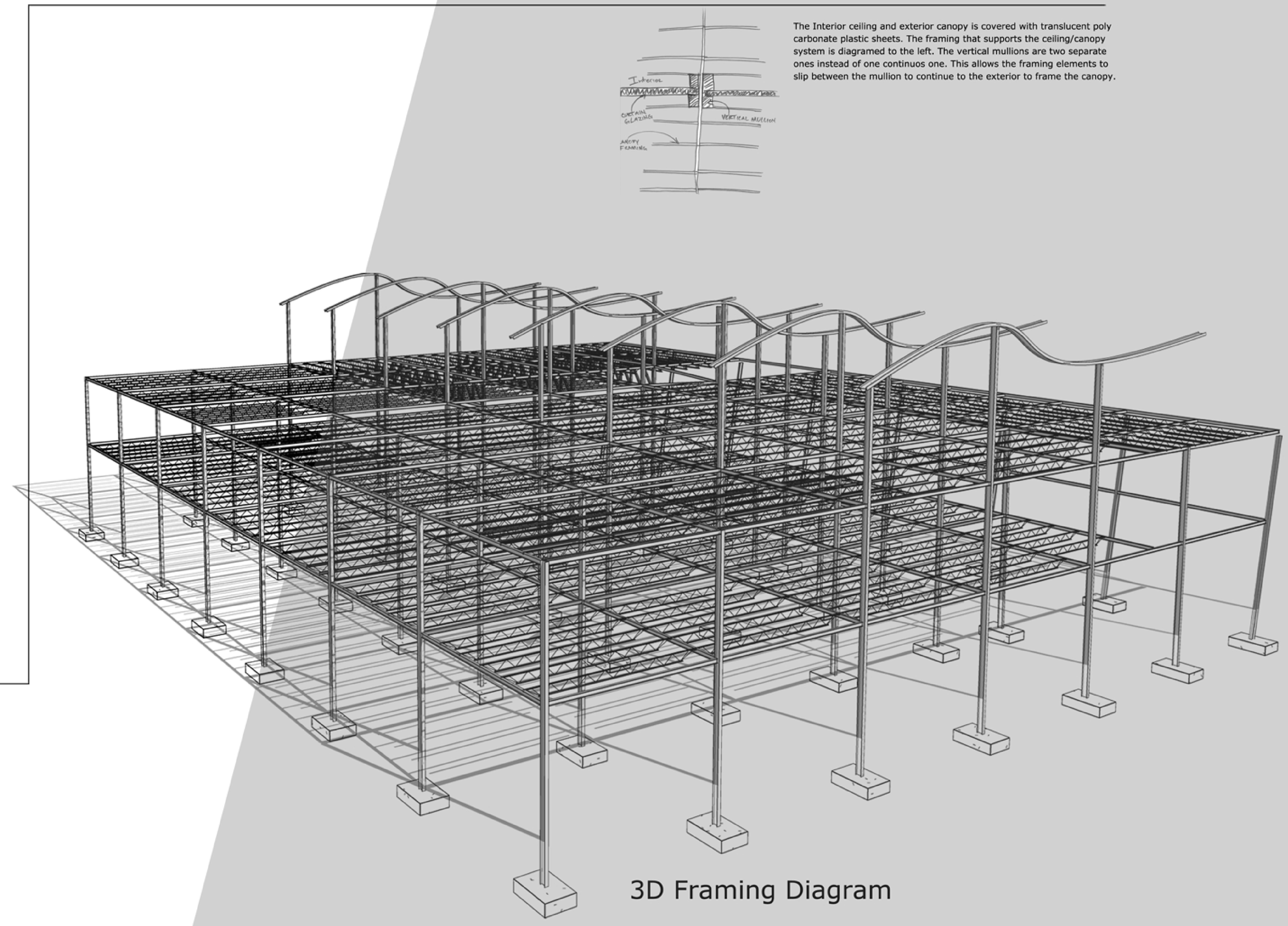

3D Framing Diagram

Building  
 Structure

The structural system for The Park Heights Community Centre is a steel Beam and column system. The structural system uses a base grid that is 22'x28'. Within the grid there are also self supporting curtain walls as well. The roof of the residential level is framed using hot rolled pre-fabricated beams, to create the unique free-form profile of the roof.