

This drawing remains the copyright of MS Planning Ltd. This drawing is to be read in conjunction with all other drawings and documents issued. All discrepancies between any drawings and documents shall be notified to MS Planning Ltd immediately and prior to proceeding with the works. Work to figured dimensions only. Do not Scale.

THIS DRAWING IS SOLELY FOR THE PURPOSE OF OBTAINING BUILDING CONTROL APPROVAL

Proposed Floor Areas

Ground Floor - 137 sqm

First Floor - 83 sqm

For detailed drainage information please refer to Structural Engineers drainage drawing (58936/02)

Legend

- self-closing device to habitable rooms
- 30 minutes fire resistance to doors
- 30 minutes fire resistance to enclosure
- internal walls & floors to achieve min 40 rw dB to comply with requirement E2

Construction to be carried out in accordance with TSO robust details for limiting thermal bridging and air leakage.

Results of air test to be submitted to the building control department

Rev.	Date	Description	D



1st Floor Union House,
Union Street,
St Helier, Jersey
JE2 3RF

t. 01534 869425
f. 01534 869825
e. info@msplanning.co.uk
w. msplanning.co.uk

Client: **MR . C. FOSSE**

Project: **LA CLAIRE FONTAINE, ST. MARTIN**

Drawing: **PROPOSED PLANS**

Drawn: **JL**

Checked:

Scale: **1:50**

Date: **JULY 19**

Drg. no. **MSP-2483-BC04**

Rev
A

VENTILATION CALCULATIONS (Ground Floor)

Master Bedroom
Total Floor Area: 32m2
Rapid Ventilation Required: 1.6m2
Rapid Ventilation Achieved: 6.97m2

Master Ensuite
Total Floor Area: 13m2
Rapid Ventilation Required: 0.65m2
Rapid Ventilation Achieved: 0.00m2
15L Mechanical Extract

Study / Bedroom
Total Floor Area: 12m2
Rapid Ventilation Required: 0.6m2
Rapid Ventilation Achieved: 6.97m2

Bathroom
Total Floor Area: 5.7m2
Rapid Ventilation Required: 0.285m2
Rapid Ventilation Achieved: 0.00m2
15L Mechanical Extract

Bedroom 2
Total Floor Area: 16.5m2
Rapid Ventilation Required: 0.825m2
Rapid Ventilation Achieved: 6.97m2

Bedroom 3 Ensuite
Total Floor Area: 4.6m2
Rapid Ventilation Required: 0.23m2
Rapid Ventilation Achieved: 0.00m2
15L Mechanical Extract

Bedroom 3
Total Floor Area: 15.6m2
Rapid Ventilation Required: 0.78m2
Rapid Ventilation Achieved: 6.97m2

Utility
Total Floor Area: 4.2m2
Rapid Ventilation Required: 0.21m2
Rapid Ventilation Achieved: 0.00m2
15L Mechanical Extract

VENTILATION CALCULATIONS (First Floor)

Kitchen / Living / Dining
Total Floor Area: 83m2
Rapid Ventilation Required: 4.15m2
Rapid Ventilation Achieved: 20.91m2
30L Mechanical Extract

foul drainage connects to foul sewer connection in driveway before connecting into public foul sewer in Rue de la Cote

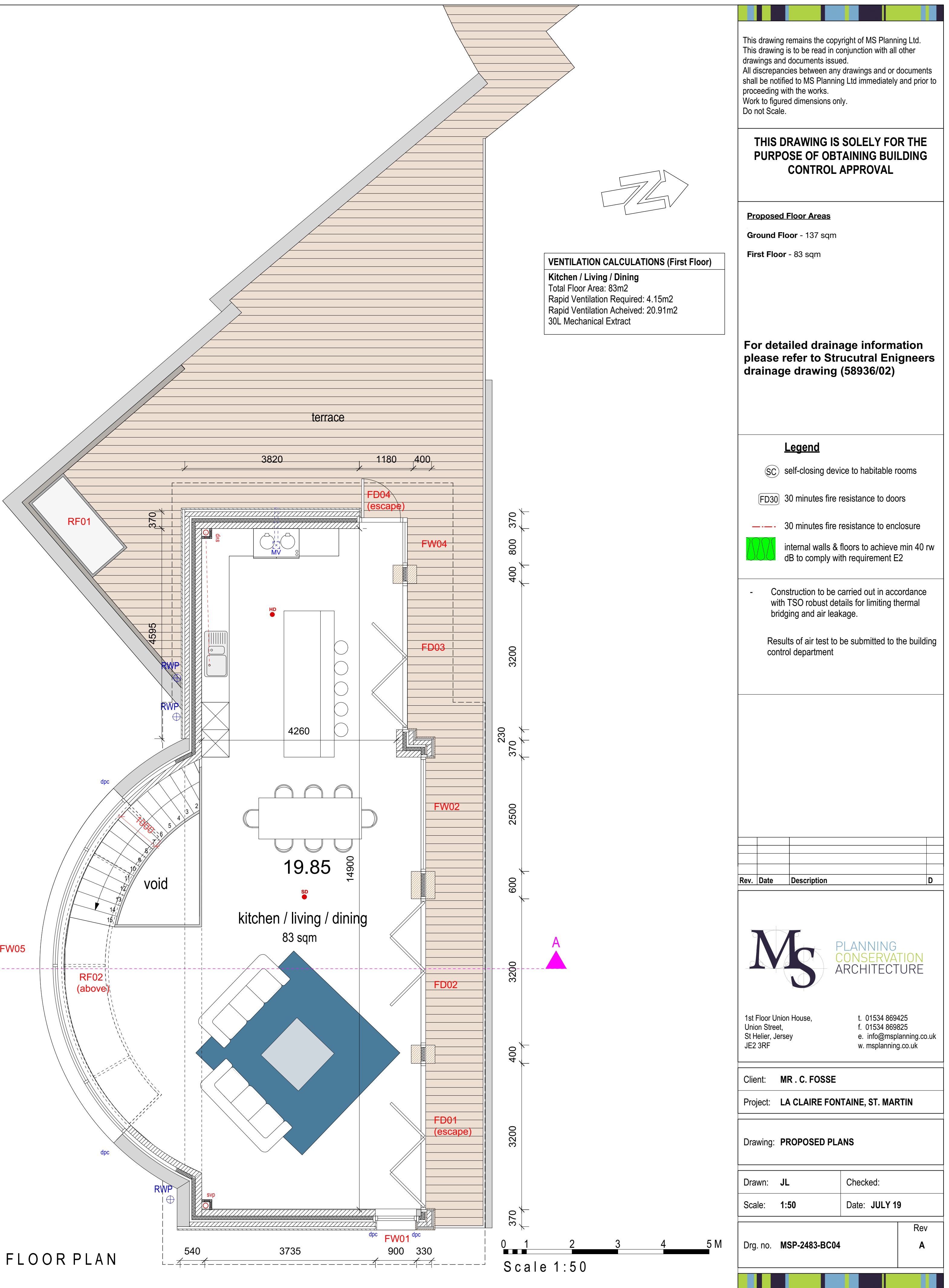
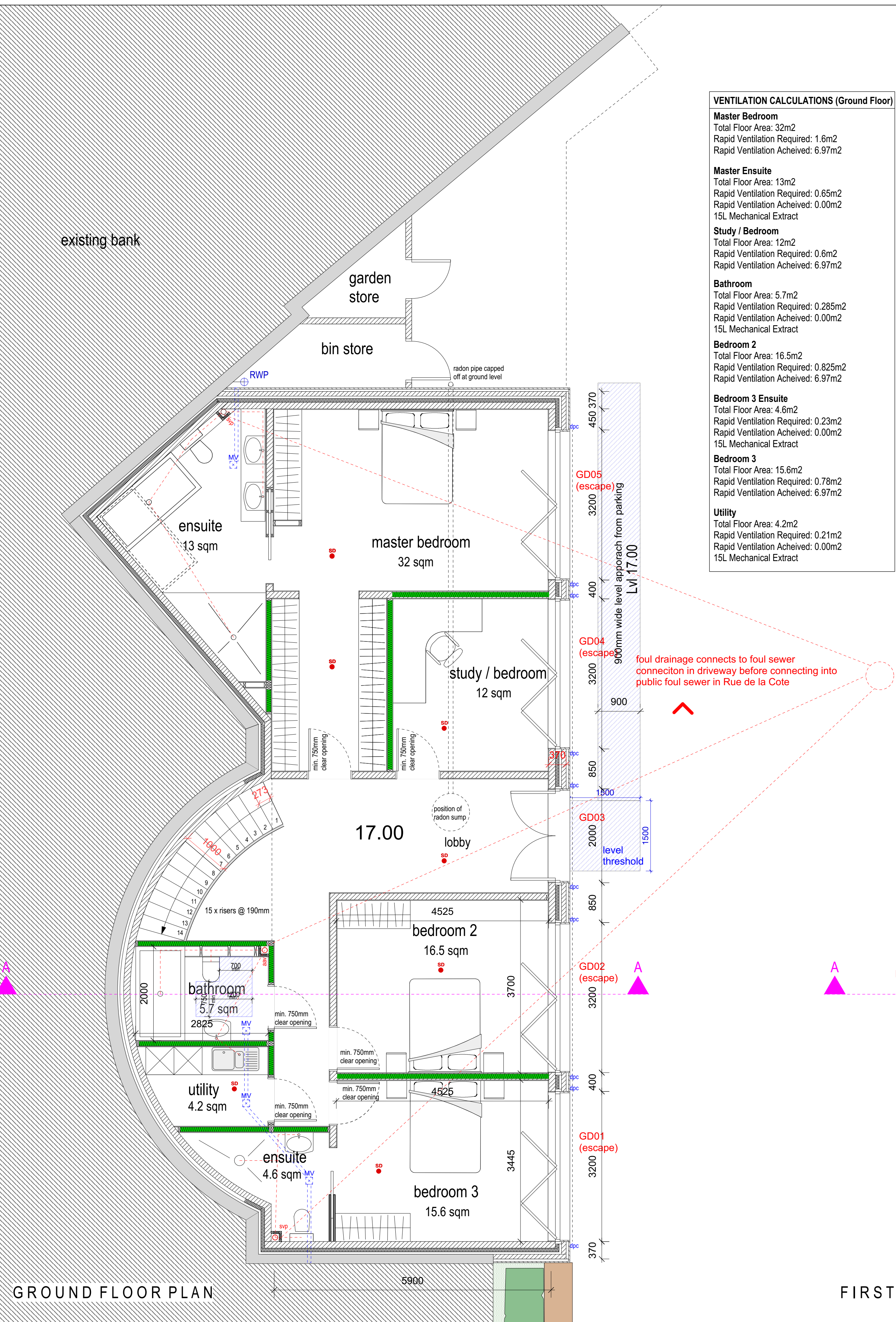

GROUND FLOOR PLAN

FIRST FLOOR PLAN

Scale 1:50