

1 WALL SECTION
A4.2 SCALE: 3/4" = 1'-0"

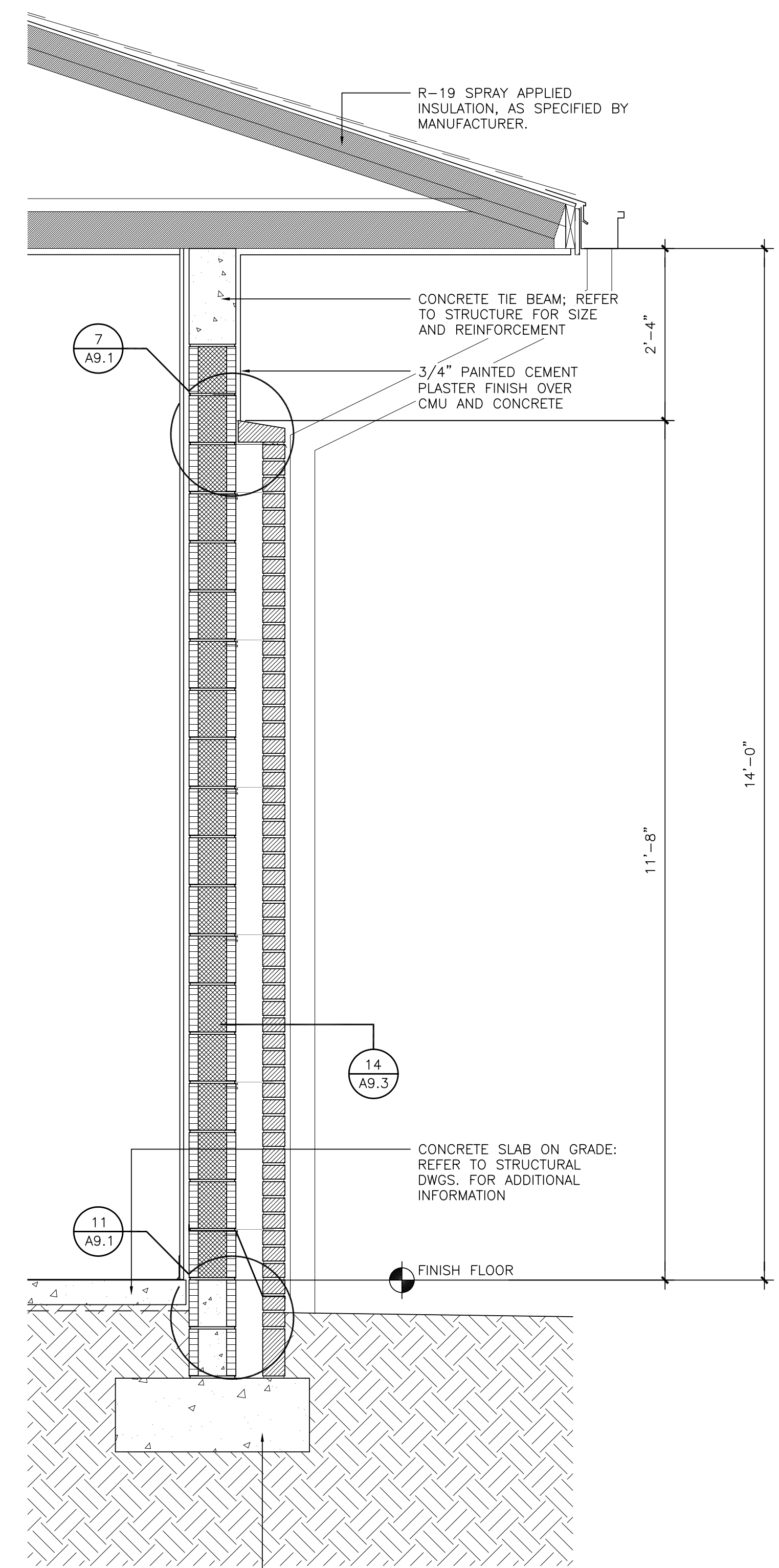

2 WALL SECTION
A4.2 SCALE: 3/4" = 1'-0"

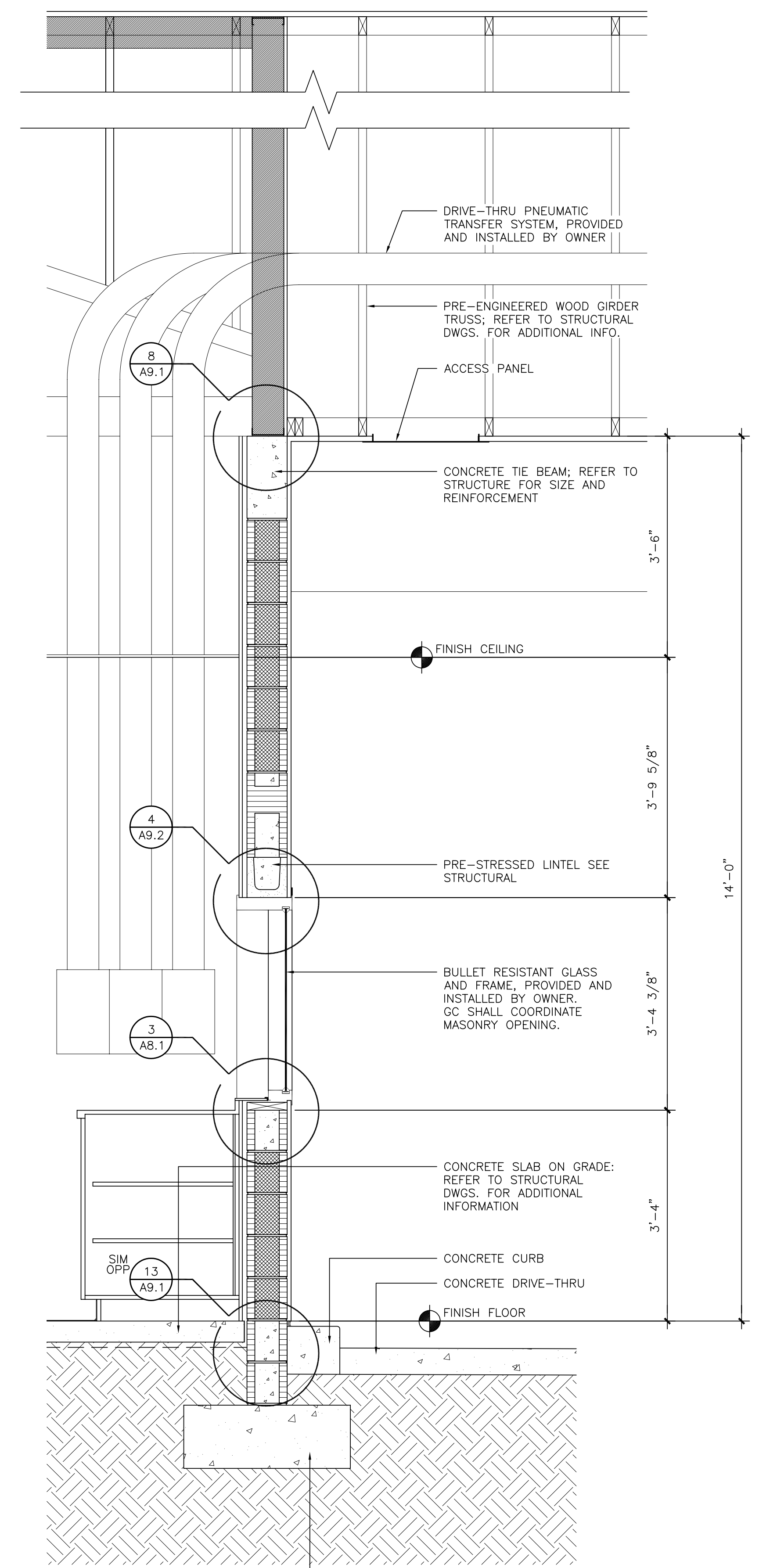

3 WALL SECTION
A4.2 SCALE: 3/4" = 1'-0"

ARCHITECT
HOLMES HEFNER & ASSOCIATES ARCHITECTS
109 NORTH BRUSH STREET, SUITE 100
TAMPA, FLORIDA 33602
813-229-0814
REG. NO. AA 0002617

CIVIL ENGINEER AND LANDSCAPE
TOM CONSULTING, INC.
8695 COLLEGE PARKWAY, SUITE 106
FORT MYERS, FLORIDA 33919
239-433-4231
REG. NO. P03000072719

STRUCTURAL ENGINEER
CATALANO ENGINEERING, INC.
120 SOUTH EDSON AVE.
TAMPA, FLORIDA 33606
813-254-1255
REG. NO. 6828

MECHANICAL, ELECTRICAL, & PLUMBING ENGINEER
ANSTON-GREENLEES, INC.
1315 WEST FLETCHER AVE.
TAMPA, FLORIDA 33612
813-963-1919
REG. NO. 6993

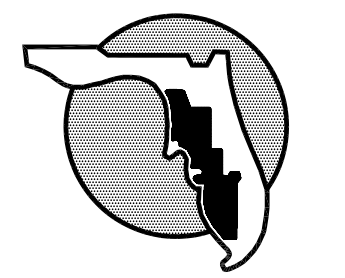

SUNCOAST
SCHOOLS
FEDERAL
CREDIT UNION

CAPE CORAL
MEMBER SERVICE CENTER

PROJECT NO.	2856
DISTRIBUTION DATE	
CONSTRUCTION DOCUMENTS	07/11/2007

WALL
SECTIONS

A4.2