

SIMIN YU
PORTFOLIO

2013-2017

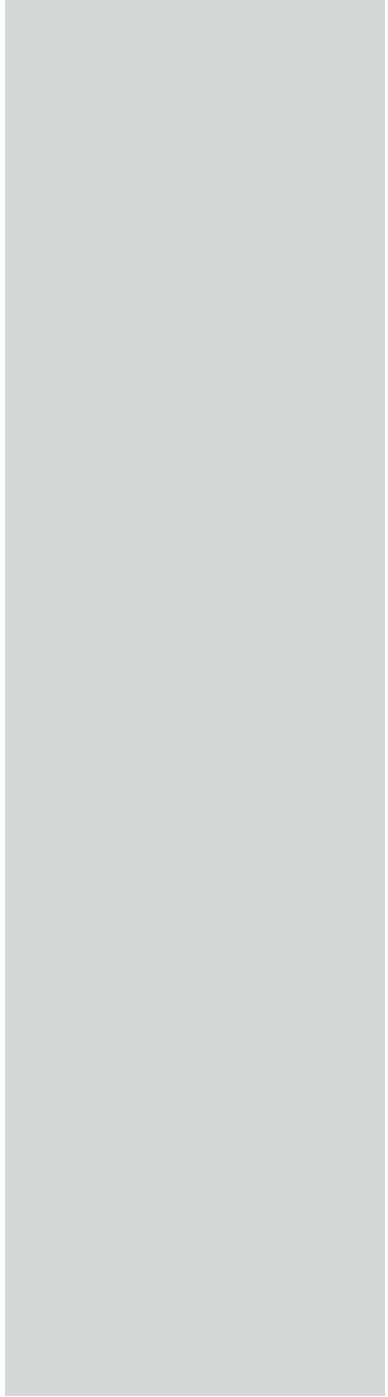

SIMIN YU

Address: 1621 S Ira St. bloomington,IN. 47401

Phone : 8123619698

Email : yusimi@indiana.edu

EDUCATION

INDIANA UNIVERSITY BLOOMINGTON\

BACHELOR DEGREE

BA MAJOR:INTERIOR DESIGN. SCHOOL OF ART, ARCHITECTURE AND DESIGN

DEC.2017

EXPERIENCE

ZHEJIANG UNIVERSITY OF TECHNOLOGY ENGINEERING DESIGN GROUPCO.,LTD

ASSOCIATE DESIGNER

MAY-JULY 2014

OVERSEA STUDY

BARCELONA, SPAIN

FOCUS ON PUBLIC DEISGN

MAY-JUNE 2017

SKILLS

AutoCAD

Revit

Rhino

Sketchup

Photoshop

Indesign

Illustrator



CONTENTS

INTERIOR DESIGN

01 _____ Barcelona Public Furniture

02 _____ Urgency

DESIGN PROJECTS

04 _____ Wearable Bracelet

05 _____ Skin and Bone

06 _____ Wood Frame

07 _____ Octopus

ART PROJECTS

08 _____ Drawings

09 _____ Synergia

RECREATION SQUARE

PUBLIC SPACE PLANNING IN BARCELONA

SUMMER 2017

The design seek to strategically divide the space into three segments. And divided people by different needs using this space. At the center of the project is a view point for seniors nearby talking to each other and works as a landmark of the plaza. The two sides are flowing ramps for children and locals who walk their dogs. Also, the elevation changes makes a mer-gence between high and tight locals buildings and flat tourism space.

The concept of this project is to blance the tourism and locals' life. Both of the tourists and locals are able to get relaxing in this space at the same time.

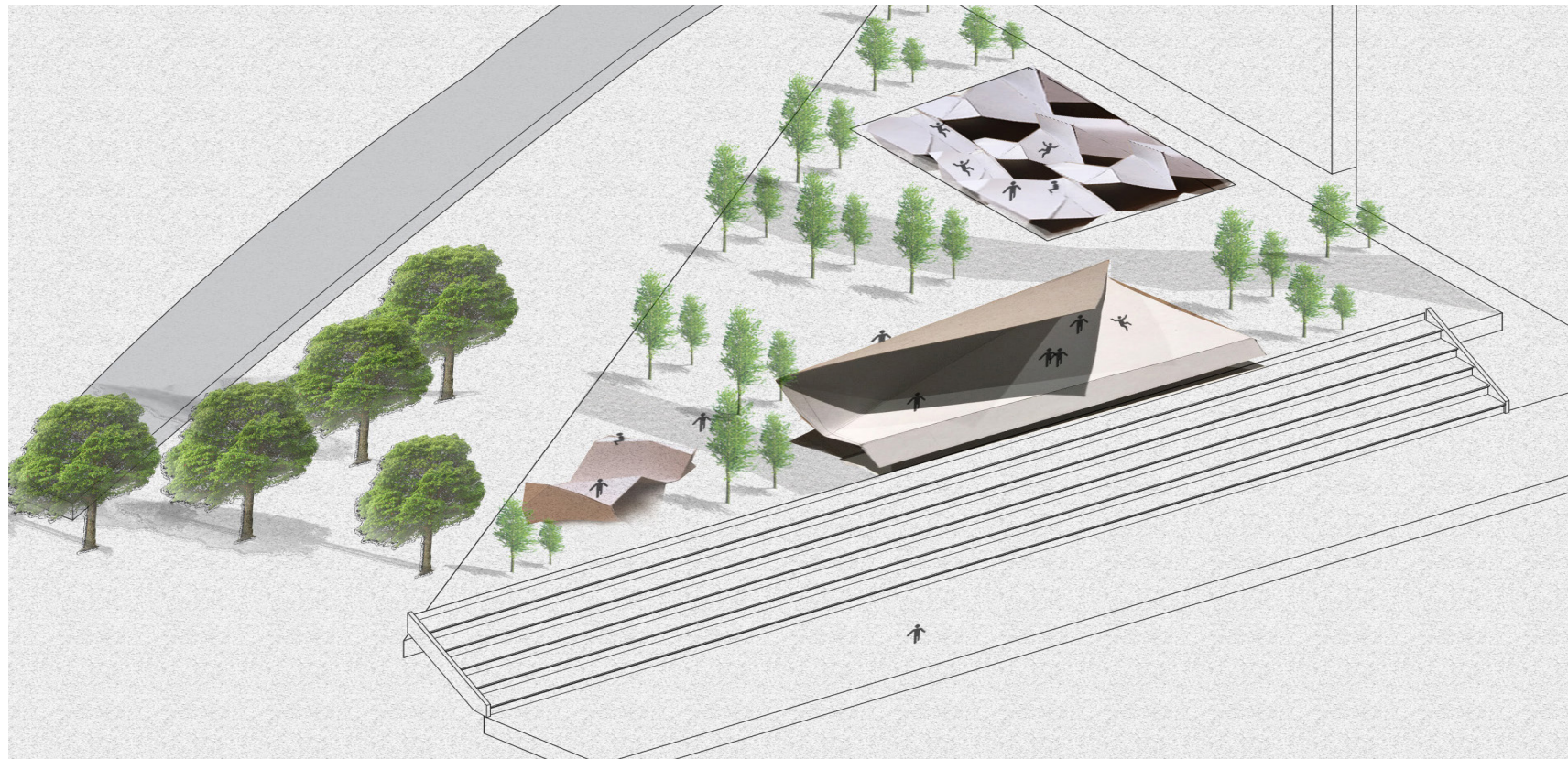
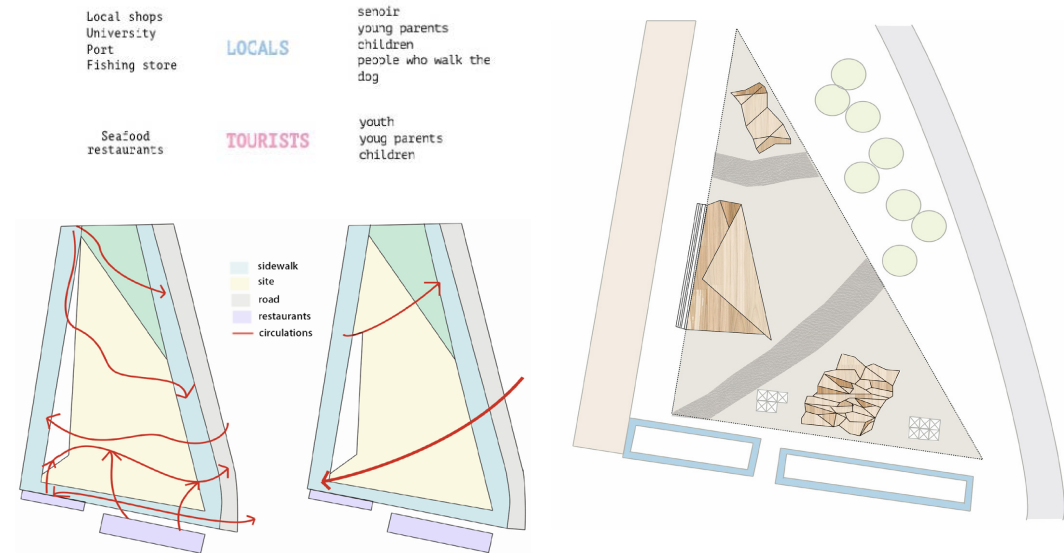

U R G E N C Y

Amazonian Rainforest Service-learning Center

FALL 2016

In Urgency, our focus was the urgency behind the work being done within the service-learning space. Individuals involved in preparations for their trip must be able to learn effectively while understanding how their classroom work translates into actual changes in the Amazon.

This object serves as a physical and metaphorical reminder of the extinct and at-risk species, tribes, and individuals abroad that the service-learning members are seeking to preserve. The large presentation screen acts as a live window into the situation 'on the ground'. What is hap-pening in this small building in Miami will have greater effects in the real world.



FOLDING BARCELET

PATTERN AND 3D PRACTICE

SPRING 2017

Inspired by twisted stems and leaves from nature. And the concept of a combination of organic form with modern materials. Also, I used paper folding technic which is from Yoshida lighting. I folded origami pattern and twist the pattern. For the material, I chose foldable metallic poster board. The letter "S" is also a symbol of my name.

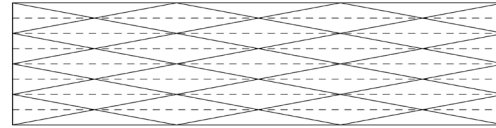

SKIN AND BONE

LASER CUT(RHINO)

SPRING 2017

This project is a interpretation of relationship of skin and bone. I interpreted in a abstract way: people can be a rectangle box. Acrylic works as the skin, thread works as the bones. The bones connect to the skin a lot. I also used a mathematical model as the original form. For the color choosing, I used red, orange and yellow---three of the most vibrant colors--- to show the inner energy of a person. And I also balance the color gradients: 4 for red threads, 5 for oranges and 6 for yellows.

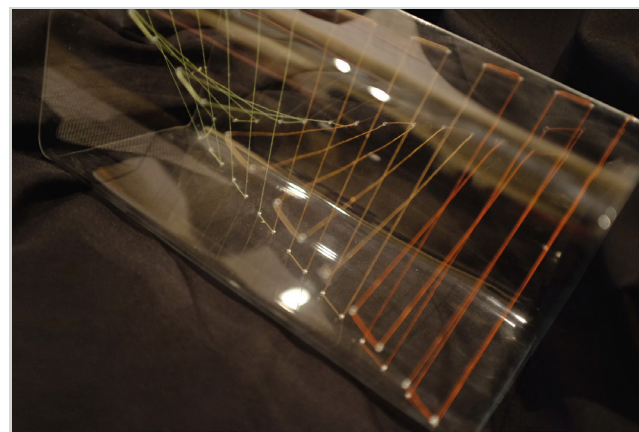
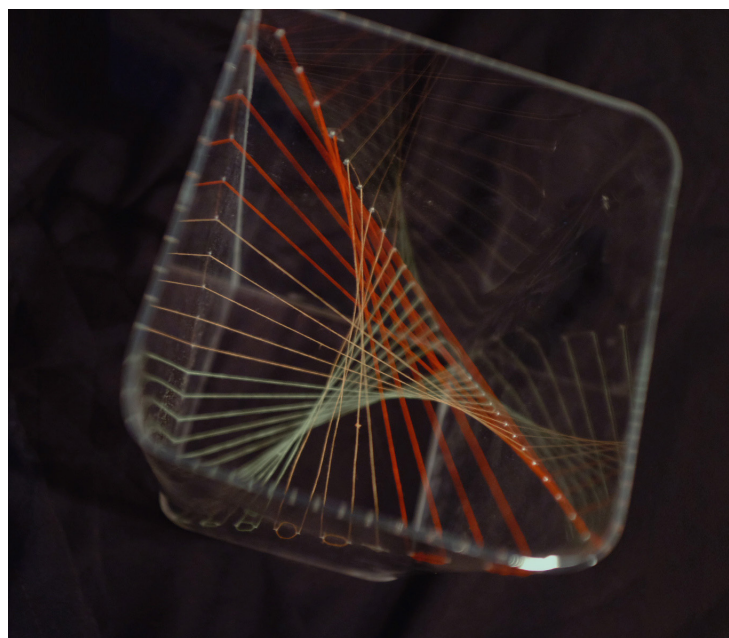
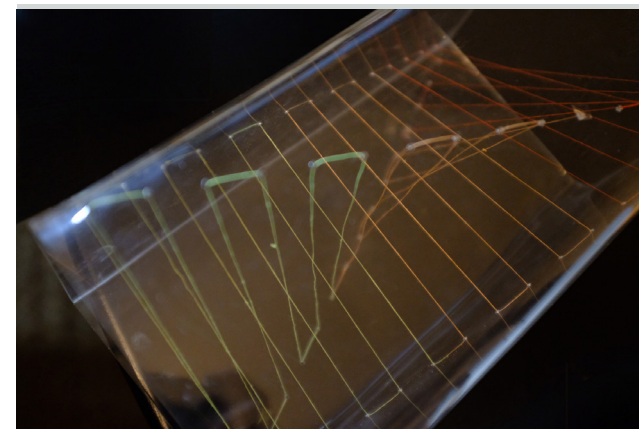
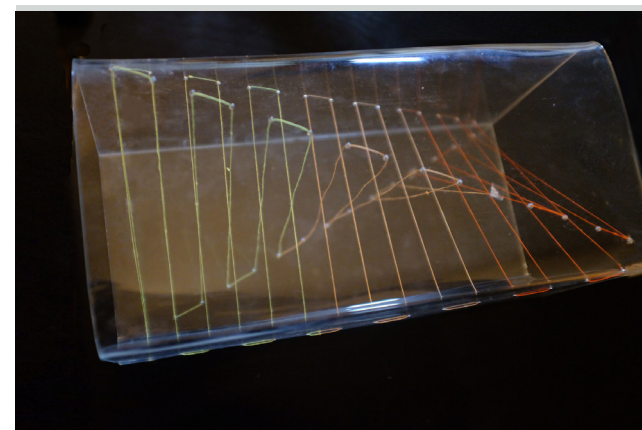
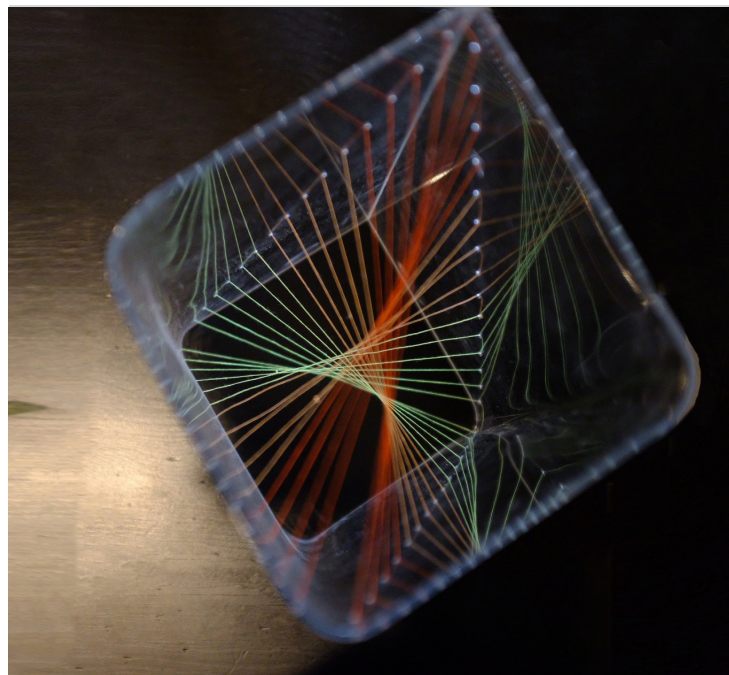

WOOD FRAME

3D WOOD CUT

SPRING 2017

This piece was built from seven similar sizes and compositions linear framework units . My units are distorted squares. By distorting them in different ways, the project varies each sides. And I align up each edge to make a clean contour. It could be an installation, you can get different views for different angle.

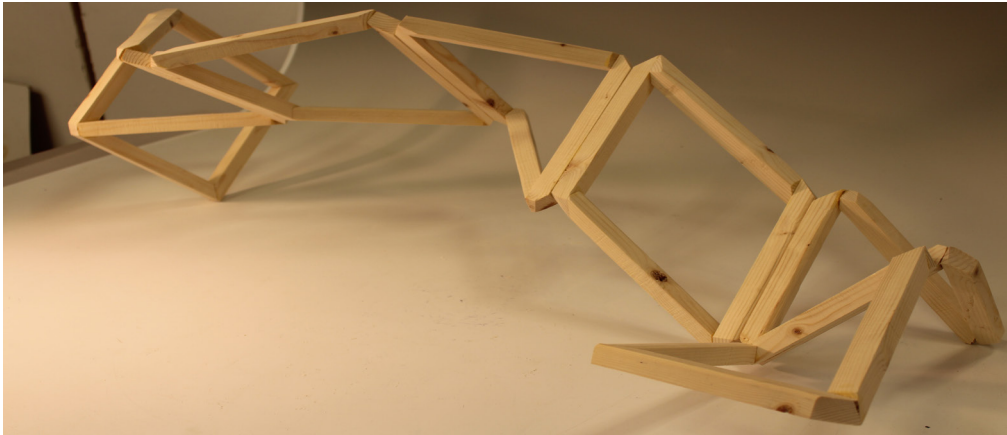

OCTOPUS

FURNITURE DESIGN

SPRING 2015

A chair design was inspired by octopus. I use rhino for modeling the shape and texture.

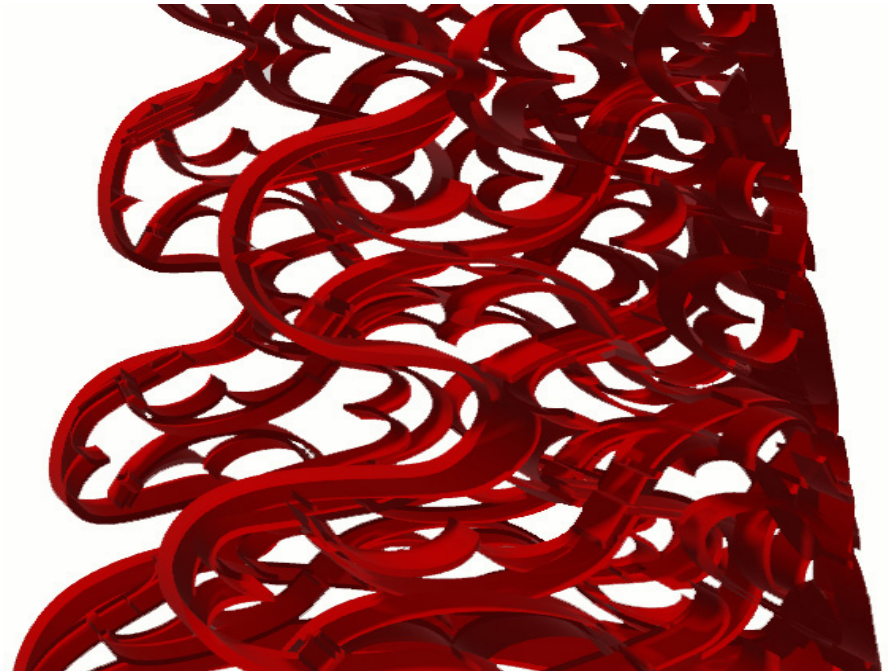
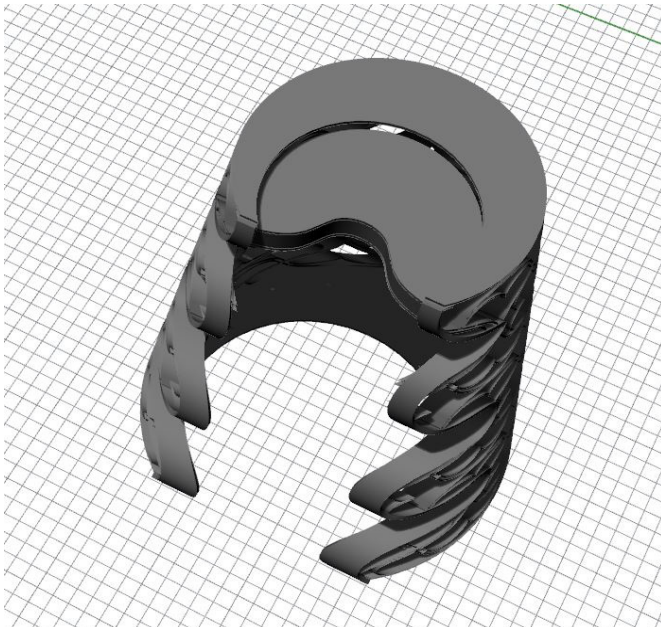
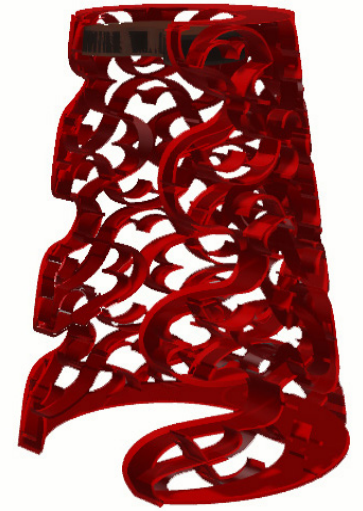
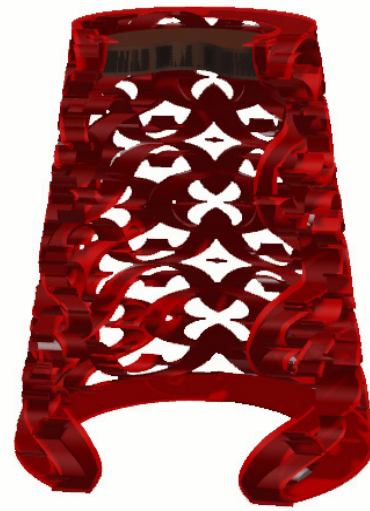
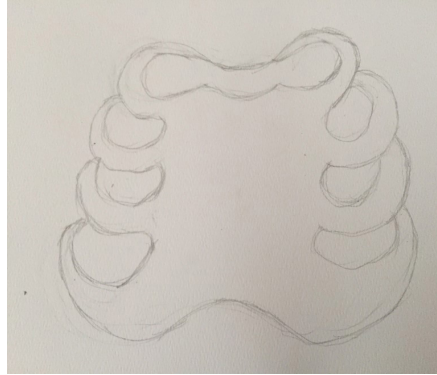

DRAWINGS

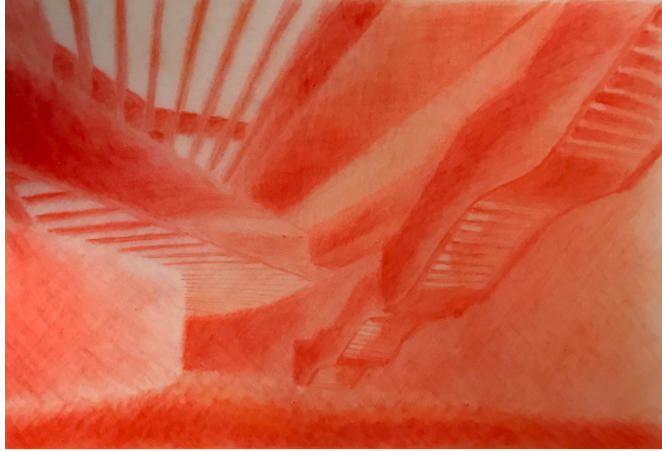

SYNERGIA

INSTALLATION

SPRING 2017

UNIT ASSEMBLY DIAGRAM

INDIVIDUAL UNIT ASSEMBLY

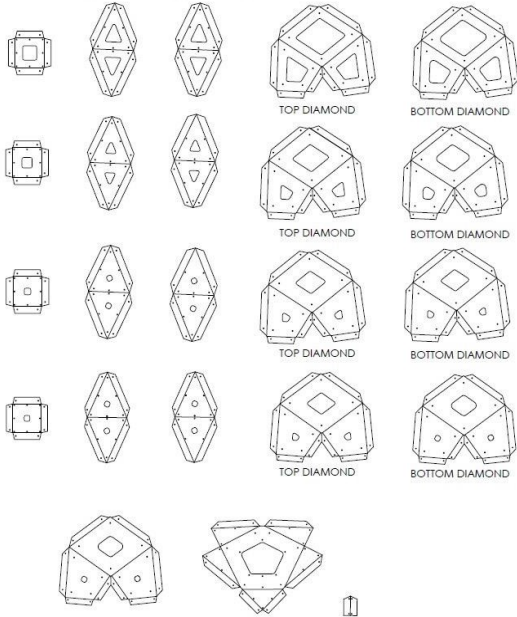

MULTIPLE UNIT ASSEMBLY

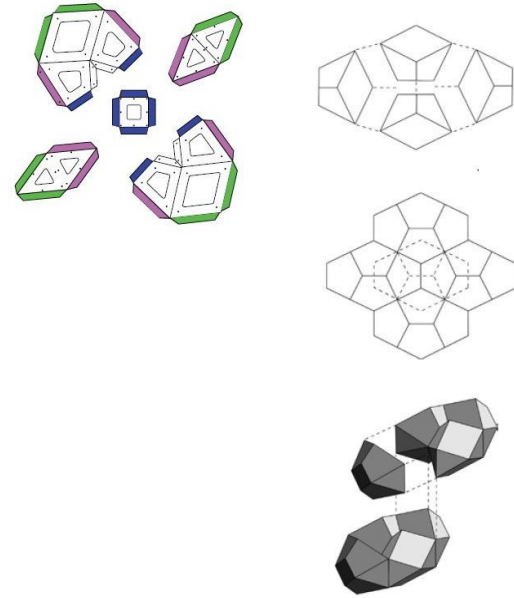

FABRICATION TOOLS



STRUCTURE ASSEMBLY DIAGRAM

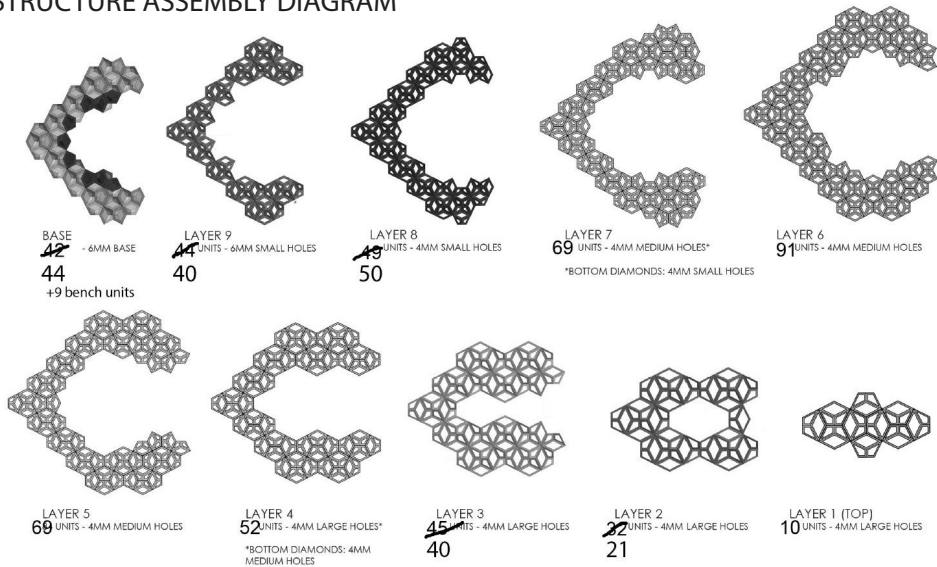

THANKS



Contact Me

Address: 1621 S Ira St. bloomington, IN. 47401

Phone : 8123619698

Email : yusimi@indiana.edu