

**Nimesha Ashok Padman  
Architectural Portfolio**



Nimesha Ashok Padman

Urban Design to me is a breathing space that binds a city. I believe that a healthy environment is essential for binding the inhabitants to their city. Adding a land-architectural vocabulary to the existing fabric ensures that people indulge in diverse experiences.

Referring to these statements, I started observing a human behavior with open spaces, public spaces and so on. It was amazing to see people respond to these different spaces.

On site participation in decision making, material selection and execution was the best part of my professional practice earlier. Thereafter, I started observing master planning projects, open public spaces across cities.

This portfolio is a compilation of my undergraduate, professional and current studio work which has greatly helped me explore the aesthetic, spatial and experiential concepts of design further streamlining my interest to the field of Urban design and Architecture.



### United States Of America

#### Education

**2016-17 M.S. Architecture, Urban and Regional Design**  
New York Institute of Technology  
New York, NY

#### Work Experience

**2017 Graduate Assistant**  
New York Institute of Technology  
Interdisciplinary Studies

**2017 Fab- Lab Assistant**  
New York Institute of Technology  
School of Architecture

**2014-16 Planning Intern**  
Office of the Manhattan Borough  
President  
Land-Use

**2014-16 Design Intern**  
New York City Housing Authority  
Energy and Sustainability

#### Skills

Microsoft Suite  
AutoCad 2d  
Corel Draw  
Adobe Suite  
Sketchup + Vray  
Lumion  
Rhino + Honey bee



### India

#### Education

**2014 Bachelore of Architecture**  
Rachana Sansad's Academy of Architecture  
Mumbai, India

#### Work Experience

**2014-16 Designer**  
DesignCell  
Mumbai, India

**2014-16 Architectural Intern**  
Malik Architecture  
Mumbai, India

#### Awards

**2009-14 National Association of Students of Architecture**  
Led and won the first Special mention in landscape design  
First Citation in Louis. I. Kahn Trophy

**2012-16 National Association Of the Blind**  
Taught 70 students of tenth grade



Email:npadman@nyit.edu



The project envisioned the city to benefit with the natural water system that form the urban open spaces MAKING ROOM for a vertical mixed neighbourhood inspired by

\* Tony Garniers \_ Industrial city forming avenues and armatures  
\* Barcelonas super block

01

“Making Room” .....

..... Brooklyn Navy Yards

# The Future Network of public realm

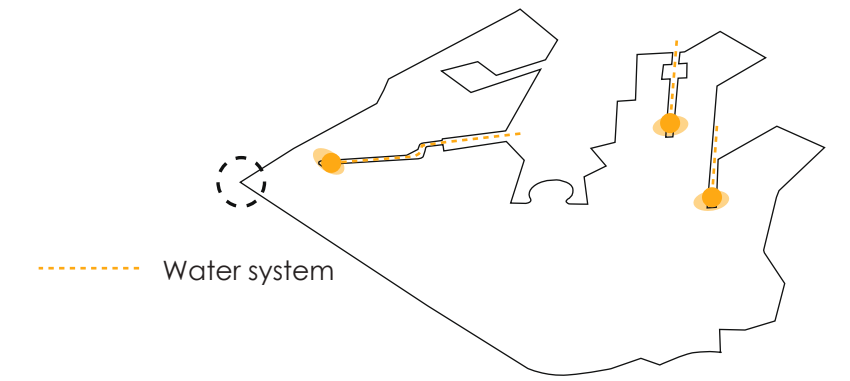
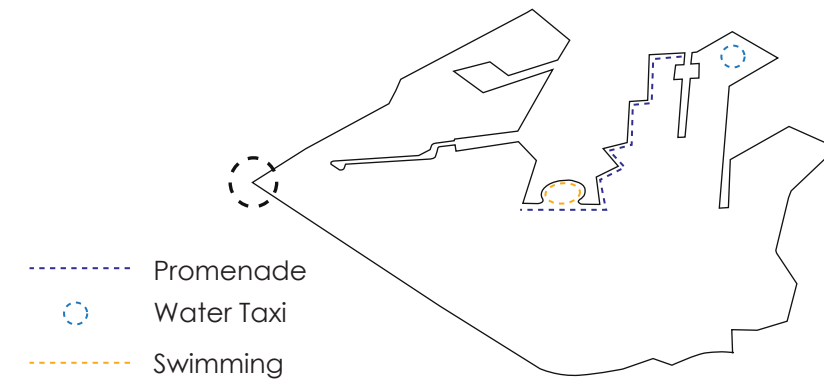
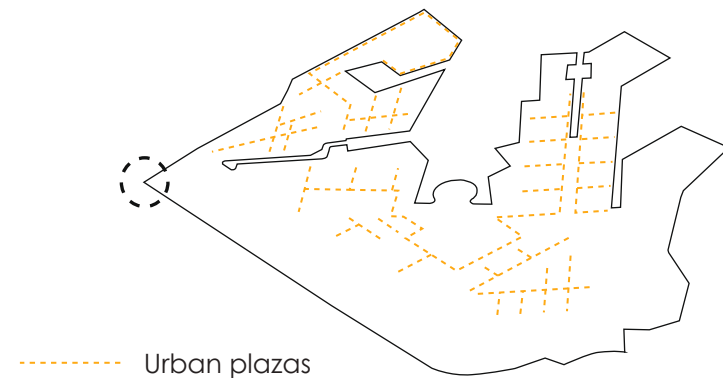
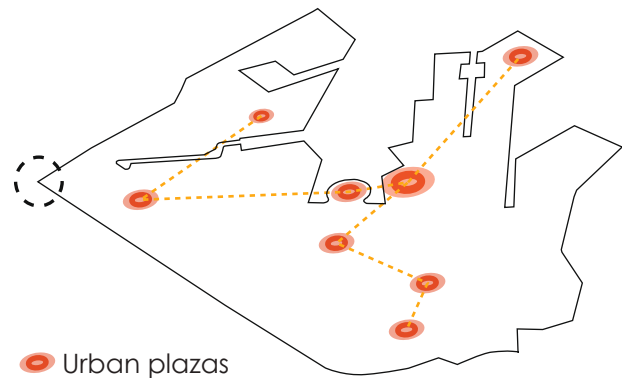

To begin with,

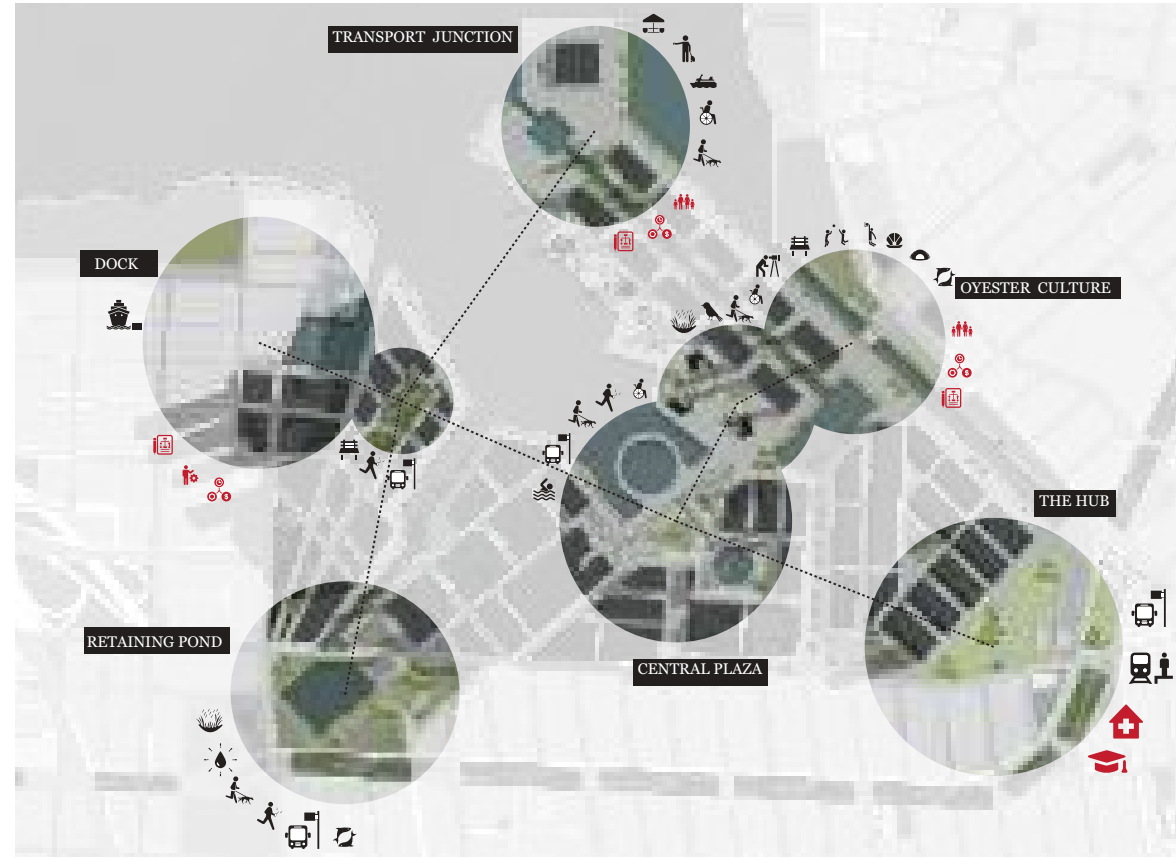

- Residential  
1,000,000 m.sq.
- Offices  
230,100 m.sq.
- Commercial  
200,000 m.sq.
- Education Utility  
150,000 m.sq.

-  Equity
-  Social resilience
-  Ecological

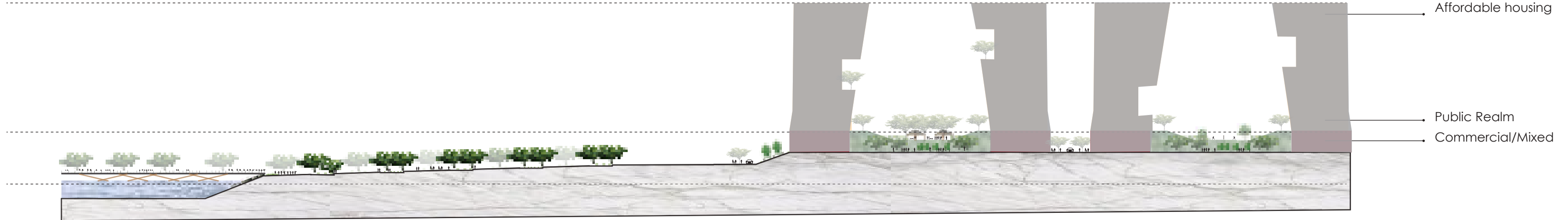

The Armature



With a concept of dramatic natural landscape within the urban identity of Chennai, a scheme was developed where scattered building blocks will not stand out as a separate geometry but integrated within the fluid landscape lines

The overall theme was to bind the urban plazas on the upper side and forest areas on the lower side with interlocking water bodies, pathways and grass mounds to create a fluid landscape



Developing the form

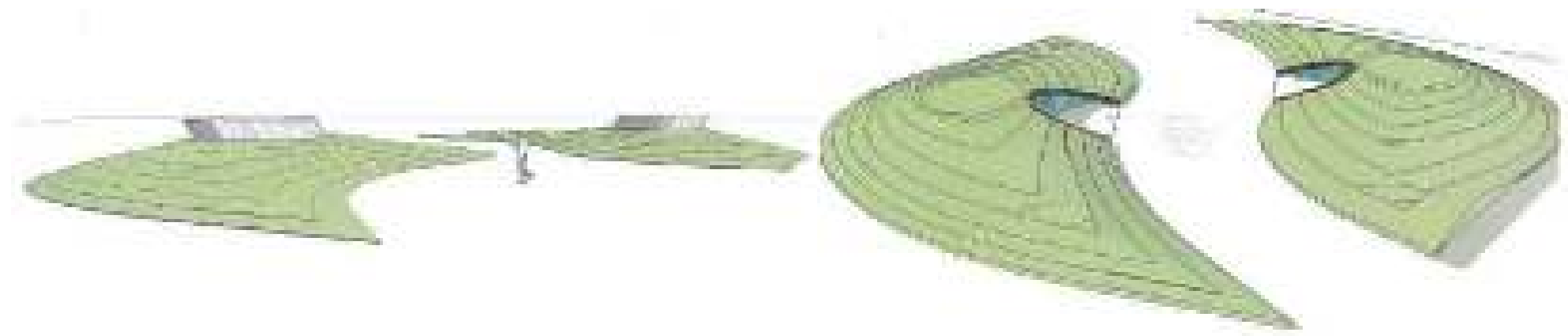
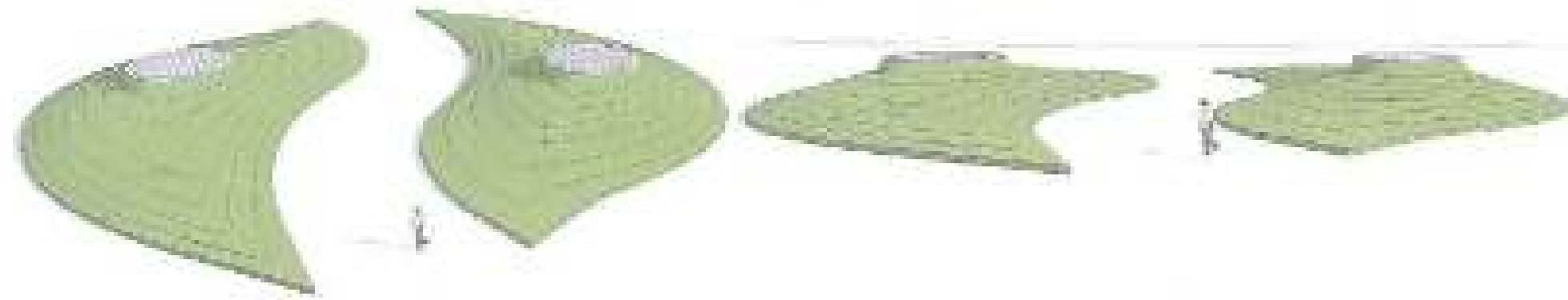

Master Plan

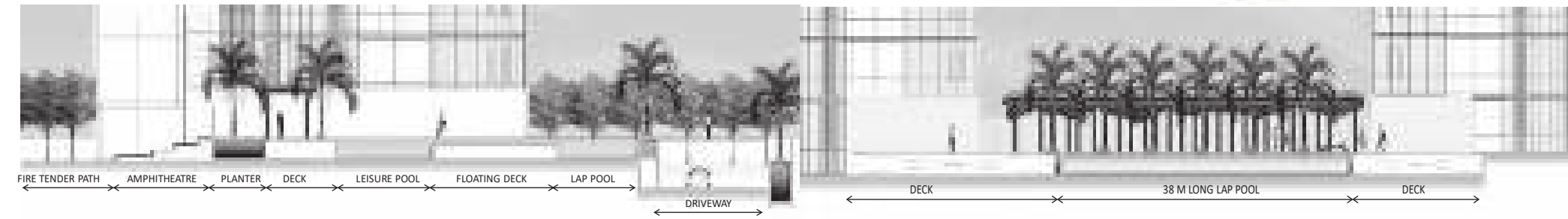

Schematic Section

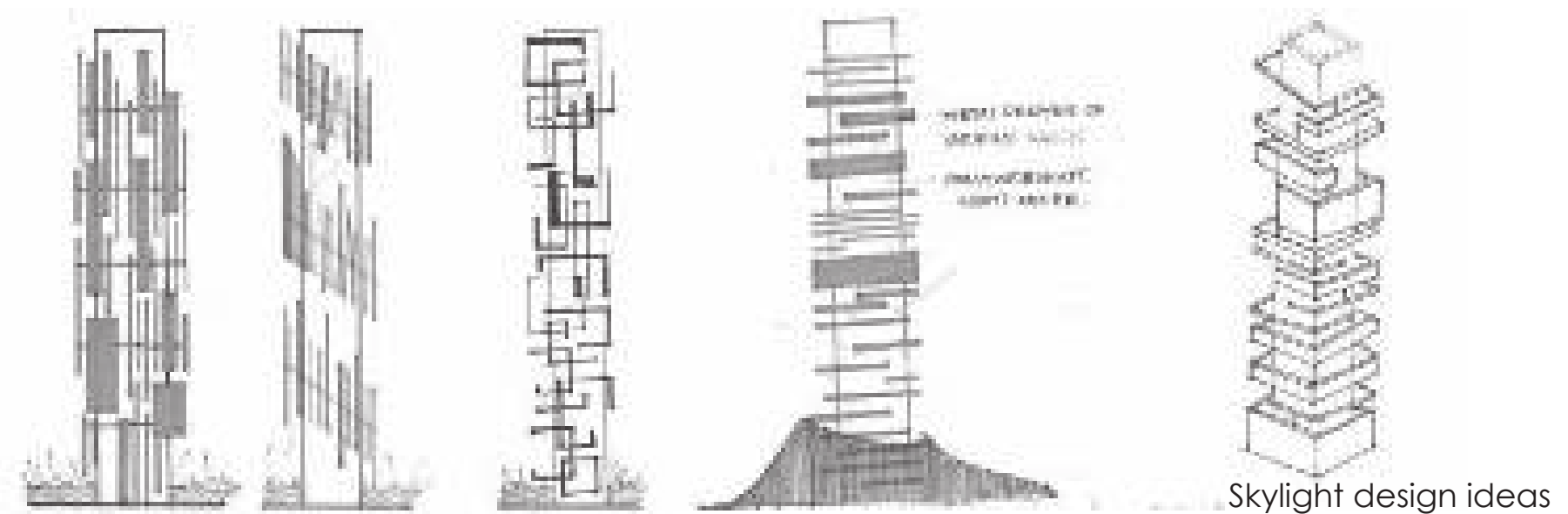

Skylight design ideas



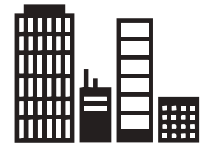

Urban fabric



Forest



Lake

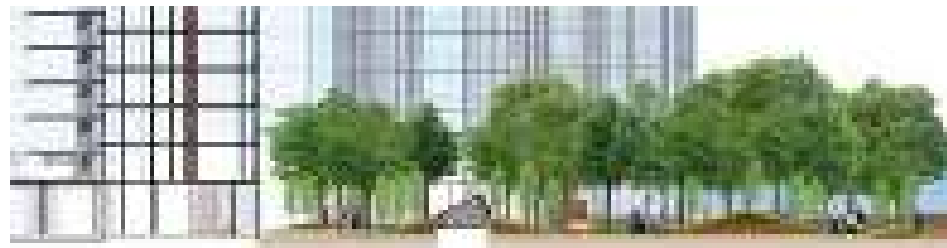

Section B



Areas along the driveway were planned with a strict geometry to carve out the urban plazas

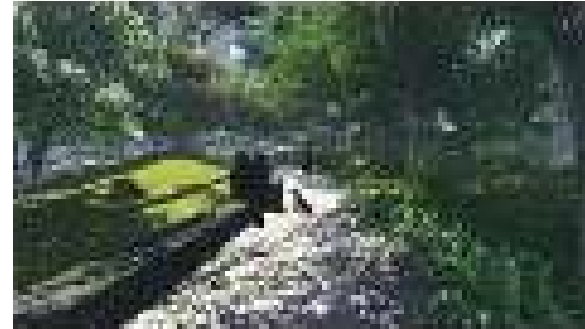

The area on the other side was planned as a forest with indigenous species and natural landscape

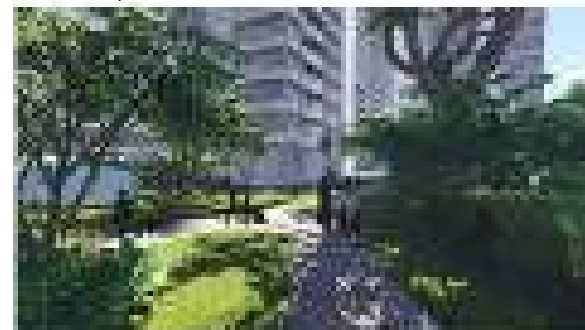

The concept of landscape mounds with skylight were used as a landscape elements

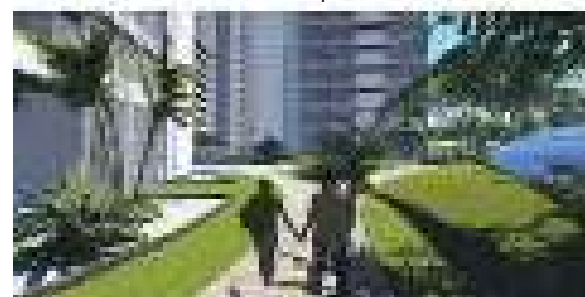

Plating Plan

Softscape

Pedestrian pathway

Built and Unbuilt

Design intervention

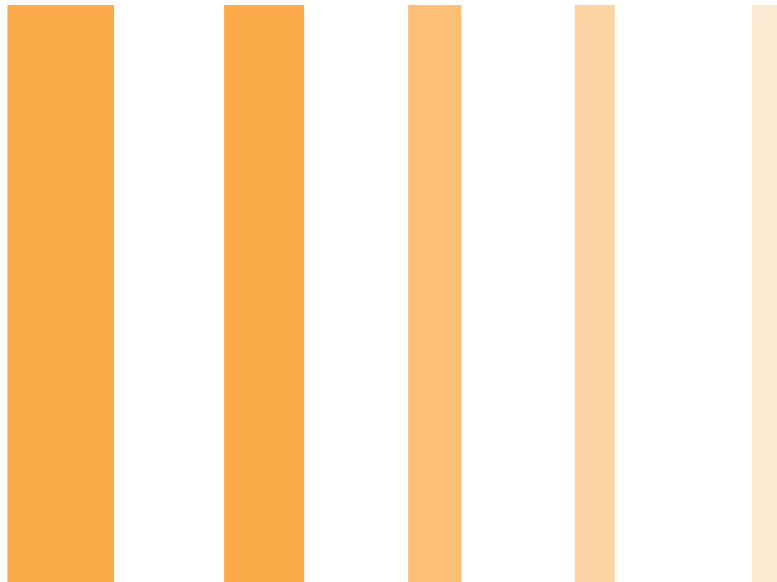

Thank You

