



## ANSHU DARBARI

- ◆ Master of Urban Design - University of Colorado Denver, Colorado USA
- ◆ Bachelor of Architecture - Aayojan School of Architecture, Jaipur, Rajasthan India



# Preface

*"The world is full of magic things, patiently waiting for our senses to grow sharper"*- WB Yeats.

I am an urban designer by profession and, a poet, and a budding storyteller by passion. My zeal to seamlessly combine my skills and knowledge with a touch of personalization gives me an edge over other professionals. In the rat race of portraying the best image renders, earning the most money, and building iconic structures in cities, we as young professionals have drifted away from recognizing the social and cultural responsibilities of designers of urban living.

Urban Design strives to be a bridge between catalytic changes to our communities and celebrations and enhancing qualitative aspects of experiences through lived stories. As a designer, I am passionate about healthy and equitable living. My purpose towards any project is to create a cohesive fusion between intangible experiences and design sociology while designing urban living systems and infrastructure.

My zeal to be a bridge through creative ways inspired me to do a Bachelor of Architecture from Jaipur, a city known for its stories and experiences of royal families, palaces and people. My dissertation titled "Context loses ground to architectural design" garnered to be the starting point of my journey to Urban Design. The research looked at the parameters of People, Place and Time in the architectural buckets of iconism, sculptural, tribute and monumentalism.

After graduation, I worked on campus planning, smart city proposals, and urban streetscaping for four years in various offices in India. Subsequently, I moved to the United States to pursue a Masters's in Urban Design from the University of Colorado Denver. During my time at the university, I was deeply involved in the diversity and inclusion efforts through the international student community and worked as Student Assistant I for the Office of International Affairs, where my job was to represent the Office at front desk and guide and direct students to their respective school officials. With this hands-on experience I handled tricky situations and made many new friends and got immersed into a cross-cultural realm. I led the team of the Indian Student Organization as the Social Media Officer, garnered great response from the student community with three successful university-wide festivals. The ISA was nominated for the Best Student Organization 2019 in the Lynx Awards 2019. My efforts, associations in leadership positions and high academic standing earned me College of Architecture and Planning (CAP) - ZGF Scholarship and partial Summer Study Abroad Tuition Scholarship. I was also nominated by the Office of International Affairs as the Featured Graduate from the Class of 2020 in the CU Denver News which featured on various social media platforms.

Post graduation, I worked with Alan Ford Architects on K-12 school renovations and adaptive reuse strategies. My tenures at John Kaliski Architects in Los Angeles and Shift Planning and Design in Denver exposed me to explore affordable and mixed-use housing options for the Latino communities in Colorado and Southern California regions. I enjoy problem-solving roles that effectively integrate building design, transportation, the public realm, and user-centered experience strategies. Being a data science enthusiast, I am learning to curate my own stories through data and visual representation and communication.

When I am not working, I am either penning my thoughts down in poems or exploring cities walking and virtually.



# Table of Contents

## Academic Projects

Storytelling Landscapes: Inclusivity and Education  
MUD Spring '20 | Urban Design Studio II (URBN 6611)

Making a case for Bus Rapid Transit at Colorado Boulevard, Denver  
MUD Fall '18 | Urban Design Studio I (URBN 6610)

Revitalizing public spaces in Barcelona, Spain  
MUD Summer '19 | Advanced Urban Design Studio (URBN 6612)

## Professional Work

Indian Institute of Technology Dharwad  
SGA Design Lab, New Delhi | Sep '17 - Jul '18

Multi Modal Integration  
Vinyas Architects & Landscape Architects, New Delhi | Dec '14 - Aug '15

Other Works  
As separate documents: Available upon request

# Anshu Darbari (Assoc. AIA) Urban Designer | Architect

anshu.darbari@gmail.com | +91-8860.474366 | +1-513-5186928  
New Delhi, India

## EDUCATION

Aug '18 - May '20

University of Colorado, Denver | Colorado, US  
MUD | Master of Urban Design | Concentration in Transit Planning and Placemaking | GPA: 3.69/4.00

Spring '20 - "Storytelling landscapes - Inclusivity and education"

Campus masterplan, urban design framework, adaptive reuse

Summer '19 - "Revitalizing public spaces in Barcelona"

Public space design, cultural and behavioural explorations.

Spring '19 - "Changing street landscapes in the advent of Autonomous vehicles"

Research, urban street design, hypothetical policy matrices

Spring '19 - "Evolving Urban Fabric: A Morphological Evolution"

Public exhibition + presentation, research in historical emnations and economic progressions

Relevant academic courses:

Urban Design Studio I and II; Advanced Urban Design Travel Studio; Urban Design Policy; Urban Policy Analytics; Transportation and Environmental Planning; Transit Pedestrian and Bike Planning; Urban Desing Professional Practice.

Extra Curricular & Volunteer Experience:

2019 - 2020 - Indian Student Association at the University of Colorado | Social Media Officer

2019 - 2020 - International Students & Scholars Services Office | Student Assistant (Administrative)

2019 - 2020 - Womens' Transportation Seminar (Colorado Chapter) | Volunteer for parklet designs

2020 - 2021 - American Society of Landscape Architects | Urban Design Network - Volunteer

Aug '09 - May '14

Rajasthan Technical University, Kota, India  
Aayojan School of Architecture, Jaipur  
B.Arch | Bachelor of Architecture | GPA: 60.1% (First Division)

Spring '14 - B.Arch Thesis - "Advocating social interactions among medical community and the masses"

Campus planning, urban design framework, BSL-II facilities

Fall '13 - B.Arch Dissertation - "Context sometimes loses ground to architectural design"

Research, context based studies, placelessness analysis

Extra Curricular & Design competitions:

2012 - Aayojan School of Architecture (ASA) yearly newsletter - 2012 | Contributor

2011 - Young Architects' Festival - Chandigarh Chapter | Student delegate

## PROFESSIONAL AFFILIATIONS

Nov '14

Registered Architect: Council of Architecture India  
CA/2014/65648

Jul '20

American Institute of Architects  
Associate AIA Member

## RELEVANT VIRTUAL LEARNING

Sep '21 - Present

Modern and Contemporary Art and Design Specialization | MOMA

Learnt diverse methods, motivations and processes of arts ranging from glass works, sculptures and performing arts

Oct '20 - Dec '20

Studying Cities: Social Science Methods for Urban Research | Erasmus University, Rotterdam

Learnt diverse methods, motivations and processes of arts ranging from glass works, sculptures and performing arts

Jul '17 - Sep '17

Entrepreneurial Land Redevelopment Approach | MIT, USA

Learnt diverse methods, motivations and processes of arts ranging from glass works, sculptures and performing arts

May '17 - Jul '17

Re:Think the City - Approach to local and global urban challenges | TU Delft

Learnt diverse methods, motivations and processes of arts ranging from glass works, sculptures and performing arts

## SOFTWARE PROFICIENCY



3D Modeling and Rendering

SketchUp

VRay



Design Tools

Revit Architecture

AutoCAD



Documentation & Presentation

Adobe Creative Suite

BlueBeam



Data Analysis

ArcGIS

Q-GIS

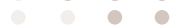

R-programming

## PROFESSIONAL EXPERIENCE

### United States (Urban Design 2018 - 2021)

- Jan '21 - Jul '21* **John Kaliski Architects | Los Angeles, California | US**  
Urban Designer
- City of Fullerton, CA : Rail District Specific Area Plan
    - Prepared graphics and 3D visualization.
    - Spearheaded the client meeting with the consultants.
  - City of Palmdale, CA : Multi-Family Design Standards and Guidelines Development
    - Spearheaded the urban design characteristics survey, parcel utilization analysis and designed various multi-family housing typologies.
    - Designed and compiled the City-wide Existing Conditions report on existing housing patterns for public review.
- Dec '20 - Feb '21* **Shift Planning and Design LLC | Denver, Colorado US**  
Urban Designer Contractual
- Confidential Mixed-Use Project in Denver, Colorado
    - Designed the urban design framework for 27-acre site in an industrial neighborhood and modeled urban design scenarios to incorporate diverse typologies of micro-housing, affordable housing and retail uses along with revitalizing and improving pedestrian experiences.
- Sep '19 - May '20* **Alan Ford Architects P.C | Denver, Colorado US**  
Internship: Fall 2019 + Spring 2020
- Brady High School, Colorado | Toyota Automotive Showroom, Colorado
    - Modeled campus planning frameworks for various projects at ideation stage.
    - Designed multi-level car parking for Toyota Showroom.

### India (Urban Design + Architecture 2014 - 2018)

- Sep '17 - Jul '18* **SGA Design Lab | New Delhi, India**  
Project Architect
- Indian Institute of Technology, Dharwad - Karnataka
    - Led the comprehensive master planning and site design
    - Engaged in effective and professional conversation with the dean, head of departments, senior faculty towards collaborative team work
  - Indian Institute of Technology, Tirupati Andhra Pradesh
    - Supervised the design team and provided technical guidance to junior staff and interns.
- Sep '15 - Sep '16* **Neev Architects and Urban Designers | Ghaziabad, India**  
Architect
- Jamia Hamdard University, Delhi
    - Assisted in designing 30-year comprehensive master plan development and guidelines (<http://www.nauda.co/PDF/JHU-Executive-Summary.pdf>)
    - Designed girls hostel, community spaces and faculty housing.
- Dec '14 - Aug '15* **Vinyas - Architects and Landscape Architects | Delhi, India**  
Assistant Architect + Intern
- Multi-Modal Integration - Delhi Metro Rail Corporation
    - Designed streetscapes and station areas in Old Delhi, basing the research and design on street design guidelines by Delhi Metro Rail Corporation and National Association of City Transport Officials.

## RESEARCH + ENGAGEMENTS

- Sep'21 - Present* **School of Architecture and Planning | University of Colorado Denver | US**  
Mentor at CAP Mentorship Program
- Currently mentoring one undergraduate and one graduate student at College of Architecture and Planning (CAP)
- Sep'20 - Sep '21* **Ms. Noushin Ehsan 2<sup>nd</sup> Opinion Design | New York City, US**  
Research + Writing
- Research and writing for Ms Noushin Ehsan's book 'Spirit of Space: An Insight into Psychology of Architecture' (Unpublished work)
  - Carried out detailed research on intangible impacts of elements (public and private spaces) on human emotions and behavior
  - Critically analyzed anecdotes and reviews of two workshops on spaces that had an impact on people's memory.
- Jun'21 - Jun '21* **School of Planning and Architecture | Bhopal, Madhya Pradesh, India**  
Guest Critic
- Critiqued final design work of 2<sup>nd</sup> year Bachelor of Architecture students.



*This project aims to envision the tri-institutional campus of Auraria Higher Education Center (AHEC). The campus includes three institutions namely University of Colorado, Metropolitan State University of Denver and Community College of Denver. The three institutions thus share resources and campus thresholds which include the 150 acre site cradled within the realms of commercial downtown, arts district and Elitch Gardens and Pepsi Center.*

*The project re-imagines the campus landscape to incorporate mixed-uses, housing, transit connections, experiential and spatial expansions and interactive learning processes.*



# AURARIA EDUCATION PARK

*Storytelling Landscapes through Inclusivity and Education*

*Term : Spring 2020 | Integrated Urban Design Studio - II*

*Instructors : Nancy Locke, Louise Bourdelon, Amir Alrubay*

*Type of project : Inter-disciplinary group of 4 students (1 M.Arch + 1 MUD + 2 MLA)*

*Softwares Used : QGIS | Sketchup | Adobe Creative Suite | Rhino | AutoCAD*

*Contribution : Concept 50%, Design Framework 70%, Modelling (Transit Hub) 100%, Diagramming 50%*

# CONTEXTUAL CATALOGUING

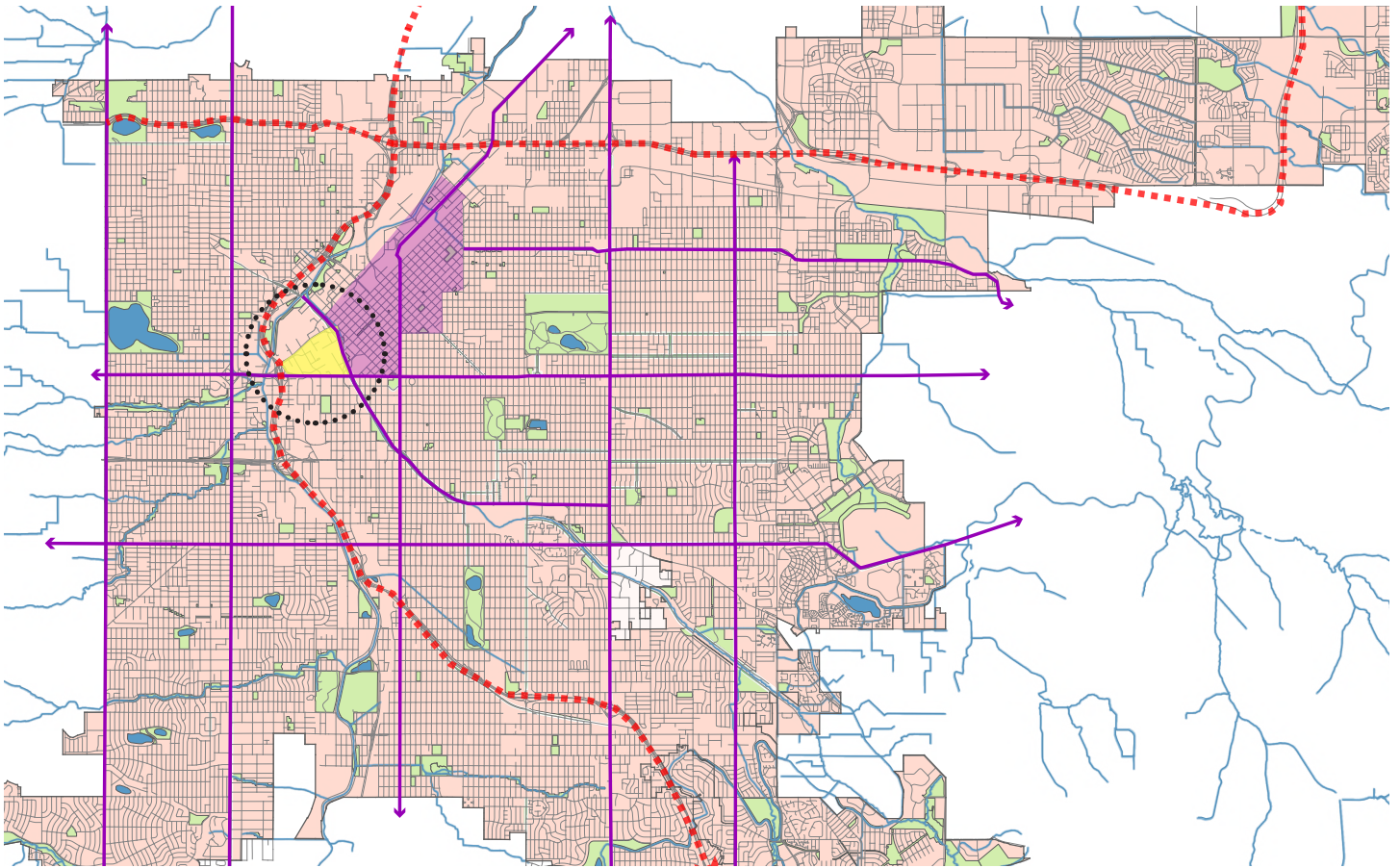

## Entry and Exits

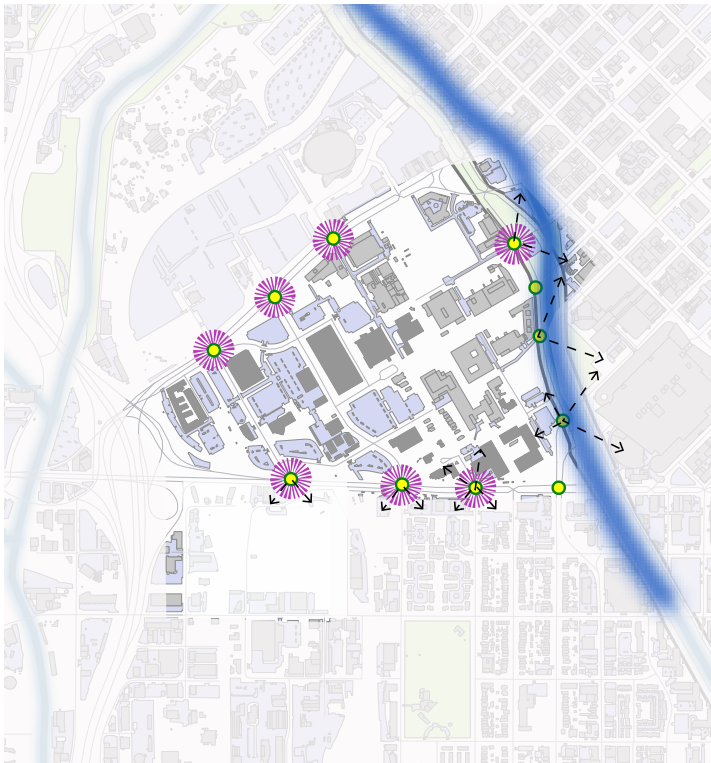

Engaging with the public realm

## Weaving the urban fabric

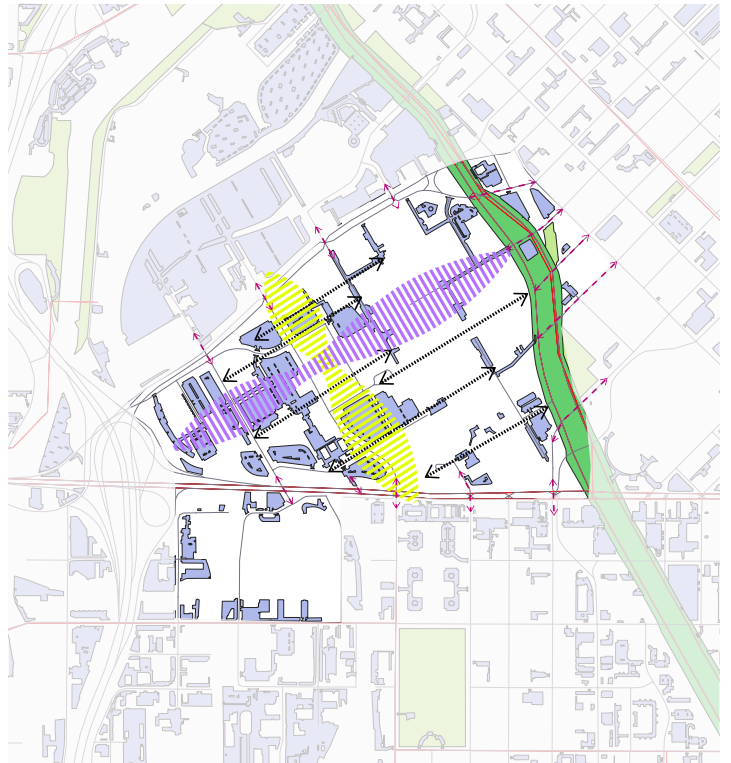

Weaving the cardinal spines

# FUNCTIONAL NARRATIVES

# SPATIAL ARTICULATIONS

**LOST IN THE WORDS**  
Educational zones create an interesting foreground against the spiritual realms.

**TIC TAC TOE**  
Accidental scatters of facilities and pockets of parking lots .

**WALK THE GREENS**  
Experiencing campus while walking through green and interactive open spaces.

**FOR THE STUDENTS - OF THE STUDENTS**  
A nuanced canvas of activities for the students.

**BANAL TONES**  
Health, wellness and recreational zones for the users of the campus.

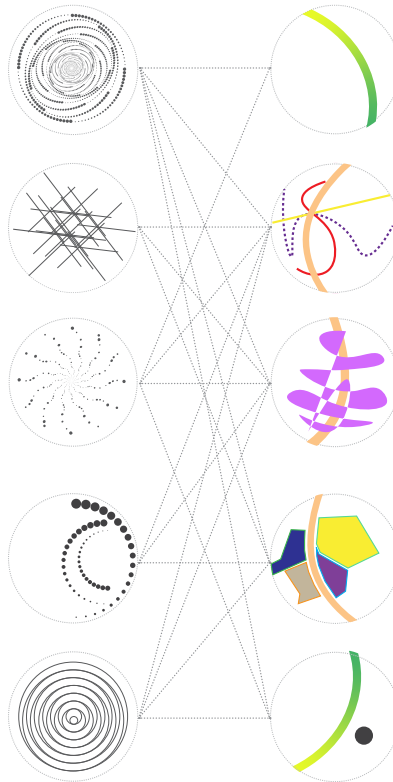

**CONTINUUM**  
A vibrant continuum through the heart of the city.

**CONFLUENCE**  
Confluence of identities, cultures and moments.

**TRANSITIONS**  
Experiential transitions through diversity of spaces.

**MOSAIC**  
A mosaic of diverse functions creates an interesting canvas as a background for educational activities.

**INTIMATE IMMENSITY**  
Finding 'The Pause' in the expansiveness of open spaces through experiences and views.

## Enhancing the green network

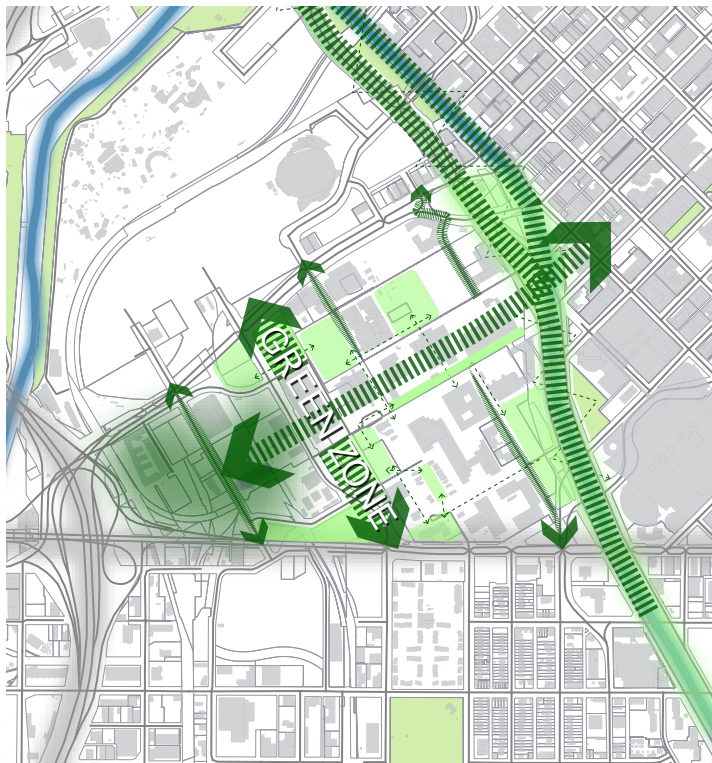

Creating pockets for moments of pause.

## Learning Zones

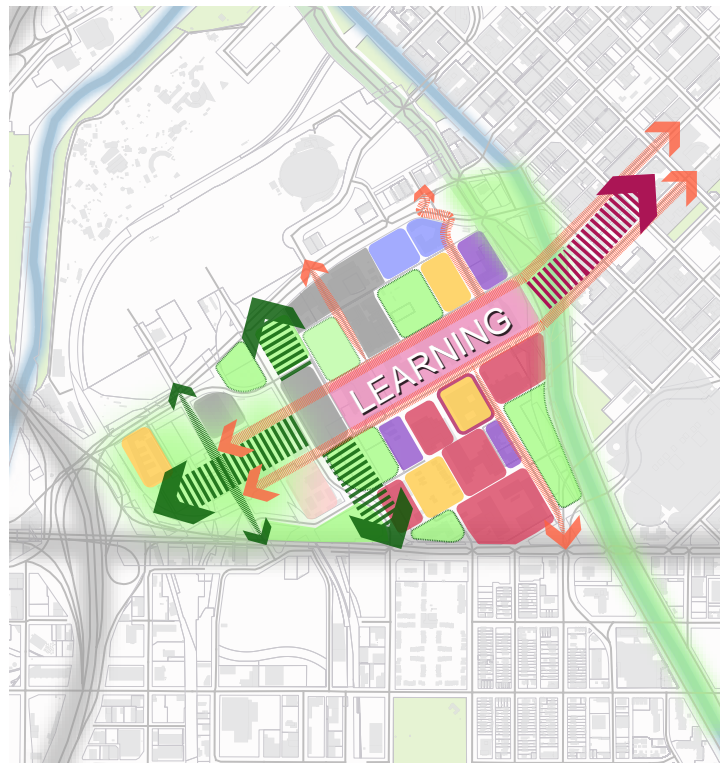

Traversing through mosaic of functions

## ADAPTIVE - REUSE

Strategic interventions allow for mitigation of social life during pandemic situations without disrupting it immensely. Mitigation strategies include resource building, preparedness and social distancing.

The provision of multi-use and multi-functional halls and student art work galleries garner strength to prepare resources. Provision of sanitation stations and hand-washes act as cushions for resource building.

In cases of isolation and quarantining, suppression of free movement becomes the narrative. Such a scenario allows for people to spill over to extended open and outdoor areas and still gather together.

Wider sidewalks, reclaiming street right of ways for bike lanes as well as cafes and lounges with outdoor seatings allow for multiple uses with various capacity numbers during tight pandemic conditions.

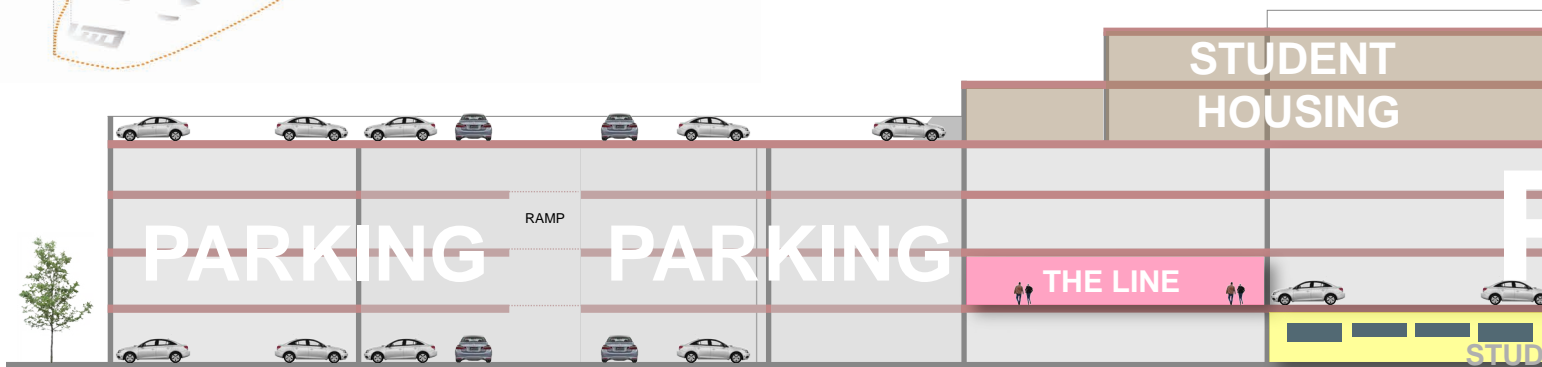

Section through 7th street garage

# STRATEGIC INTERVENTIONS

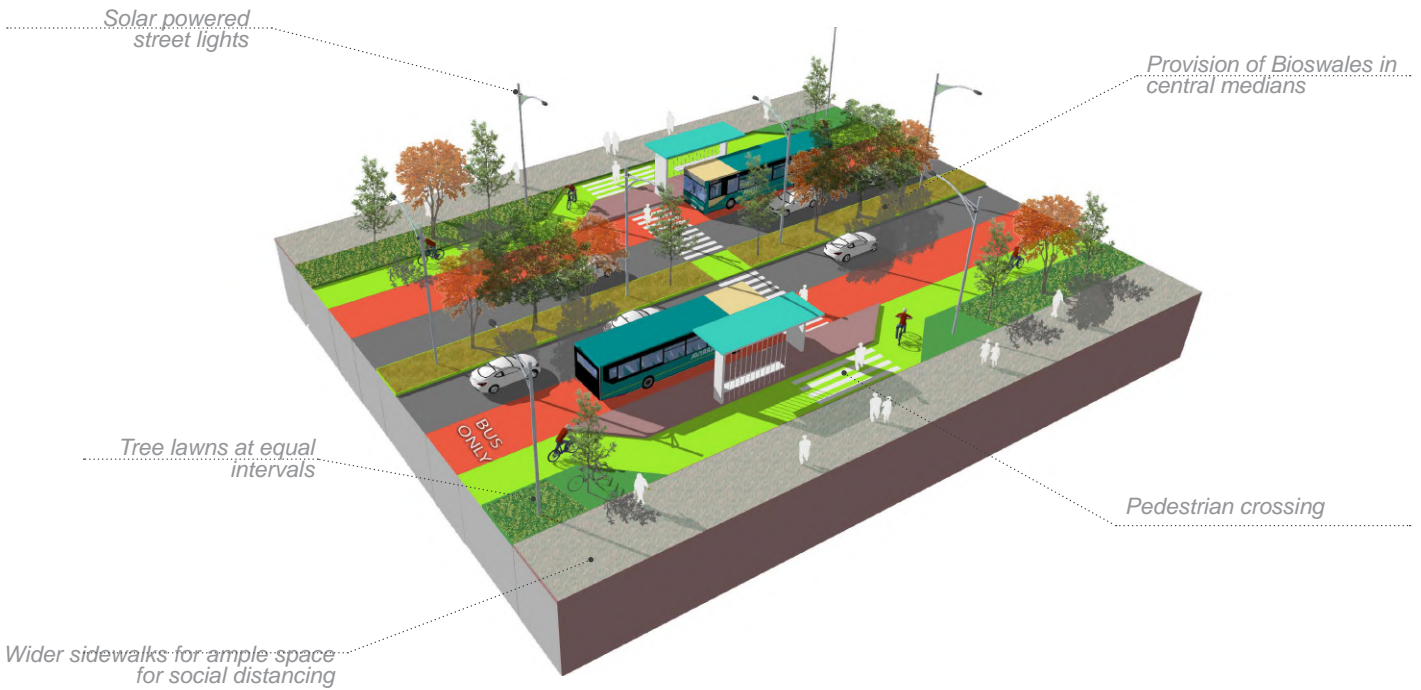
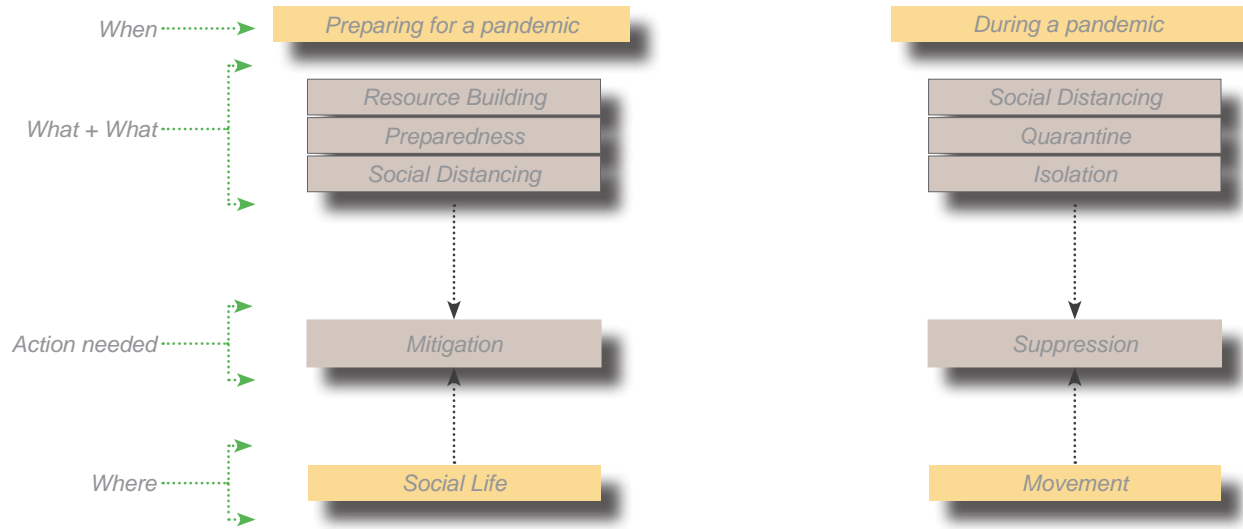

Cross section illustrating the functionalities, edges and spatial experience of the designed street

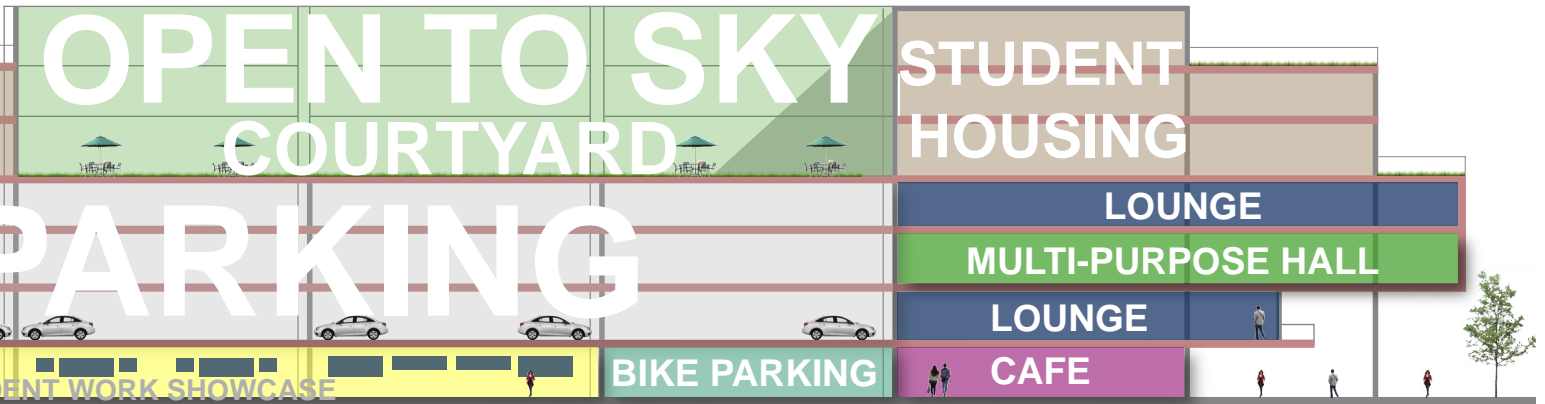

## CHARACTERISTIC SPACES



*Reclaiming the street space for buses and bike lanes*



*Solar powered street lights and multi-modality*



*Adaptive Re-use of 7<sup>th</sup> Street Garage*

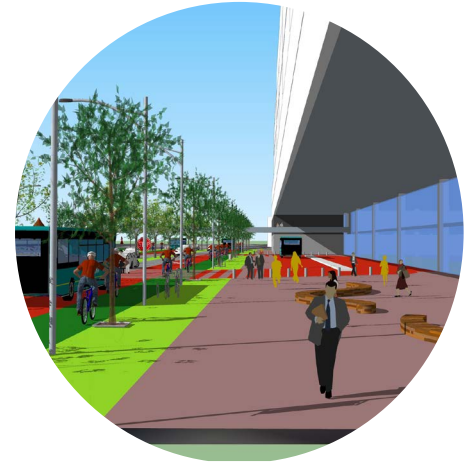

*Spill-over zones for social distancing*

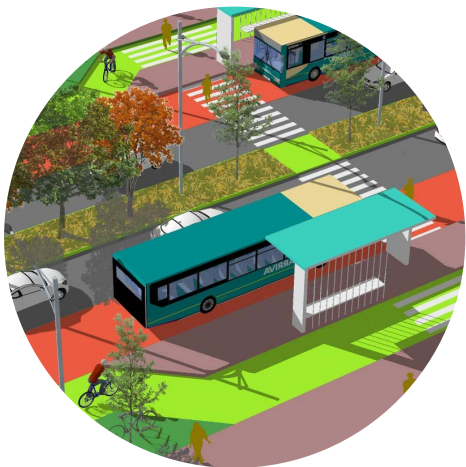

*Accessible Bus Stops*

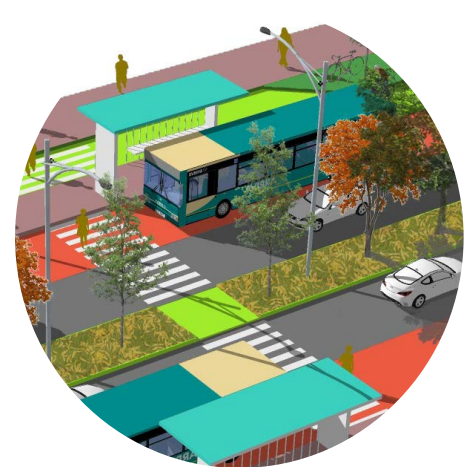

*Pedestrian crossings*

# HYPER-INTEGRATIONS

LOST IN THE WORDS

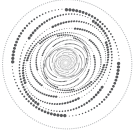

CONTINUUM



TIC-TAC-TOE



CONFLUENCE

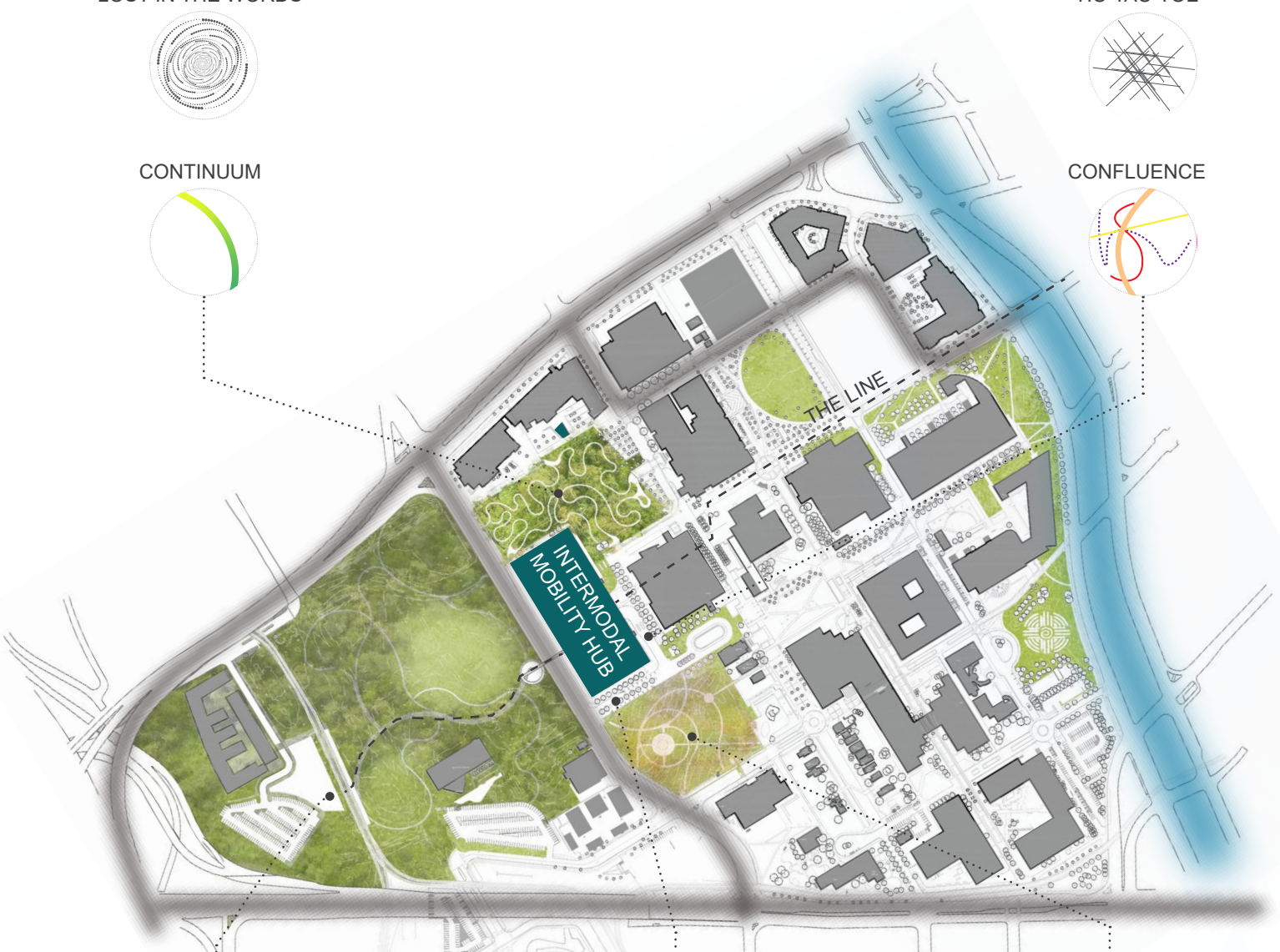
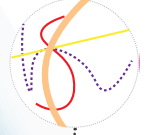

WALK THE GREENS

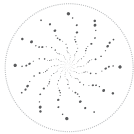

FOR THE STUDENTS  
BY THE STUDENTS

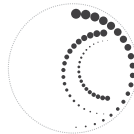

BANAL TONES



INTIMATE IMMENSITY



MOSAIC



TRANSITIONS





*The introduction of Colorado Boulevard Bus Rapid Transit corridor brings about a major redevelopment potential for the proposed high-capacity transit corridor by the City and County of Denver.*

*This redevelopment project changes the currently barren and under-utilized areas of Elyrea Swansea, Park Hill Golf Course, intersection of Colfax and Colorado Blvd, Glendale, Cherry Creek trail to more urbanized and walkable environments with mixed-use development creating main street experience.*



## BUS RAPID TRANSIT

*Complete Streets + Complete Networks*

---

*Term : Fall 2018 | Urban Design Studio - I*

*Instructors : Peter Park*

*Type of project : Inter-disciplinary group of 7 students*

*Softwares Used : QGIS | Sketchup | Adobe Creative Suite*

*Contribution : Concept 50%, Design Framework 50%, Modelling (Colfax Intersection) 100%, Diagraming 80%*

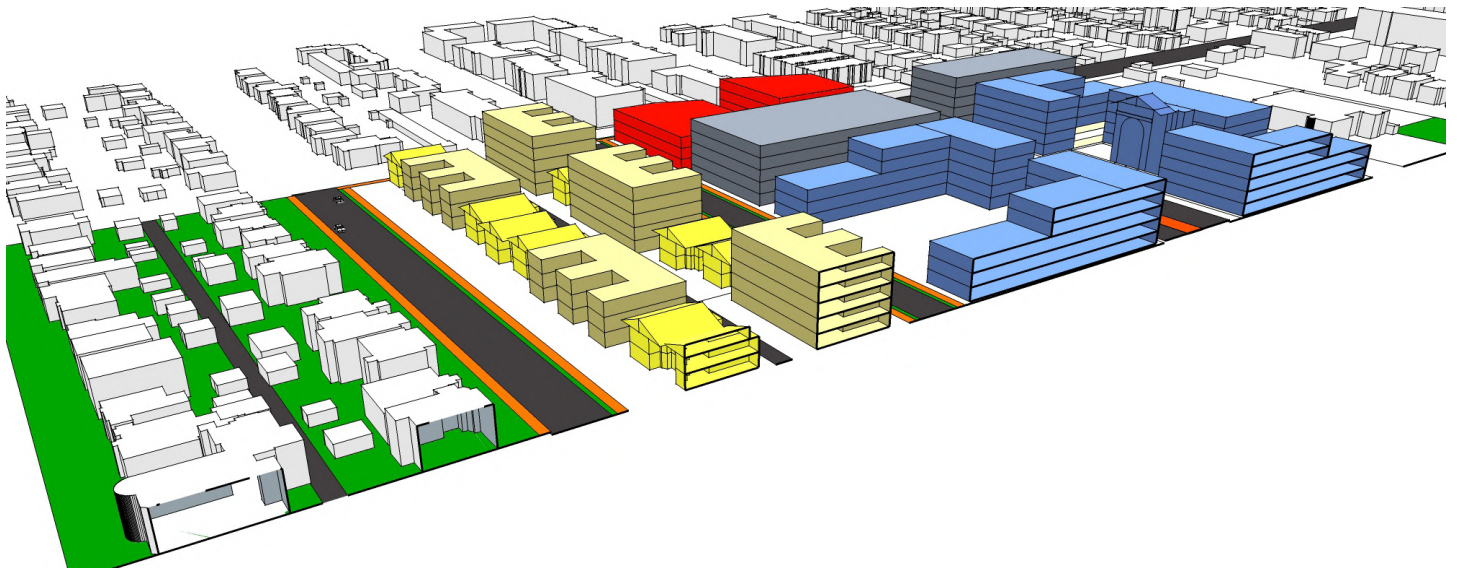

Corridor length = 8.75 mi  
 No. of stations = 15  
 Average spacing = 1/2 mi

Major stations = 7

BRT Configurations  
 Center running bi-directional = 0.4 mi  
 Boulevard = 0.75 mi  
 Multi-way boulevard = 4 mi  
 2 lane center running

**OPPORTUNITIES :**

- Potential to be a regional node,
- High bus ridership,
- Intersection of high capacity high traffic corridors of Colorado Blvd and Colfax Ave.
- Under-utilized land assets in parking lots.

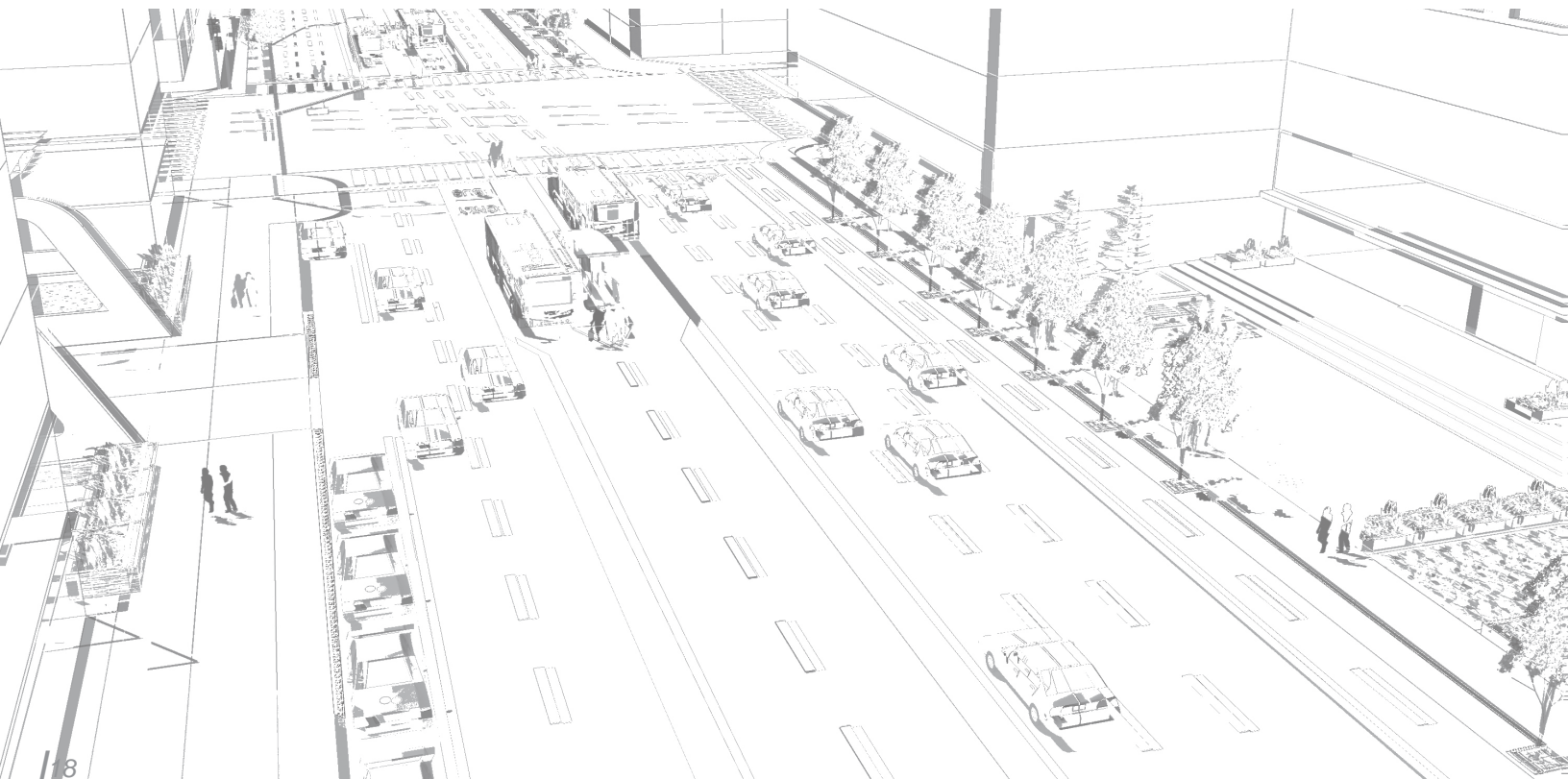

# CONTEXUAL CATALOGING

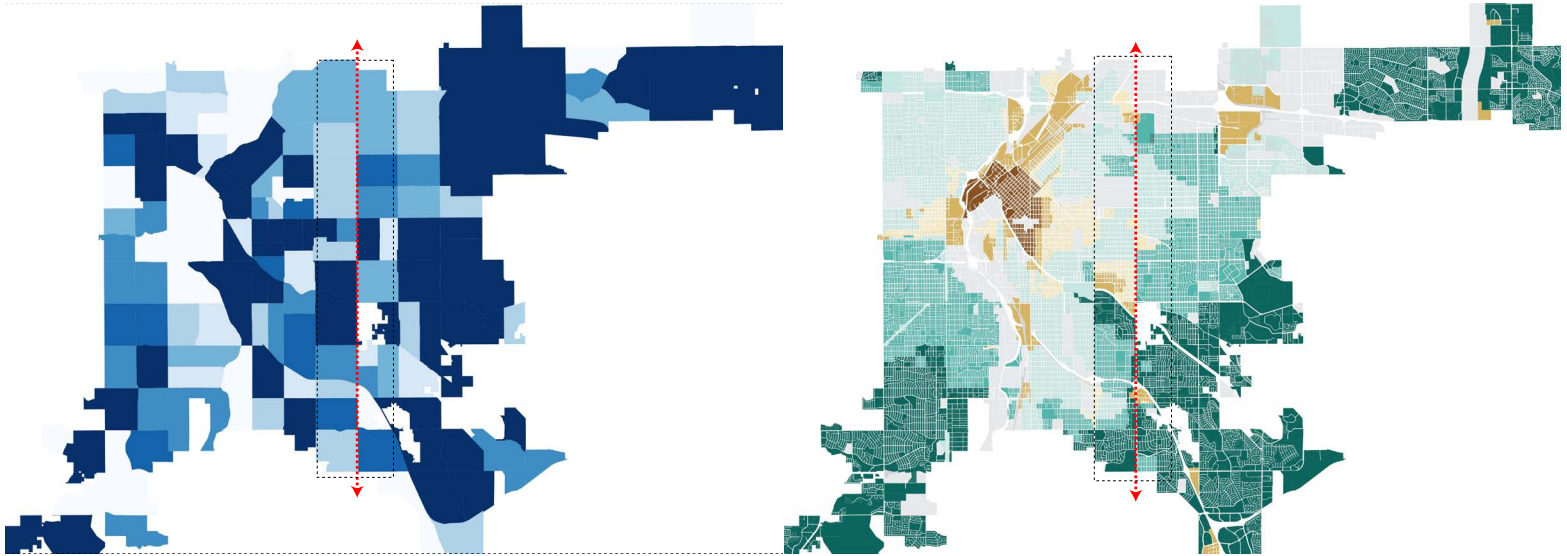

Affordable Housing Units

- Missing data
- 0 - 1300
- 1300 - 1600
- 1600 - 1900
- 1900 - 2100
- 2100 - 2400
- 2400 and more

Neighborhood Contexts

- Downtown
- General Urban
- Special District
- Suburban
- Urban
- Urban Center
- Urban Edge

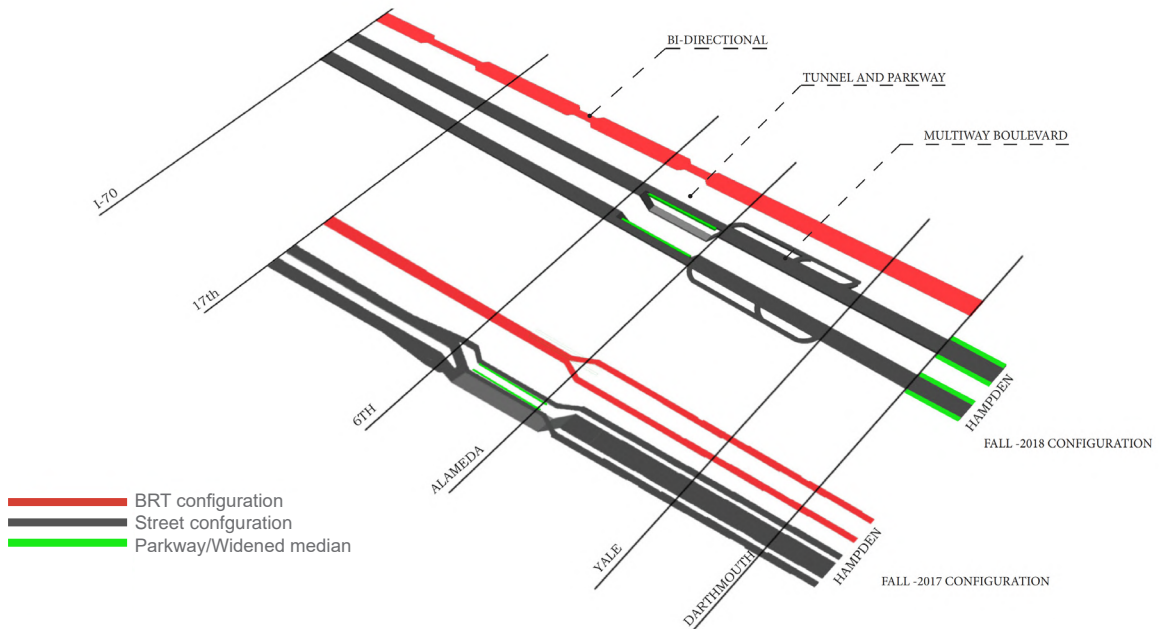

- BRT configuration
- Street configuration
- Parkway/Widened median

## Defining Fall 2017 Urban Design Studio

The studio focused on taking the works of Fall 2017 Urban Design studio cohort and building upon their works. The length of the BRT was extended from 17<sup>th</sup> street to beyond I-70 up to 52<sup>nd</sup> street. The Fall 2017 studio had proposed central run BRT between 17<sup>th</sup> and 6<sup>th</sup>, a tunnel with parkway configuration between 6<sup>th</sup> and Alameda along with multi-way boulevard configuration beyond Alameda. The proposed configurations were studied in depth and specific updates were provided. A small section of bi-directional BRT was proposed after MLK because of 55' ROW and so was proposed between 6<sup>th</sup> and Alameda.

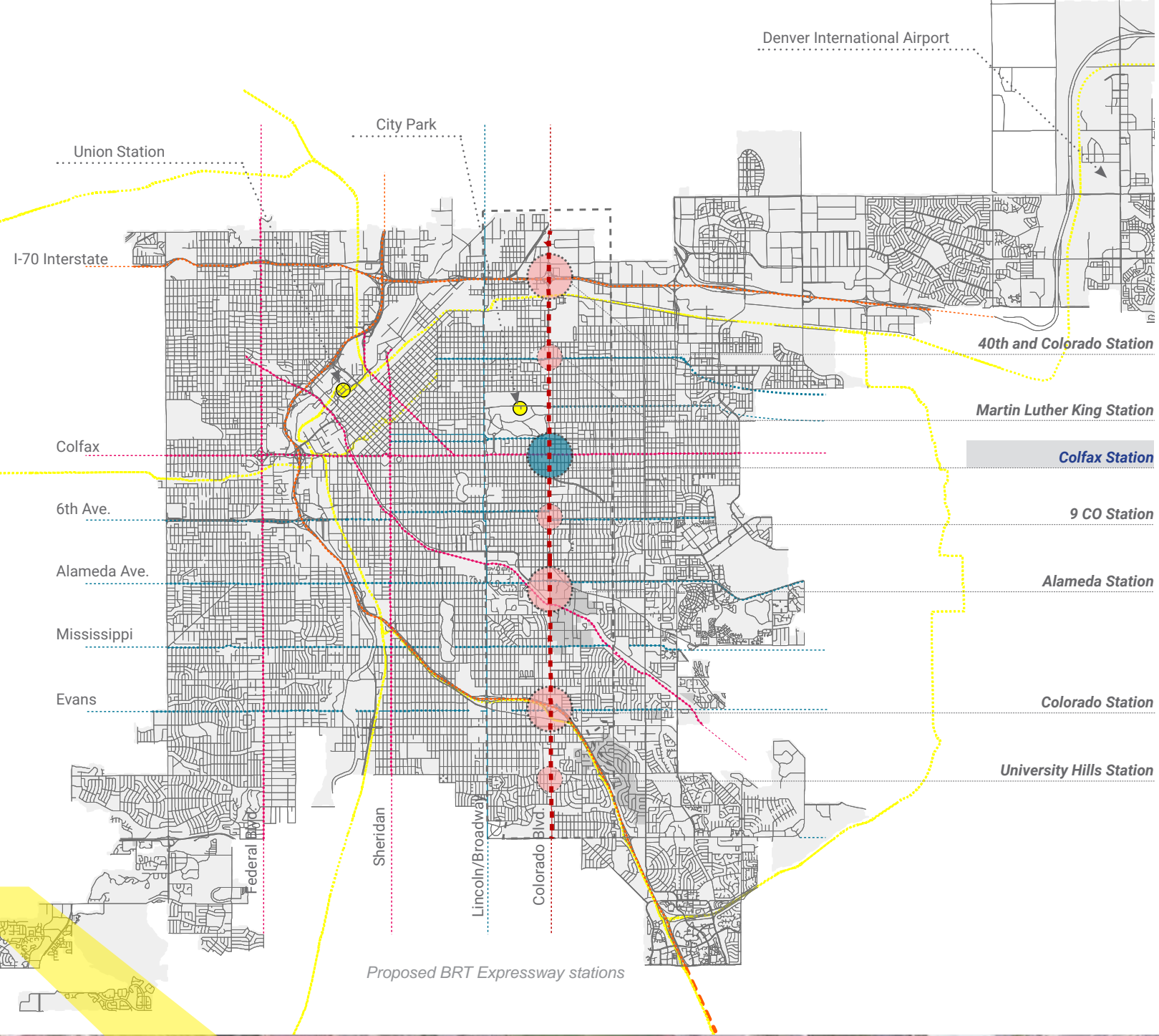

# CONTEXUAL CATALOGING

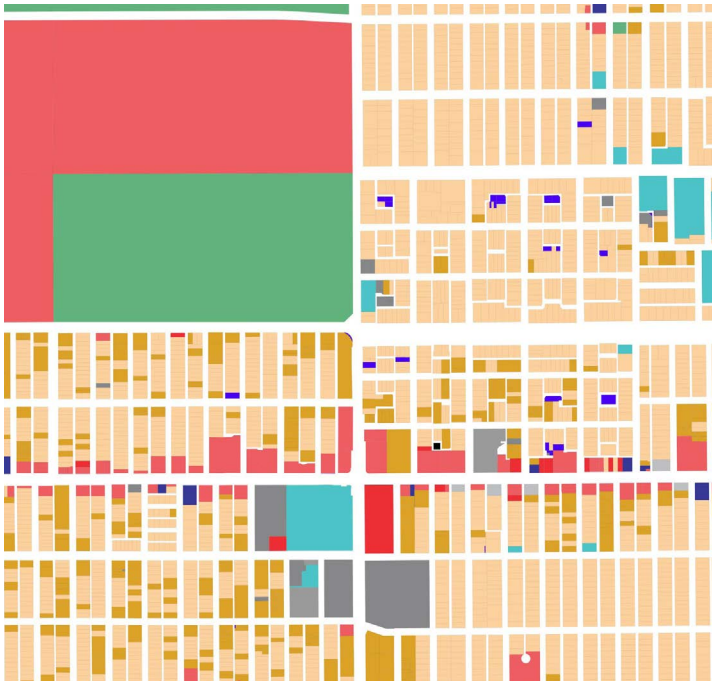

Land Uses

- Open spaces
- Commercial
- Residential
- Multi-Unit Residential
- Public/ Quasi-public spaces
- Industrial
- Mixed Use



Parcel to Streets volume distribution

- Parcels
- Streets
- Areas of Interest

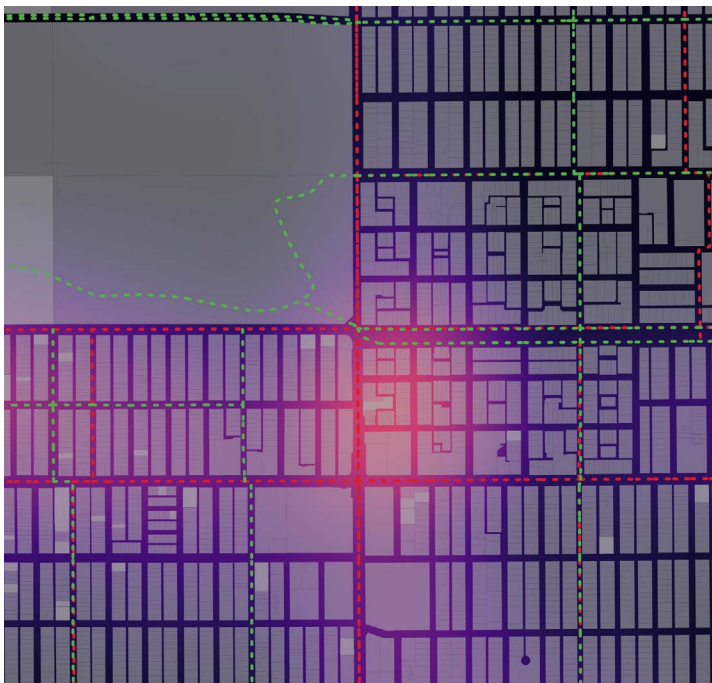

Traffic Accidents and Pedestrian Routes

- Snow Plowing Routes
- Pedestrian Routes
- Streets/Roads
- Major Accidents site

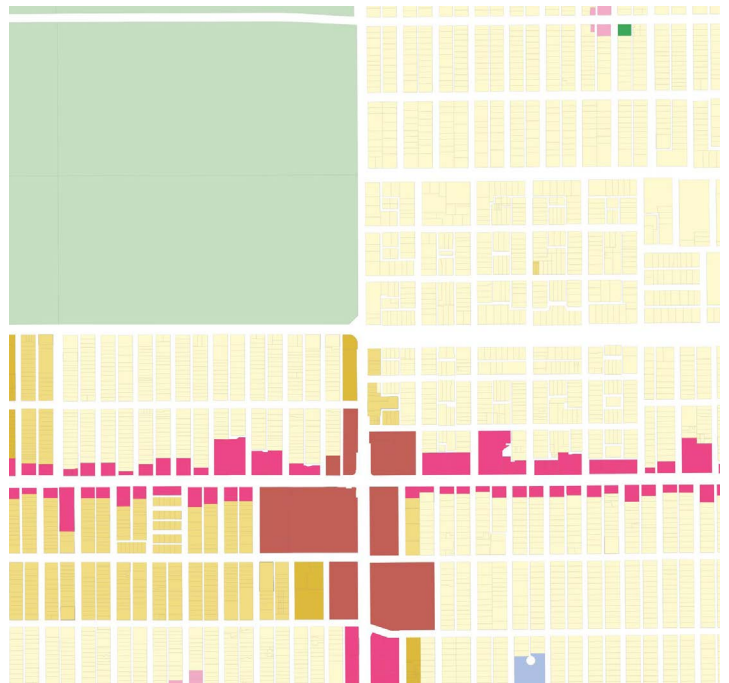

Future Places

- Open/Green spaces
- Commercial Corridor
- Employment Center
- Urban Center
- Industrial
- Other

# KEY INTERVENTIONS



*Mobility Hub*

The preservation of existing gas station enables the provision for ride-hail services, bike rentals and scooter rentals at the Colfax Station.



*Bus Stops*

Right side exit to accommodate the existing fleet of buses.

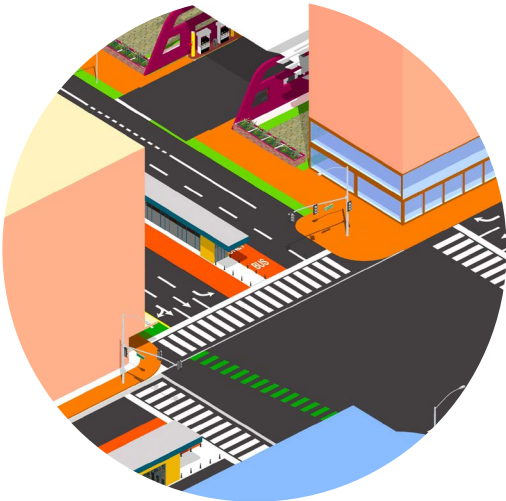

*Active commercial ground floor*

Bulb outs at the crossings and complete corners provide for safer pedestrian crossing experience.



*Central running bus lanes*

This intersection has the high bus-ridership, so creating main street infrastructure improves pedestrian experiences.

# CONCEPTUAL DEVELOPMENT

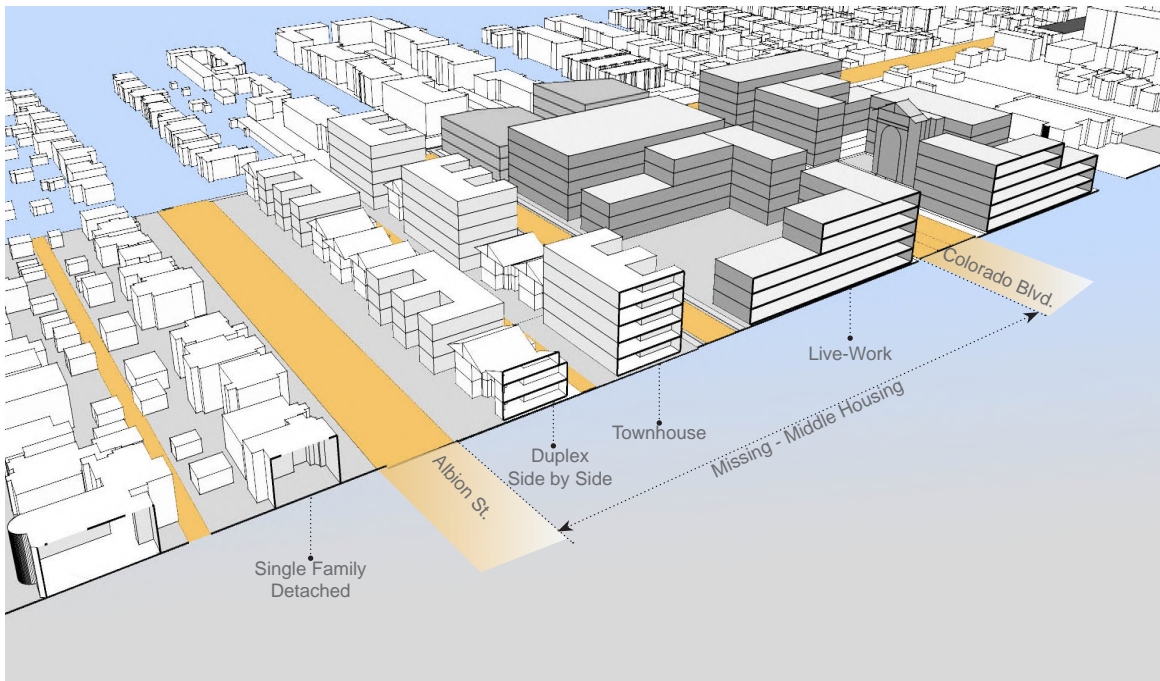
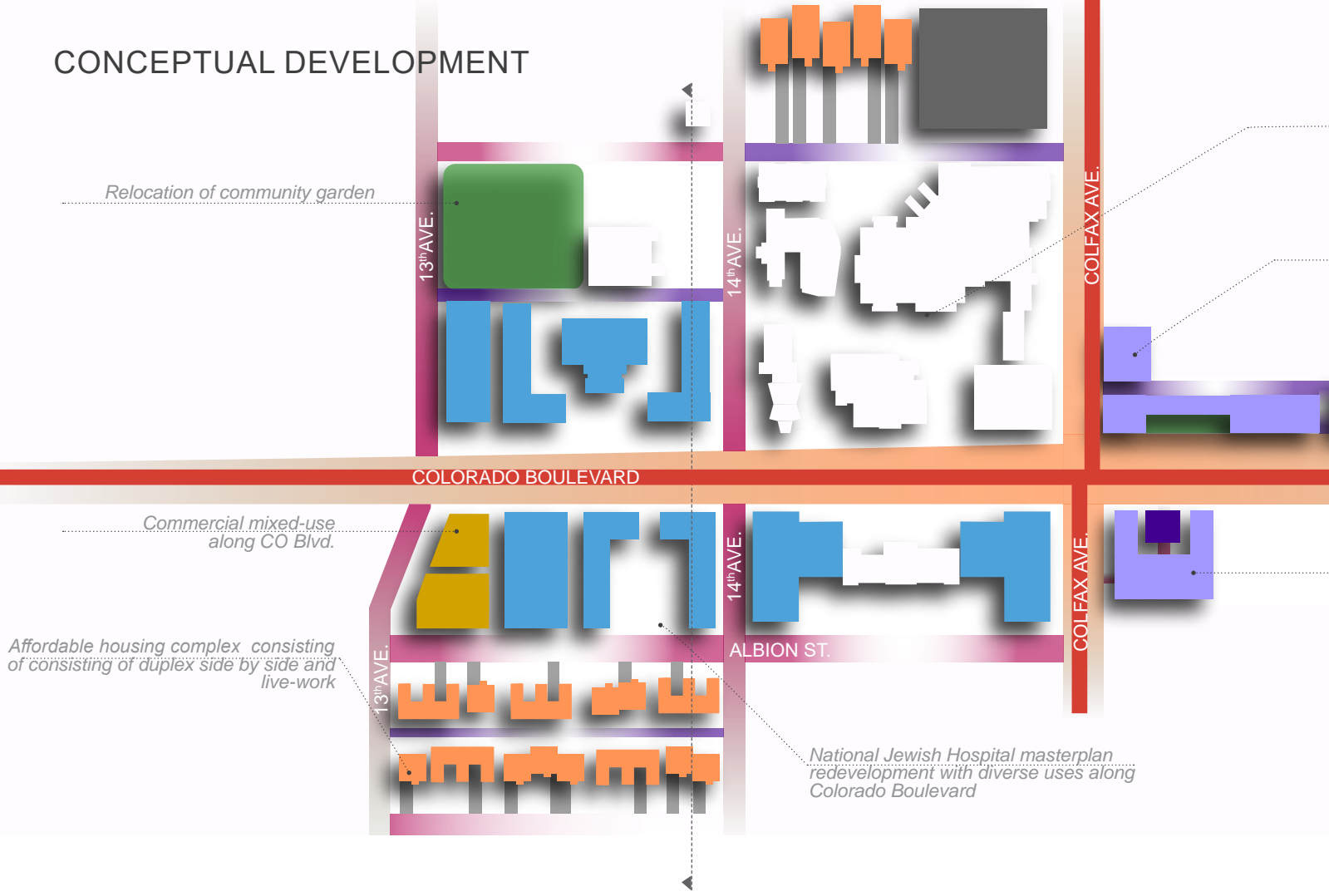

Provision of missing middle and affordable housing options

Existing National Jewish Hospital campus on Colfax Ave.

Proposed zoning change from Main Street 3 storey to Commercial Main Street 8 Storey and Commercial Mixed-Use Street with 8 Stories.

DENVER CITY PARK

COLORADO BOULEVARD

Inter-modal  
Transit mobility hub



Separate bike lanes with tree wells and bioswales create a barrier between slow and fast moving traffic



Cross over of buses at station stops to accommodate existing right-sided door bus fleet

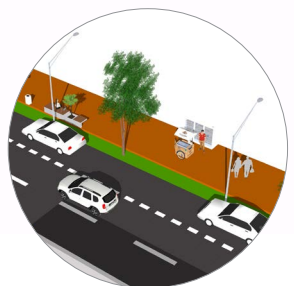

Wide sidewalks, places to sit and relax and spaces for food carts to create an inclusive urban experience

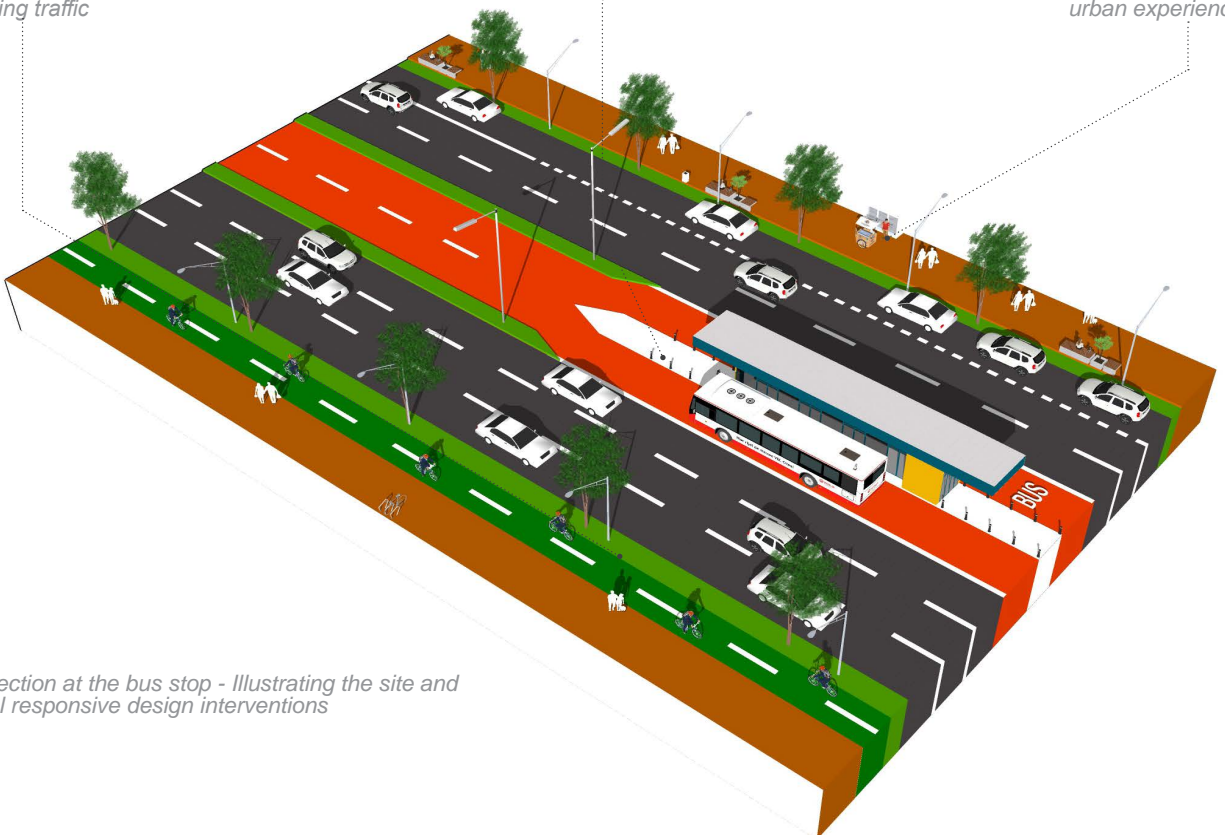

Street section at the bus stop - Illustrating the site and proposal responsive design interventions







*This project aims to improve the functional experience, ownership and identity of the park among the users. It aims to unite the old and new neighborhood contexts, and create spaces for a variety of activities, while reassessing and implementing sustainable strategies.*

*The main objective of the project is to design a cohesive context within a common identity that knits the many axes into a single converging point. This Nexus is a reflective of the past and projective of the future, fitting perfectly in the labyrinth of regional nexuses in Barcelona.*



## PUBLIC SPACE REVITALIZATION IN BARCELONA, SPAIN

*A human centric melting pot of cultures, networks and parks in the neighborhood of Poblenou.*

*Term : Summer 2019 Urban Design Advanced Travel Studio*

*Instructors : Ken Schroepel, Jeremy Nemeth*

*Type of project : Inter-disciplinary group of 16 students*

*Softwares Used : Sketchup | Adobe Creative Suite | ArcGIS*

*Contribution : Concept 100%, Design Framework 70%, Diagramming 50%*

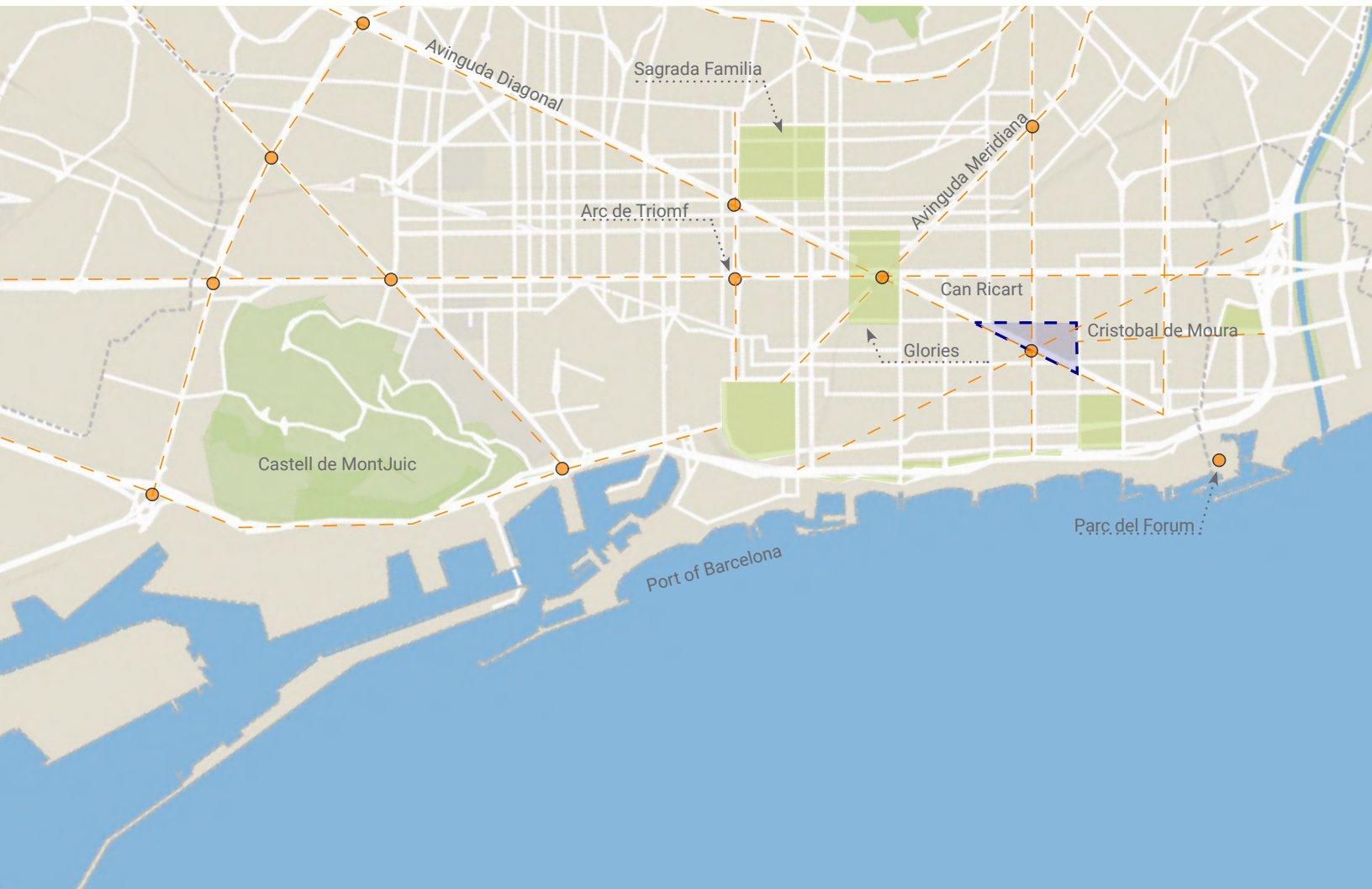
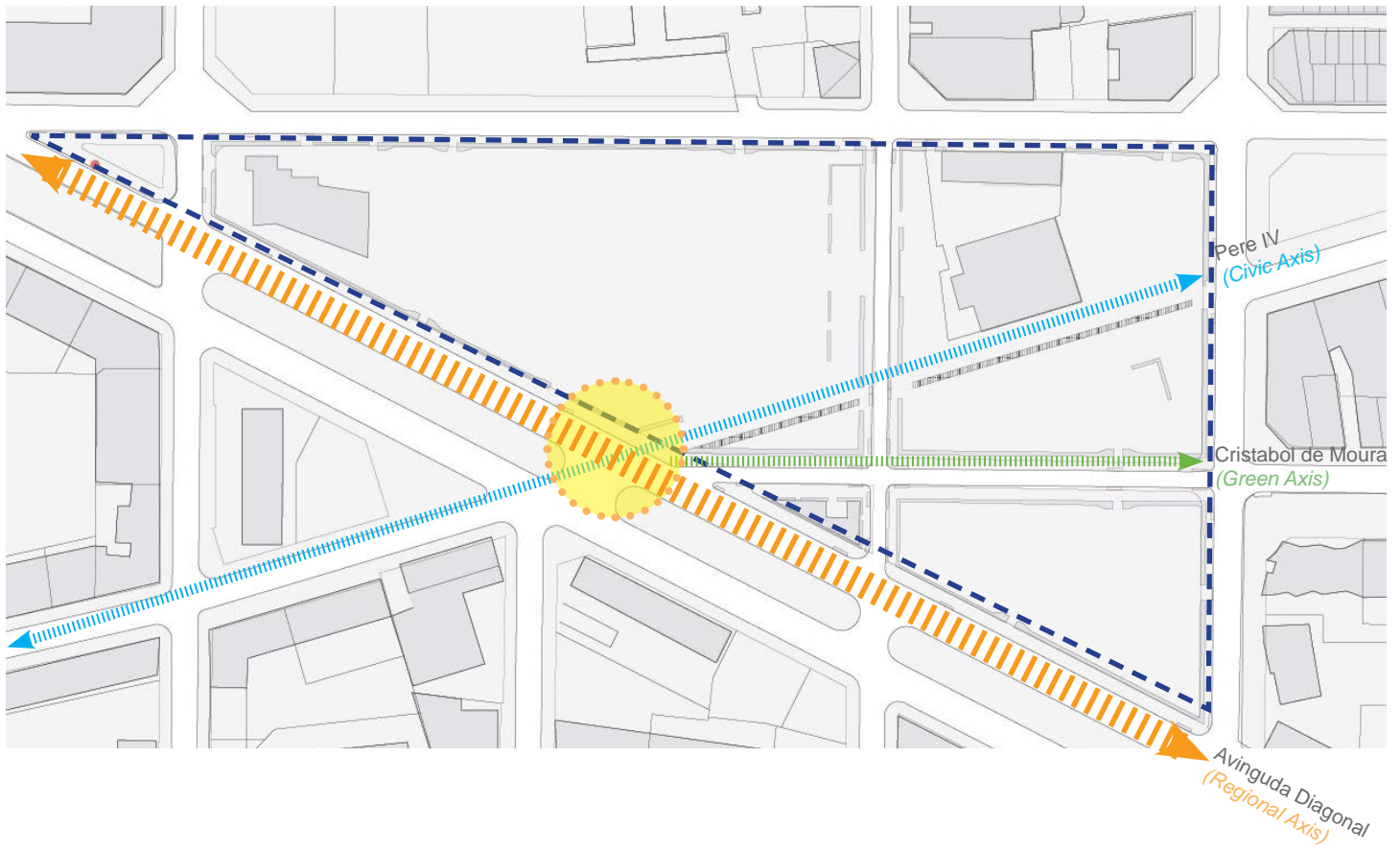

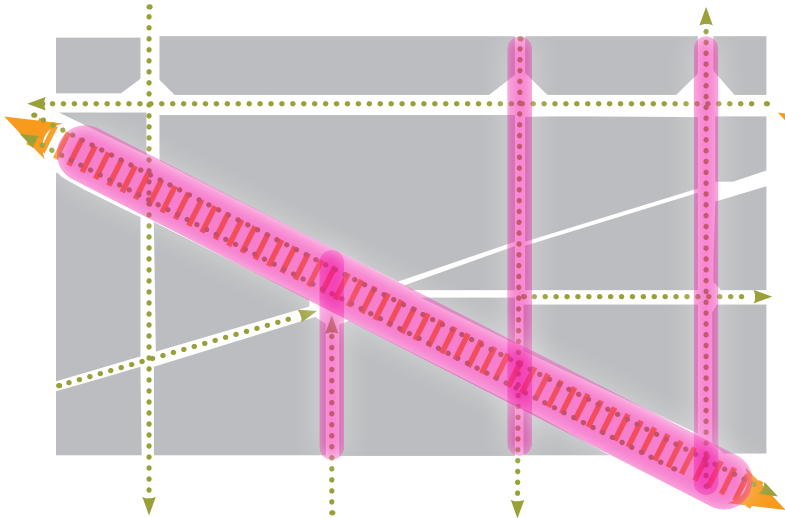

Vehicular movement - High congestion zones

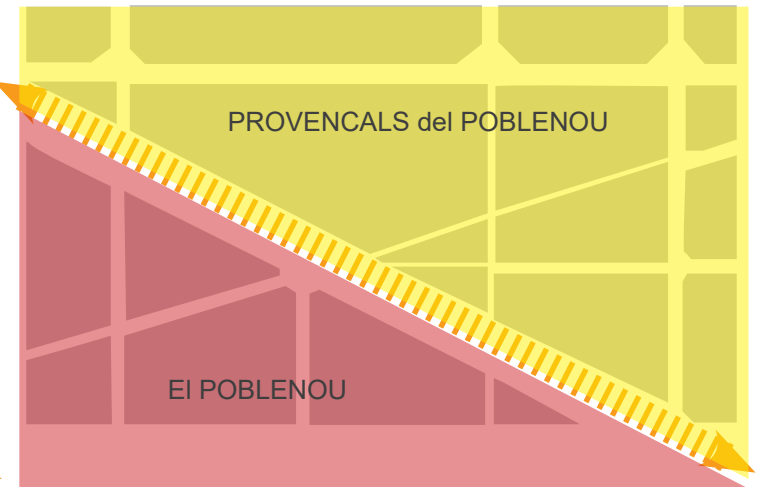

Neighborhood districts

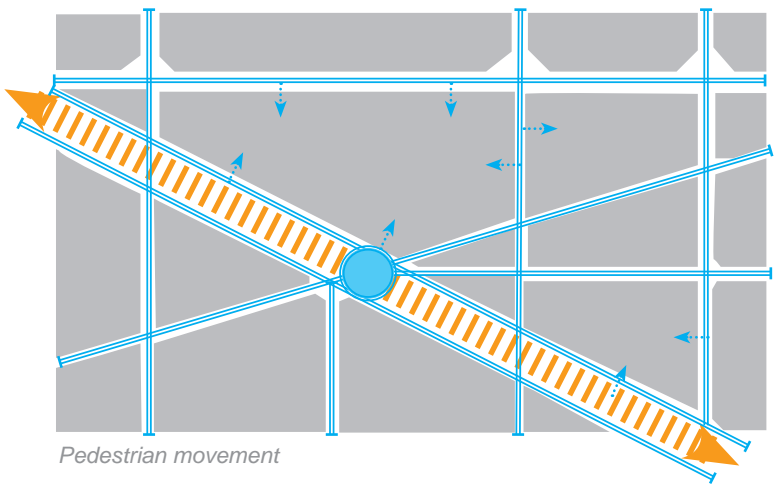

Pedestrian movement

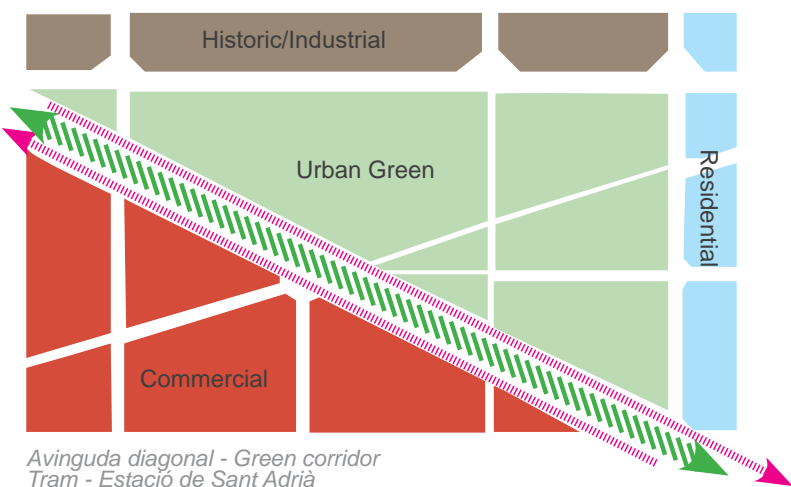

Avinguda diagonal - Green corridor  
Tram - Estació de Sant Adrià

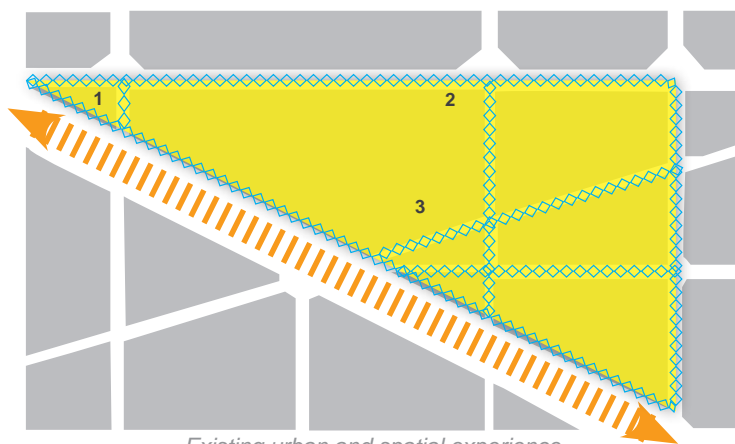

Existing urban and spatial experience

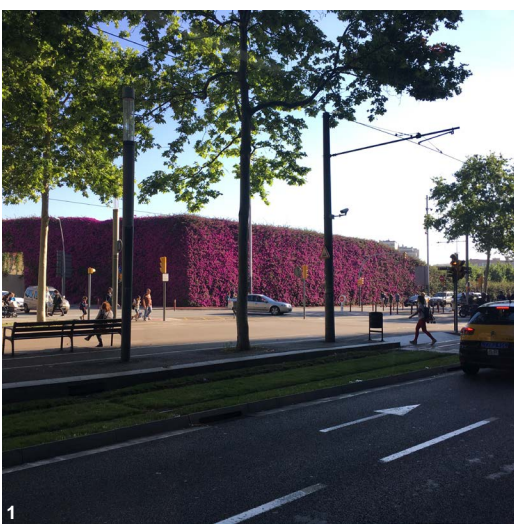

1



2



3

# BEHAVIORAL MAPPING

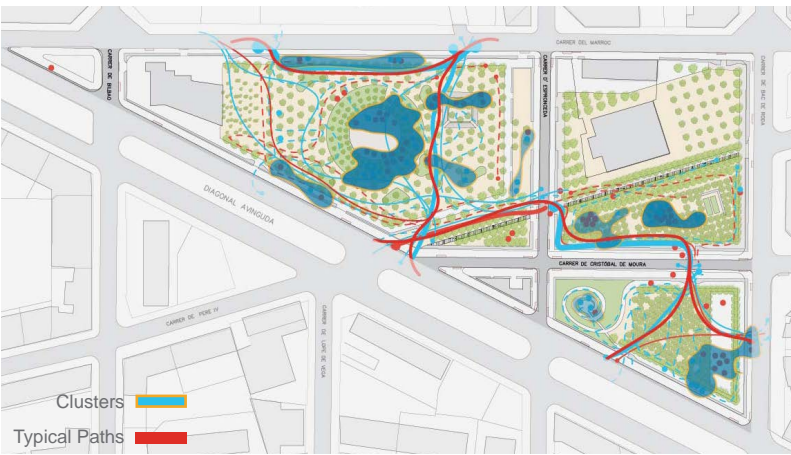

## Predominant clusters

Clustering in the most visited areas of the park, and also around the edges .

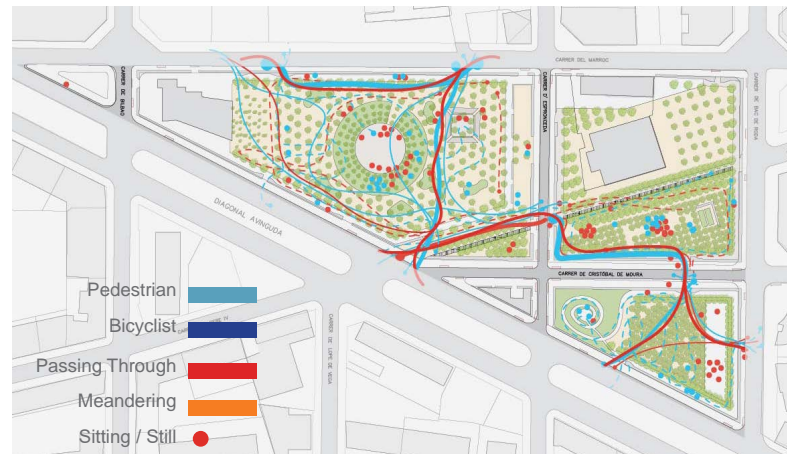

## Primary observations

As observed on site during different times of the days and week, most people use the park as a through-fare rather than pause and relax.

# STRATEGIC INTERVENTIONS

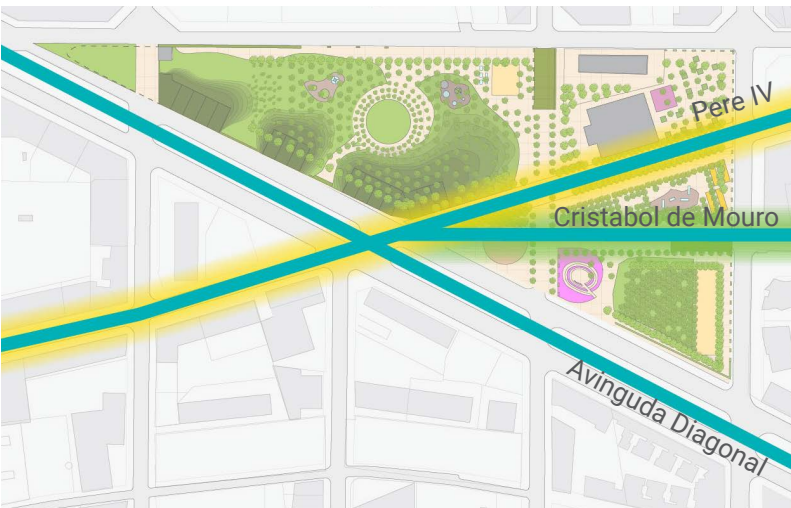

## Continuum

*Celebrating the Pierre IV*

Highlight and celebrate the civic axis (Pere IV)

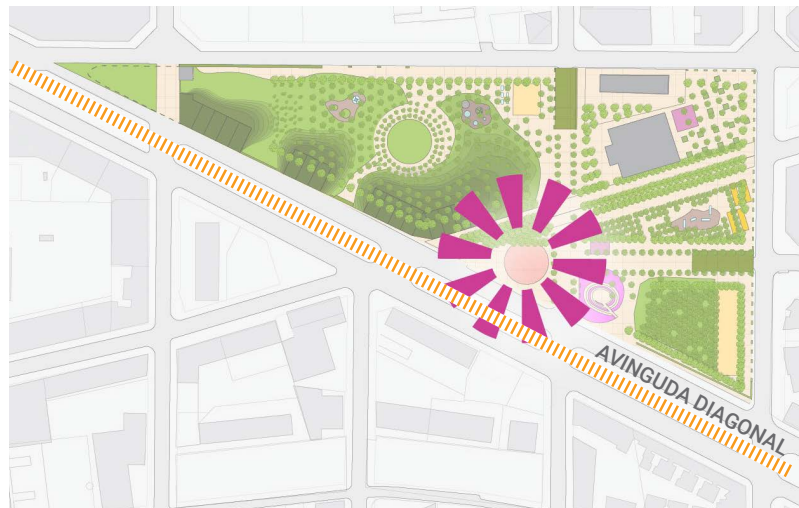

## Confluence

*Creating a strong draw point*

Consolidate the multiple activity hubs at the physical convergence of streets



## Breaking down the walls

*Increasing visual + aural permeability*

Extend and mirror the urban character of Diagonal

Dissolving the thresholds



## Union

*Transform into a contiguous space*

Functional and e-motional permeability

Activate the edges



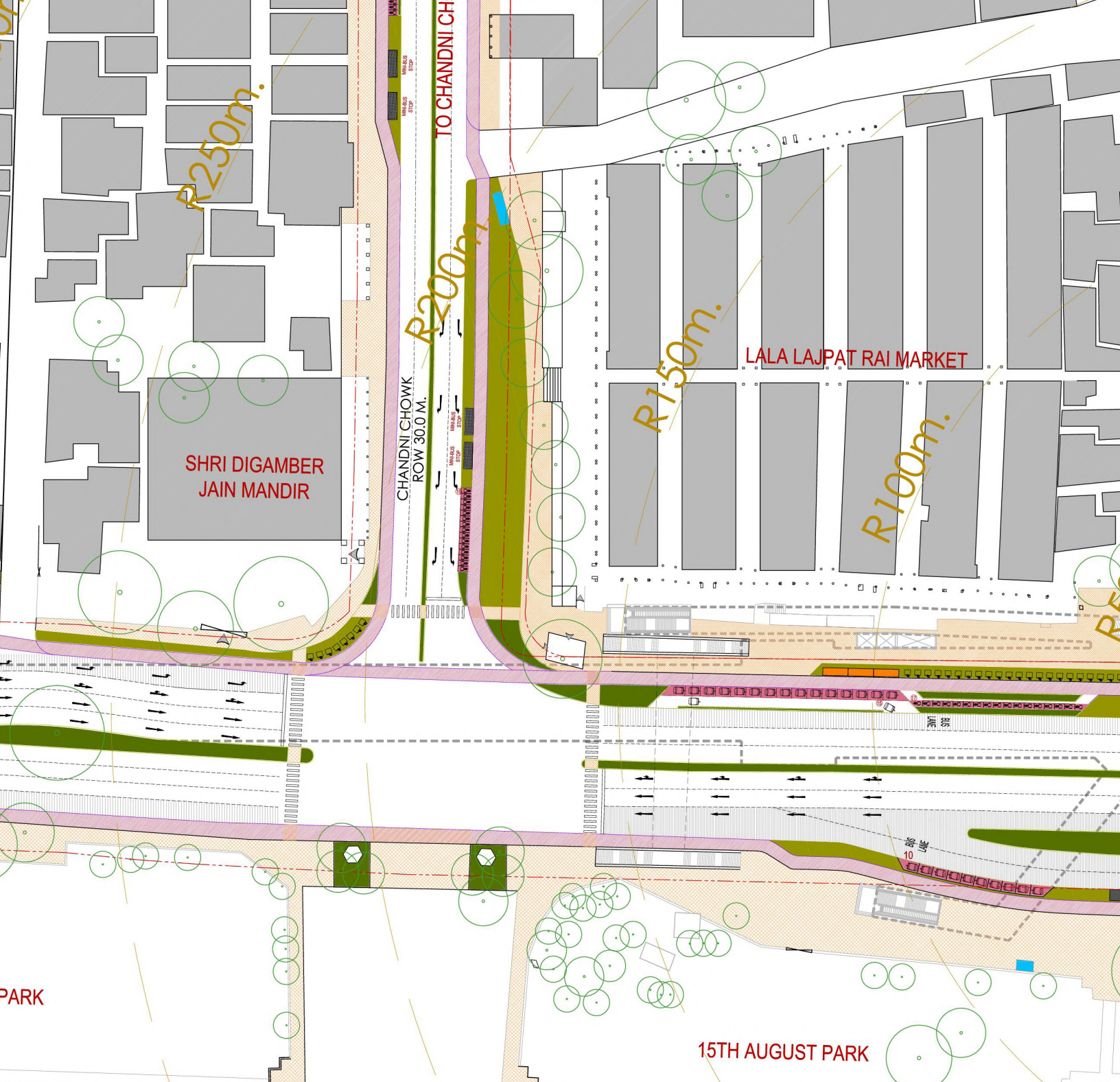

The main objective of the project was to seamlessly Integrate the various modes of transport commonly used by the general masses with the services of Delhi Metro, and provide them with a pleasant experience during their travel in the given context of historically located area of Old Delhi which also boasts many heritage tourist attractions like Jama masjid and Lal Quila (Red Fort).

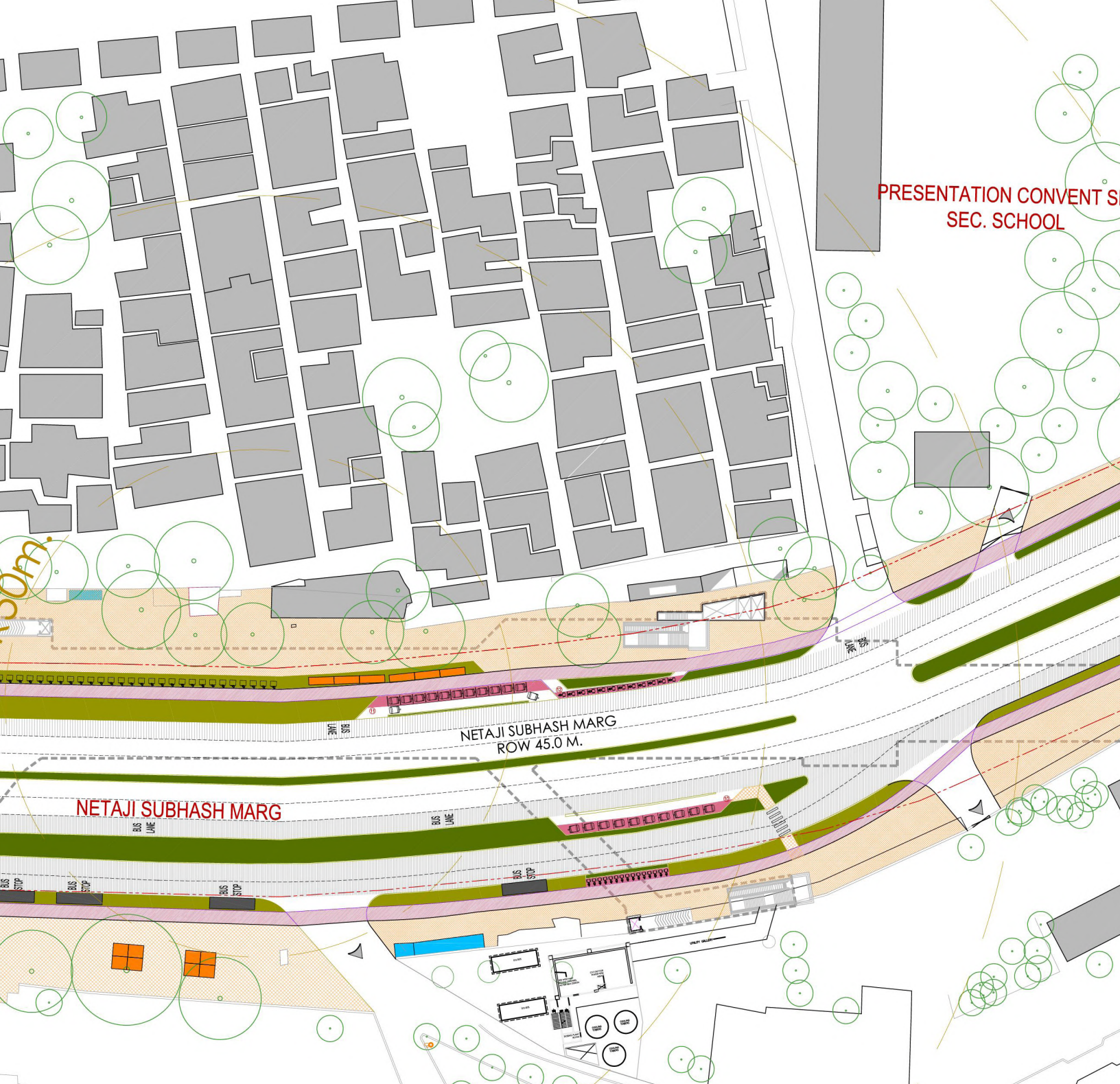

# MULTI - MODAL INTEGRATION

Delhi Metro Rail Corporation - Streetscape surveys and revamping station area

Firm : Vinyas - Architects and Landscape Architects

Term : December 2014 - August 2015

Location : Delhi, India

Supervisor : Mr Vijay Matange in a collaborative team of 4

Softwares Used : Sketchup | Adobe Creative Suite | MS Powerpoint

Contribution : Presentation + layouts (70%), Design proposal (50%), Research + On-site surveys (75%)





### Key Characteristics

- *Highly dense neighborhood*
- *daily wager workers - street vendors and hawkers*
- *Manual rickshaws primary mode of transport*
- *Availability of wide sidewalk widths towards Red Fort (Lal Quila)*



*Unjustified utilization of pedestrian right of way*



### Key challenges

- *Unjustified utilization of pedestrian right of way*
- *Over-encroachment because of hawkers and vendors.*
- *Unsafe walking environment for pedestrians and subway*
- *Active congestion on roadside*
- *Haphazard vehicular movement of multiple modes of transport*



*Encroachment by hawkers and vendors on footpaths*



*Unsafe walking and driving environments*



### Interventions

- *Provision of separate spaces for street hawkers and vendors*
- *Provision of mini-bus bays for buses plying in Chandni Chowk*
- *Optimized utilization of excessive right of way*
- *Redesigning of islands to incorporate pedestrian paths*



*Active congestion on roadside*

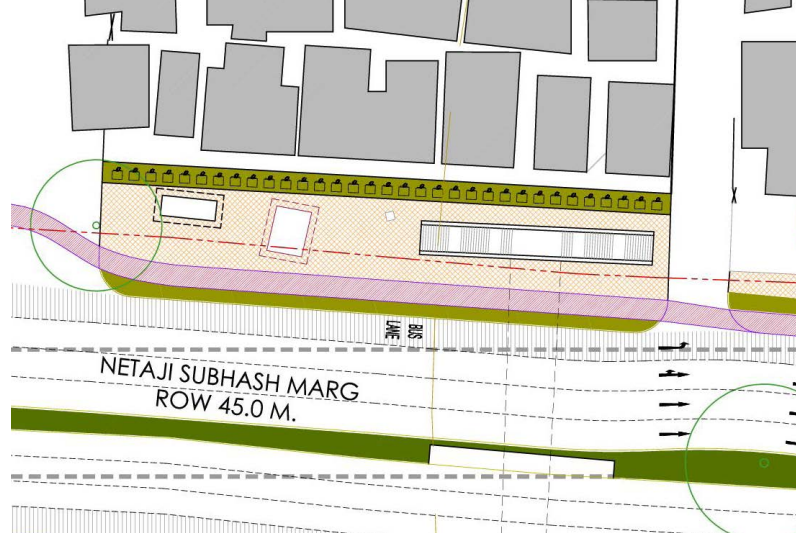

**1** Designated zones for hawkers and vendors  
Detailed Plan

Special zones for street vendors and hawkers allow the reduction in encroachment from intersections

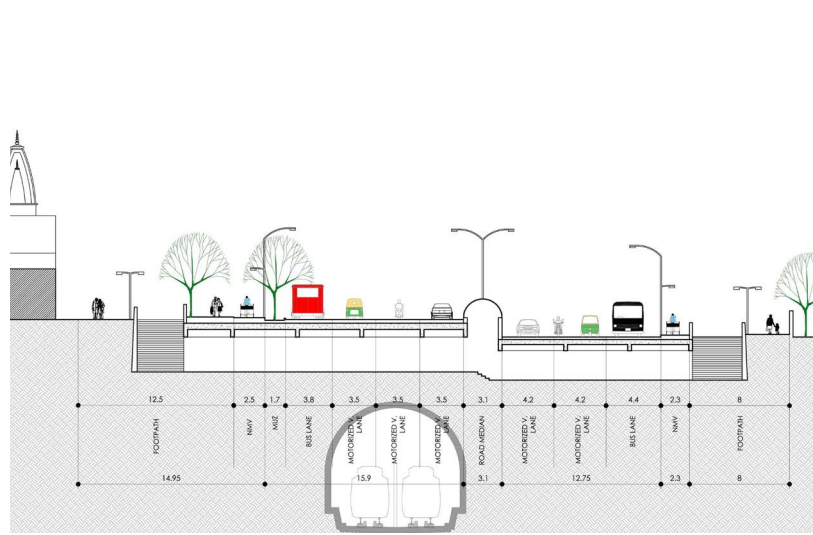

**2** Lane segregation  
Section at Shri Digambar Jain Mandir

1.7m Non- motorized vehicle (NMV) lane beside 12.5m footpath allows for safe pedestrian walking environment.

Multi-utility zone (MUZ) acts as a buffer between NMT and Vehicular lane.



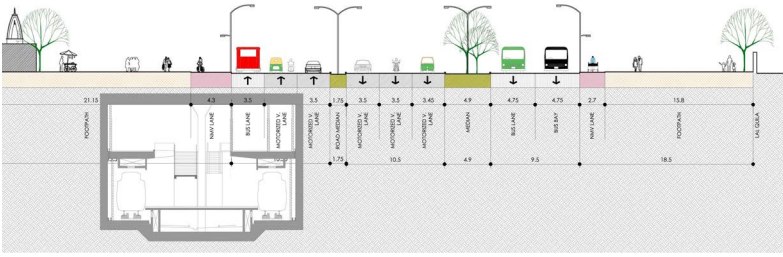

**3** Separate bus lanes  
Section through the front of Lal Quila

A wider footpath of 18.5m would allow for all the vendors at the intersection to move to this area, creating a more clearer path for pedestrians at intersection coming from Chandni Chowk

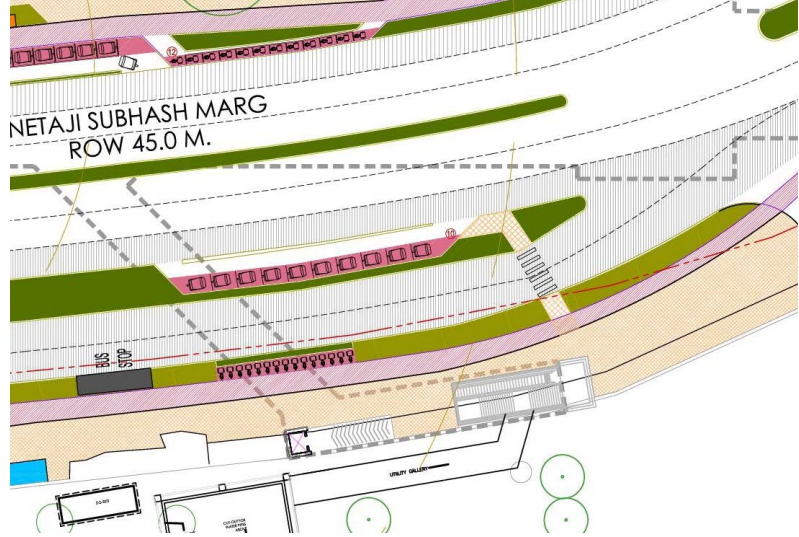

**4** Separate parking zones  
Detailed Plan

Separate parking zones for 3-wheelers (motor rickshaws and manual rickshaws) allows pedestrians to easily navigate between transit modes.

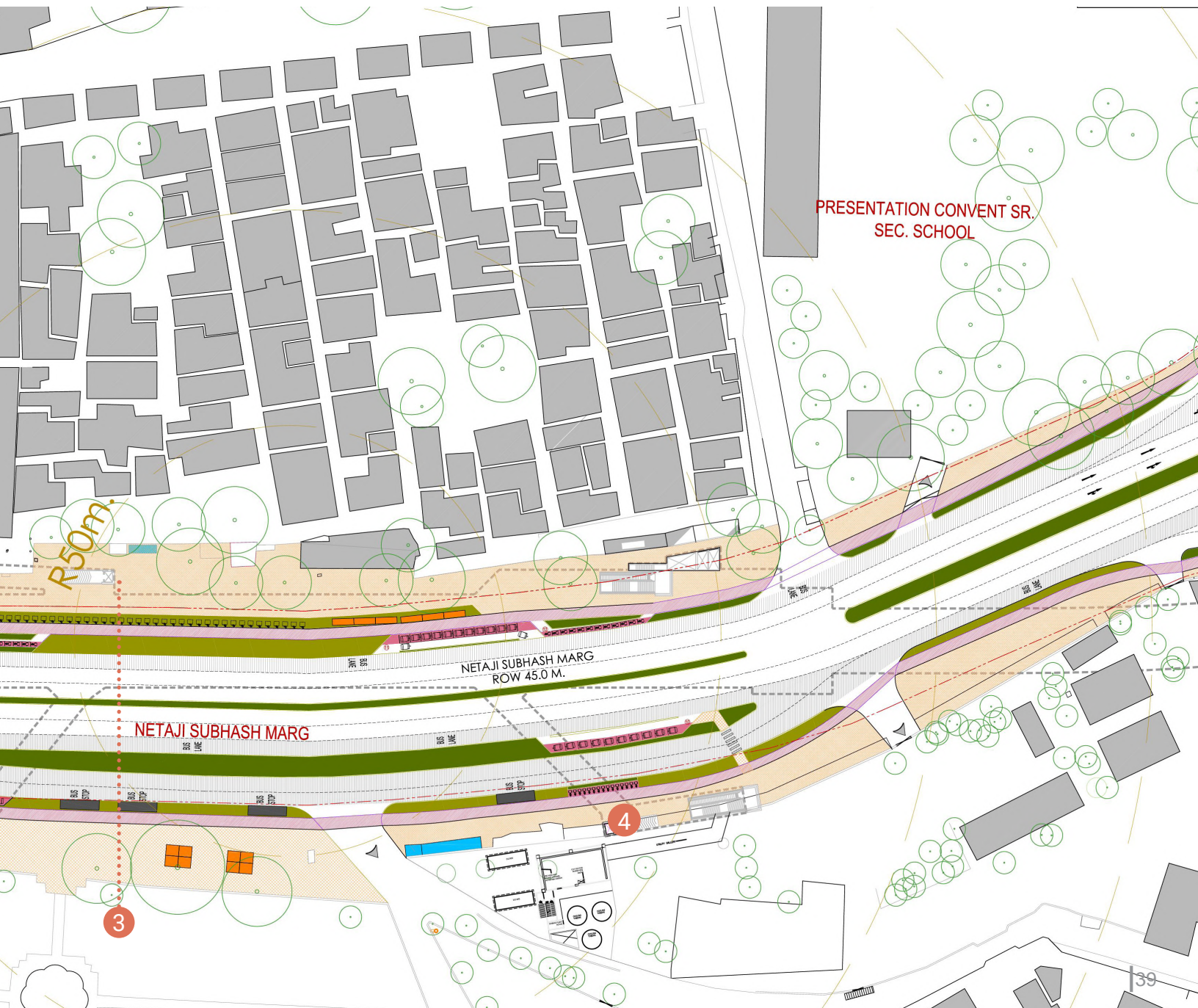



*A comprehensive master-plan development of Indian Institute of Technology ( an autonomous institution under Govt. of India) of 500 acres with phasing strategies, accommodating nearly 5,000 students in Phase 1 to 10,000 students in phase 3B. To spatially and experientially design a mini walkable educational city with state of art facilities and dedicated research park*



# INDIAN INSTITUTE OF TECHNOLOGY DHARWAD, KARNATAKA

*A green and sustainable educational city cradled within the expansive lands of Dharwad.*

*Firm : SGA (Suresh Goel and Associates) Design Lab, Delhi, India*

*Term : September 2017 - July 2018*

*Location : Dharwad, Karnataka*

*Supervisor : Ar. Sandeep Goel in a collaborative team of 7*

*Softwares Used : Sketchup | Adobe Creative Suite | MS Powerpoint | AutoCAD | Revit Architecture*

*Contribution : Presentation + layouts (70%), Design proposal (60%), Administrative (75%)*

Transitions in the mini-walkable educational city  
From educational zone to recreational zone to residential zones

One of the main concepts was to seamlessly integrate the whole 500 acre site into a cohesive and integrated wholesome experience

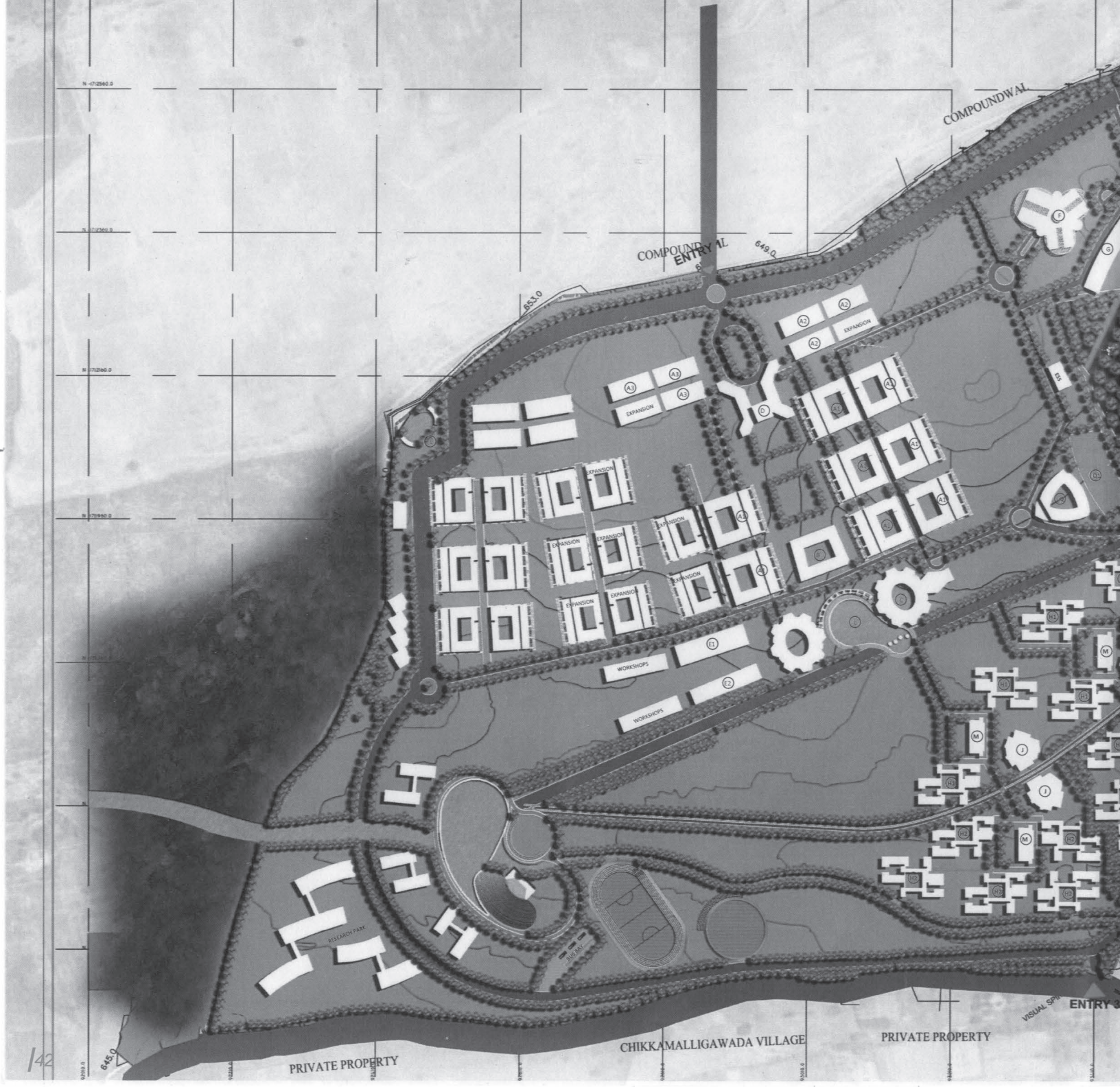



SCALE : 1 : 1000  
SCALE : 1CM 10M

CHIKKAMALLIGAWADA VILLAGE LEGEND

BUILDING	NO.S	HEIGHT
<b>ACADEMIC ZONE</b>		
ENGINEERING DEPT.	A1	G+6
SCIENCE DEPT.	A2	G+3
MATHS DEPT.	A3	G+3
LIBRARY	B	G+4
LECTURE THEATRE	C	G+2
ADMIN	D	G+4
UG STUDIES BLOCK	E1	G+3
CENTRAL INSTRUMENTATION	E2	G+3
CONVENTION CENTER	F	-
<b>HOUSING AND HOSTELS</b>		
GUEST HOUSE	G	G+2
HOSTEL - SINGLE GIRLS	H1	G+8
HOSTEL - TRIPLE GIRLS	H2	G+11
HOSTEL - SINGLE BOYS	H3	G+8
HOSTEL - TRIPLE BOYS	H4	G+8
MARRIED STUDENTS' HOUSING	H5	G+8
DINING	J	G+3
DIRECTOR'S RESIDENCE	HS D	G+1
TYPE V (Near Forest)	HS 5A	G+8
TYPE V (Around Central Park)	HS 5B	G+11
TYPE IV (Frontage)	HS 4A	G+8
TYPE IV (Second row to frontage)	HS 4B	G+11
TYPE IV (Left side of residential green buffer )	HS 4B	G+11
TYPE III (Near Semicircular Playground)	HS 3	G+8
TYPE II (Right side of residential green buffer )	HS 2	G+8
<b>COMMUNITY ZONES</b>		
CAFES	K	G
LAKE	L	-
COMMON ROOM	M	G+1
COMMUNITY CENTER	N1	G+1
HEALTH AND WELLNESS CENTER	N2	G+1
SHOPPING CENTER	N3	G+1
DAY CARE (CRECHE)	N4	G
FACULTY CLUB	N5	G+1
OPEN AIR THEATRE	O	-
STUDENT ACTIVITY CENTER	P	G+1
<b>SPORTS AND RECREATION</b>		
SPORTS CENTER	Q	G+2
SWIMMING POOL (STUDENTS)	Q1	-
SWIMMING POOL (FACULTY)	Q2	-
CRICKET FIELD	Q3	-
FOOTBALL GROUND	Q4	-
SCHOOL	S	-
SCHOOL PLAYGROUND	SP	-



ANSHU DARBARI  
anshu.darbari@gmail.com  
<http://bafflingparadoxes.blogspot.com/>  
+91-8860.474366  
+1-513.518.6928