

hello.

Undergraduate Portfolio
Selected works (2016 - 2019)



MINNA ELIZABETH

ARCHITECTURE GRADUATE
AVANI INSTITUTE OF DESIGN

NATIONALITY : INDIAN

CONTACT



THARAKAN HOUSE KOTTAPADI ,
P.O THRISSUR.



9288288888



minnaelizabeth@icloud.com



minnaelizabeth
thepooopcomics

EXPOSURE

Draw , dream , design by Ajith Rao

Sketching workshop by Ar Brijesh

Design workshop by Peter Rich

Photography workshop by Shaheen

Visual art workshops by Murali Cheeroth

Housing settlement study by Ar Soumini

Jewellery design course by IGI India

SKILLS

Autocad
Rhinoceros 3D
Illustrator
Sketchup
Photoshop
Indesign

INTERESTS

Doodle
Illustration
Photography
Videography
Sketching
Travelling
Digital Rendering
Product design
Jewellery Design
Social Media Curator

ACHIEVEMENTS

Traces I
Traces II

Uruvam phase 1
Uruvam phase 2

Cultural secretary at AVANI



Traces : An exhibition of work inspired
by the journey of students of Avani.
An expanse of collective memories
immortalised with an urge to make the
seamless moments last where collective
knowledge and shared learnings
takes place .

2016 Madurai , Auroville , Dhanushkodi

2017 Hyderabad , Orissa

2019 Ahmedabad

Videography

<https://www.youtube.com/watch?v=9jySDMjJVJI>

CONTENTS

Second year

Residence design

Second year

Urban observatory

Third year

Interior design project

Third year

Public space design

First year

Product design

Travel photography , sketches , illustration

Extra curriculum

Life at Avani



RESIDENCE DESIGN



URBAN OBSERVATORY

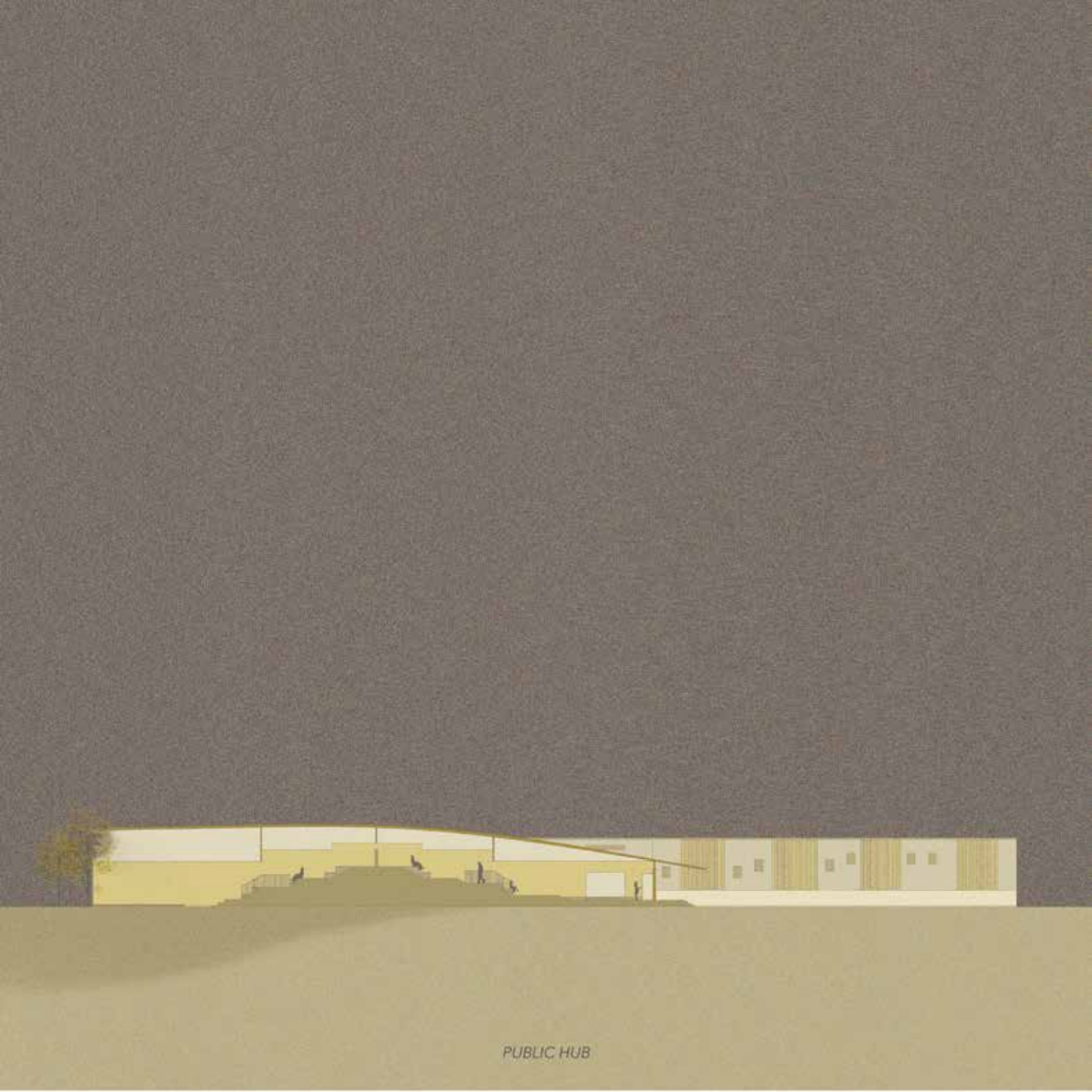

PUBLIC HUB

COCOON

the project was to design a residence for the clients Abhay, Veena, their kids , Karuna and Daya , and two dogs Bobo and Bojo on a plantation site considering the *site features and client requirements*.

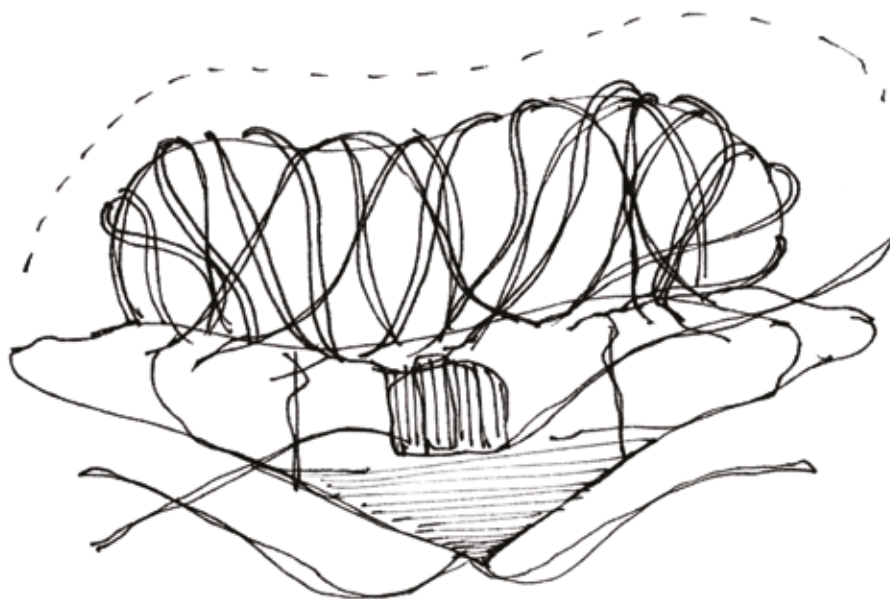

house around trees
COCOON

ABOUT THE SITE

LOCATION : AMBAYATHODE , THAMARASSERY
CALICUT , KERALA , INDIA

SITE : APPROX 3.5 KMS FROM NH212



CIRCULATION
No defined approach to the site and lack of visual access from roads found due to thick vegetation.



VEGETATION
Trees are aligned in grid pattern.



TOPOGRAPHY
There is a slight slope towards the river . Natural surface drainage due to the slope.

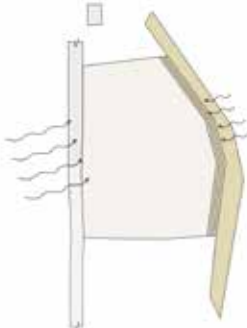

CLIMATE
Wind flow blocked by the trees which can be avoided by reducing the number. Micro wind pattern found from the river stream.



SENSORY
Noise of footsteps on dry leaves also found. The plantation creates frames by the rows of trees that creates views .



UTILITIES
There is an electric post and a pump house present on the site.

THE THREAD FORMATION

CONCEPT

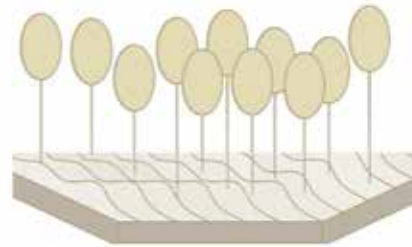

LAYERS ON THE SITE
a layer of green trees and
a layer of brown dry leaves



AMALAGAMATE
to one single layer



PROTECTIVE SHIELD
protective covering at two
levels

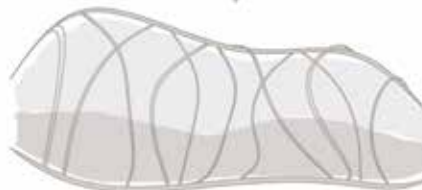

THREAD FORMATION
joining the threads of the
site
FORMING THE COCOON

COCOON



Air flows over the canopy
To bring the wind into the site.



Create physical as well as visual access
with the waterbody.



Sound more active sensory than sight.



Entry in the direction of the wind.



Focusing the nutmeg trees and incorporating
those in my design.

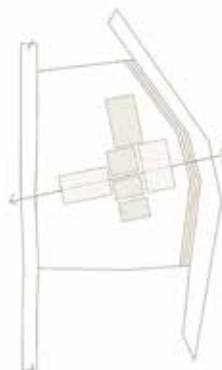

Aligned in the direction of wind.
Focusing on client requirements
creating public interface zones in
front of the house.

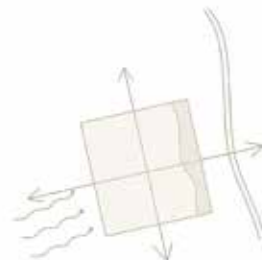

Maximum openings towards the east
to let in maximum microwind from the
river.

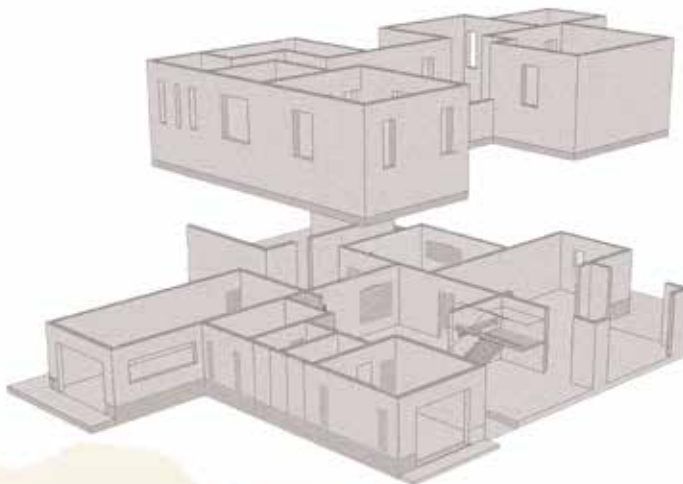

THE THREAD FORMATION

DRAWINGS

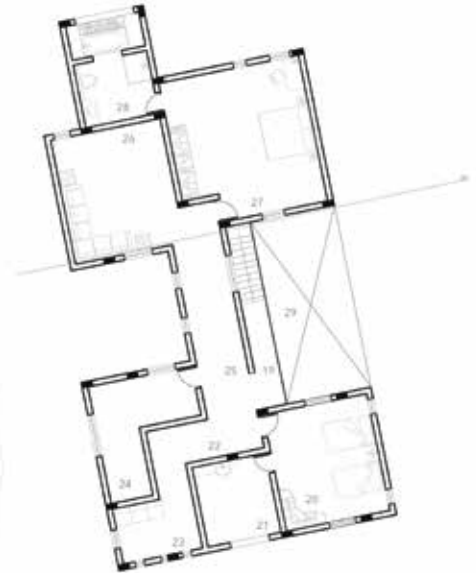

- | | | | | |
|-----------------|--------------------------|---------------------|------------------|------------------------|
| 1 MAIN ENTRY | 7 GATHERING SPACE | 13 POOJA SPACE | 19 WALKWAY | 25 WALKWAY |
| 2 GARAGE | 8 GUEST SPACE | 14 STAIR SPACE | 20 KIDS ROOM | 26 ENTERTAINMENT SPACE |
| 3 BAKE HOUSE | 9 GUEST RESTROOM | 15 SITOUT | 21 KIDS RESTROOM | 27 MASTER BEDROOM |
| 4 STORE ROOM | 10 GRANDPARENTS RESTROOM | 16 COOKING SPACE | 22 BOOK SPACE | 28 LUXURY RESTROOM |
| 5 ABHAYS STUDIO | 11 GRANDPARENTS ROOM | 17 FAMILY DINE AREA | 23 READING SPACE | 29 SEEN BELOW |
| 6 ENTRY | 12 EXTENDED LIVING AREA | 18 DINNING SPACE | 24 GYM AREA | |

SCALE 1:100

SECTION AA'



F A B R I C

the project was to do an analytical study of the beach and experiential understanding of piers and to also design a space in *tribute to the old now broken bridge* .

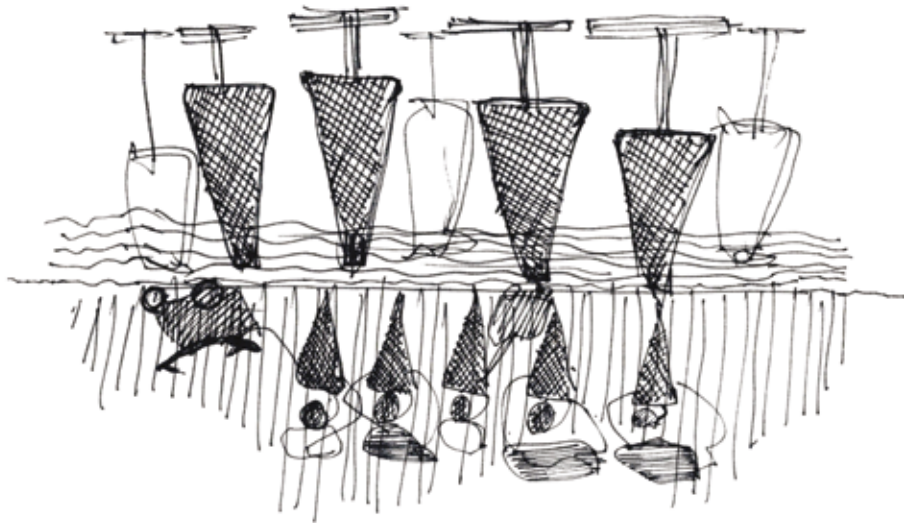

tribute to old calicut pier

FABRIC

WEAVING PROCESS

WHAT MORE CAN MY PIER BE ?

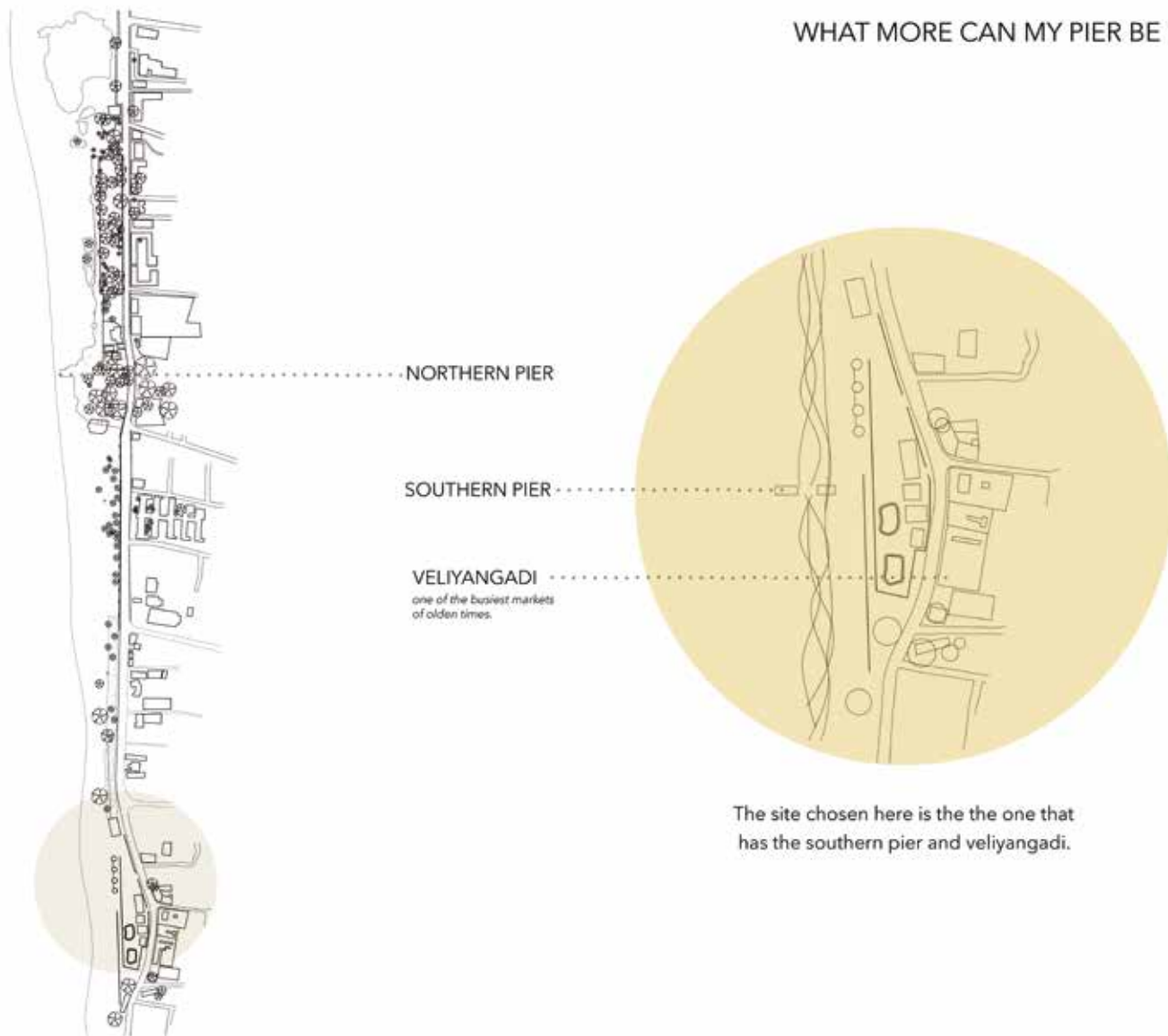

BEACH STUDY

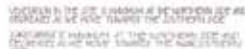

BEACH STUDY

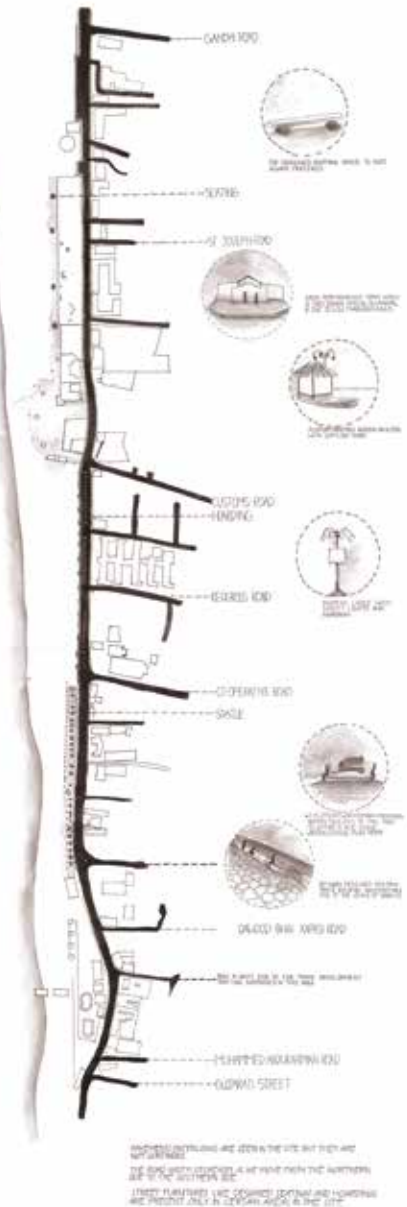
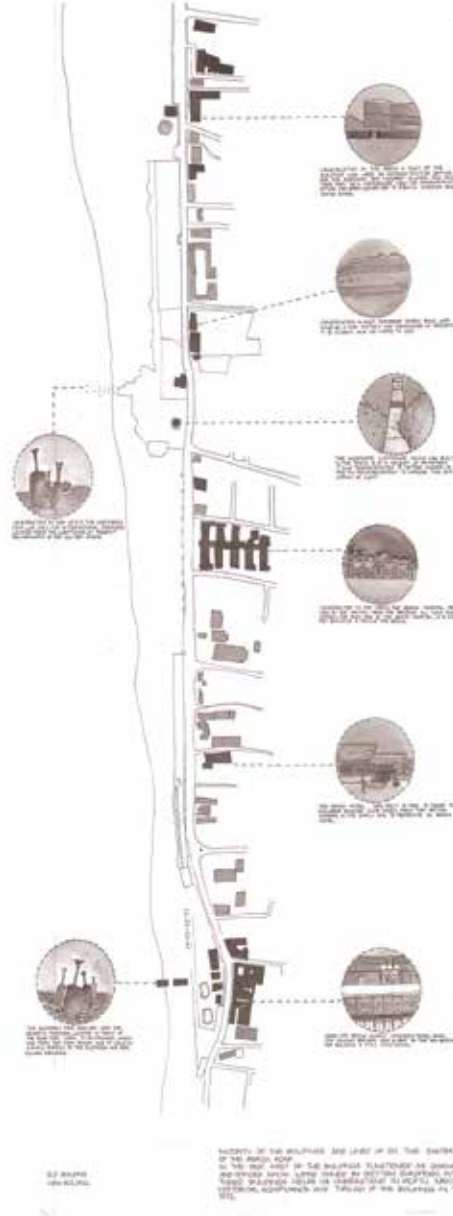

WEAVING PROCESS

WHY THIS PART OF THE SITE ?



The site has two extreme activities happening on either sides. No proper access to the beach area.



There are trade activities happening in veliyangadi which includes loading and unloading of goods.



A dull end and a busy end

HOW CAN I SATISFY THEIR NEEDS?

WHY IS VALIYANGADI NOW INACTIVE?

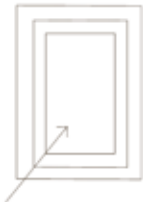

MEMORIES

Framed views helps one recall the past.

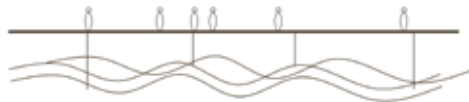

EXPIERENCE

Creating an interactive platform focusing on water element.



CONVERGE

Space open to all, letting in everyone.

WEAVING PROCESS

CAN MY PIER BE AN EXTENSION OF LAND TO SEA?

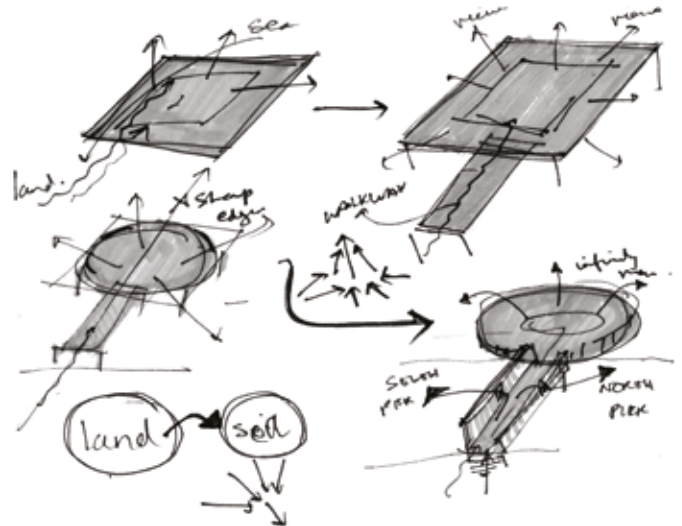

HOW CAN I ENHANCE THE EXPERIENTIAL QUALITY OF MY PIER?



Enhancing the experience by providing seating spaces



Avoiding sharp edges creating infinite view to sea



Provide shaded areas .Overhead plane atcs as a buffering zone.

▲ PLAN

SEATING SPACE

VIEW TO NORTHERN PIER

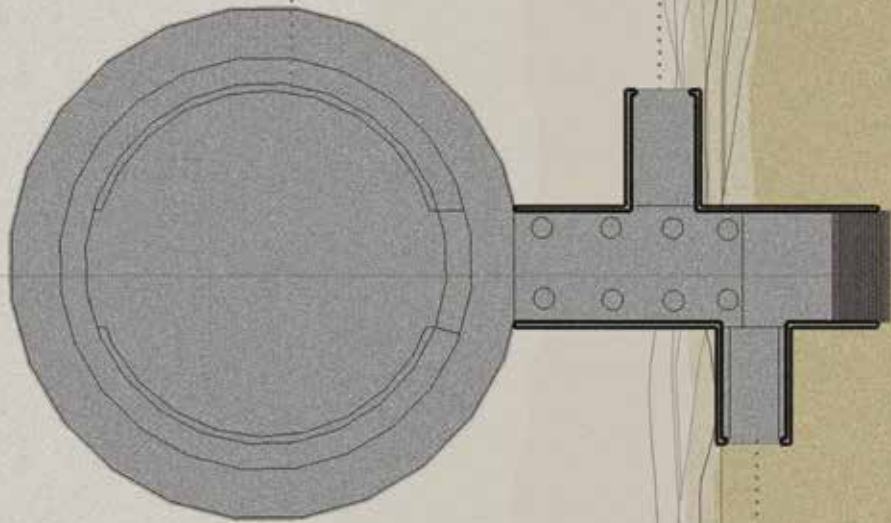

VIEW TO SOUTHERN PIER

FABRIC

SECTION AA'

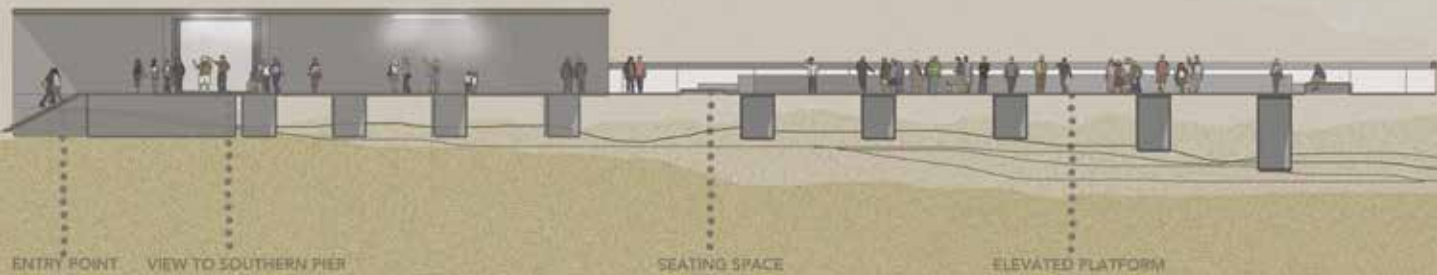

FABRIC

BRIDGE

the project intends to enhance public culture of Kaloor by providing a space for people , art and culture to perform , celebrate and perpetuate .The design focused on *connecting metro to the stadium* .



a place for people , art and culture

BRIDGE

URBAN STUDY

EXPERIENCE

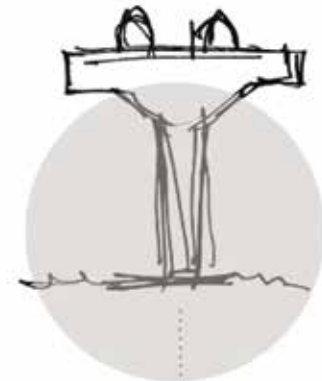
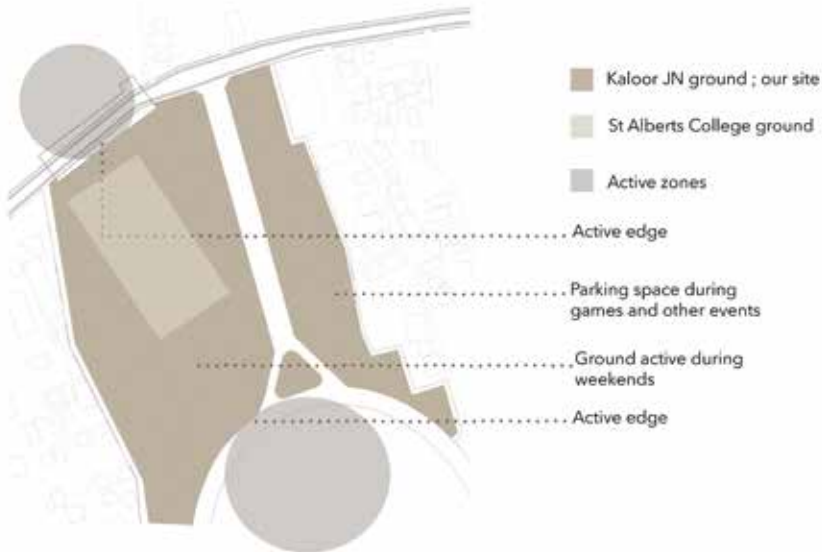

CONNECTING THE TWO EDGES AND
ACTIVATING THE PASSIVE ZONE



Built a library space , auditorium
space , expo space , parking space.

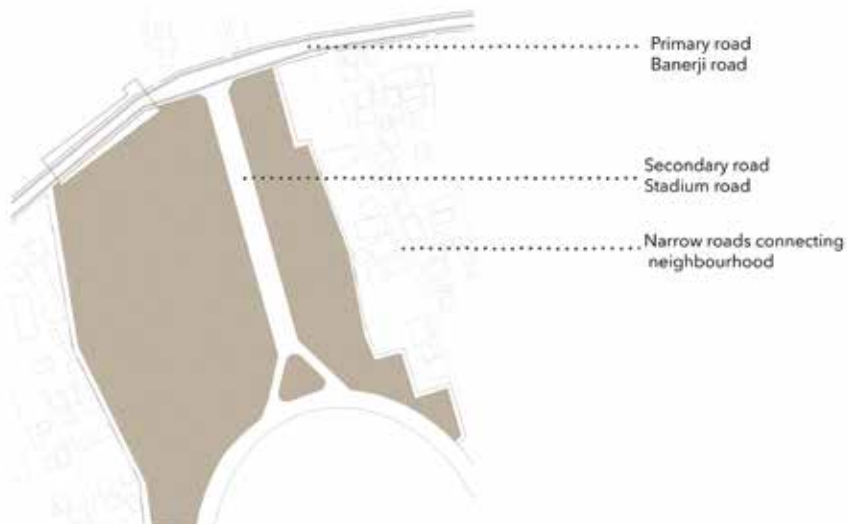

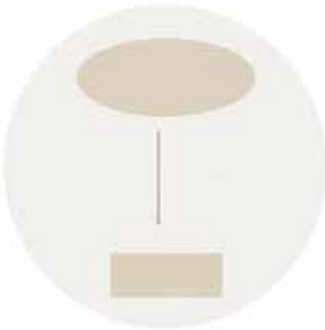

Providing direct access from the metro



Performance and exhibition spaces near metro zone



Providing elevated platforms for the users enhancing quality of space



Avoid parking facility to increase the use of public transportation



Gathering point provided in front of metro



Seatings with with shade along the edges



URBAN STUDY

PARAMETERS

CONCEPTUAL DIAGRAMS

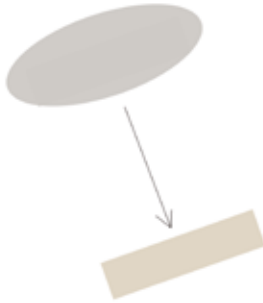

ACCESS
From metro to stadium



DEFINING PATHWAY
Exhibition along the access

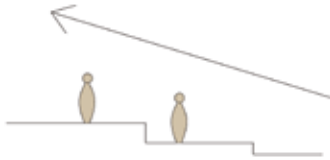

VIEWS
Playing with levels

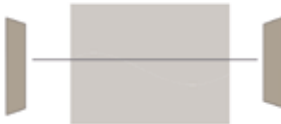

MAXIMUM OPENINGS
Facilitating cross ventilation



iteration 1

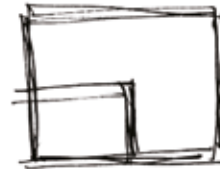

iteration 2



iteration 3

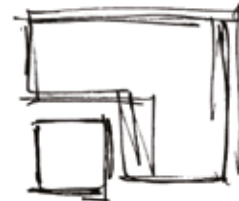

iteration 4



iteration 5

URBAN STUDY

UNDERSTANDING

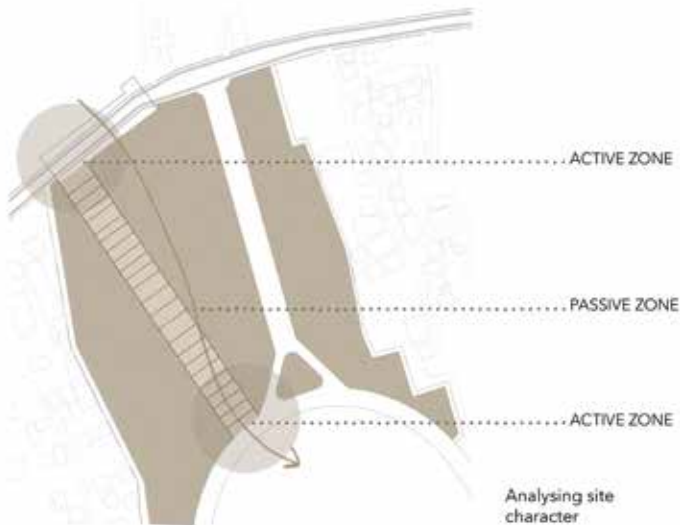
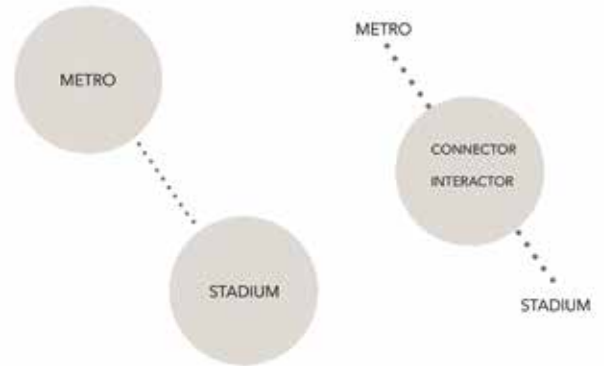
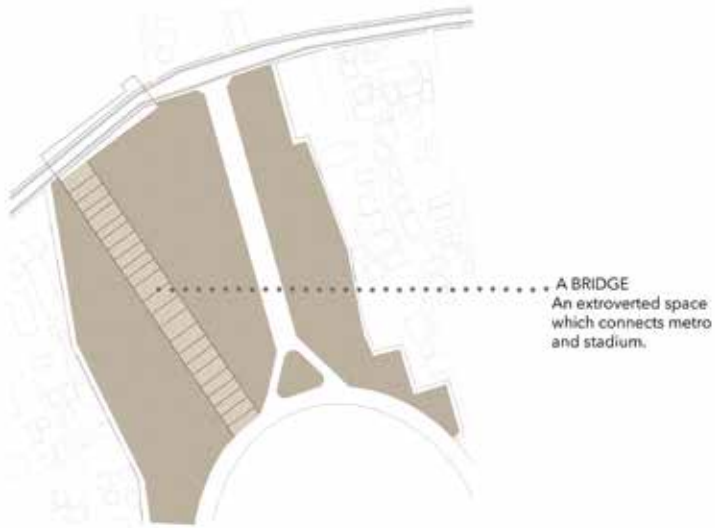

URBAN STUDY

INTERPRETATION



Parking facility provided on the other side of the ground so as to let in less number of vehicles into the site and to increase use of public transportation.

A walkway provided leading to the stadium with different spaces aligned in the pathway.

A gathering space provided in front of the metro, acts as a buffering point.

Library space that leads to the open amphitheatre space creating elevated platforms.

The intermediate space between library and amphitheatre acts as a transition space.

Space left open for exhibitions and other events.

On either sides of the walkway gallery spaces are provided so as get people engaged.

Retained the main activity of the ground which includes sports activities.

Playground surrounded by trees and plants.



Library placed at the centre point and amphitheatre placed on the other end of library space, activating the passive zones with two extreme activities.



Gathering point placed in front of the metro space



Activating the whole pathway providing exhibition spaces alongside



Stadium acts as a backdrop of the performance space



A part of the site left open for exhibitions and other events



Open book space welcoming the neighbourhood is provided at the edge

URBAN STUDY

DRAWINGS

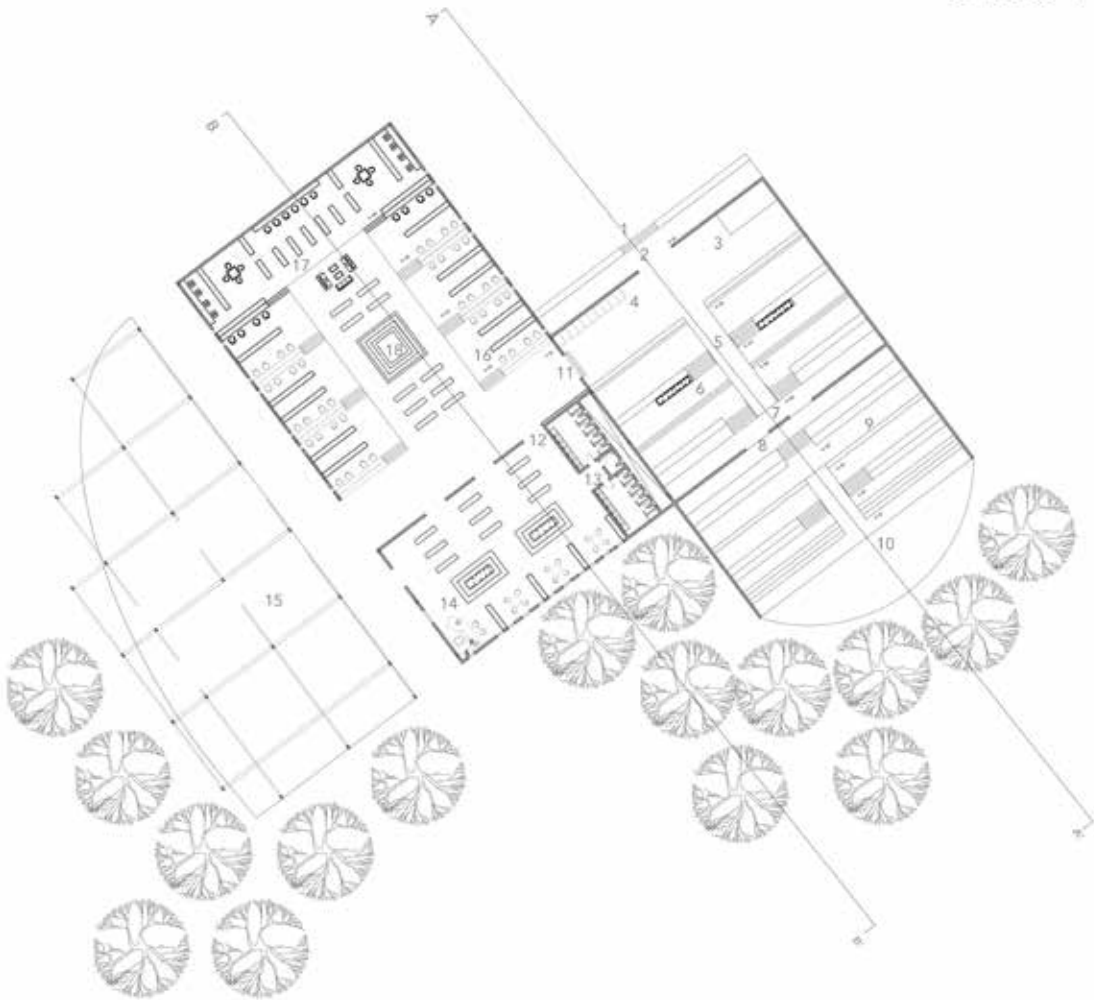

- 1 WALKWAY LEADING TO THE LIBRARY
- 2 VERANDAH SPACE
- 3 FOYER SPACE
- 4 LOCKER SPACE
- 5 WALKWAY AT 60 LVL LEADING TO THE THEATRE
- 6 STEPPED PLATFORM OF DISCUSSION SPACE IN LIBRARY

- 7 TRANSITION SPACE
- 8 QAT
- 9 STEPPED PLATFORM GOING DOWN
- 10 PERFORMANCE SPACE
- 11 LIBRARY SPACE
- 12 BOOK SPACE

- 13 RESTROOM SPACE
- 14 LIBRARIAN SPACE
- 15 OPEN READING SPACE
- 16 STEPPED PLATFORM WITH BOOK SPACE
- 17 BOOK SPACE WITH VIEW TO THE METRO
- 18 COURTYARD SPACE BTW BOOKS

URBAN STUDY

DRAWINGS



SECTION AA'



SECTION BB'

BRIDGE

RESIDENCE DESIGN

WORKING DRAWING

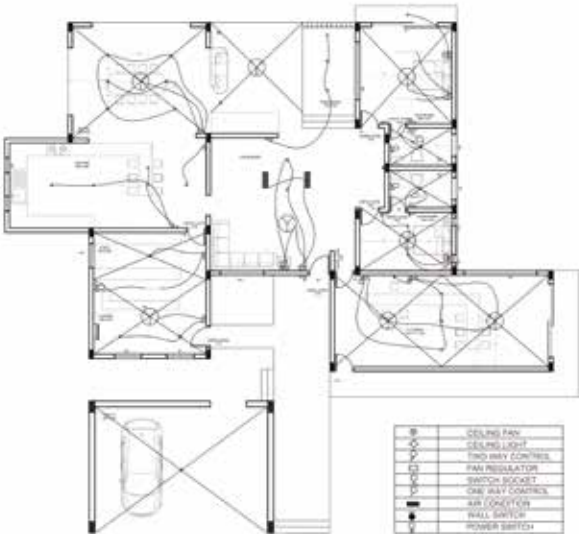

ELECTRICAL DRAWING



TOILET DETAILS



COCOON

POROUS BOX

the project was to redesign the interiors of our studio space following the parametres , the design focused on *creating flexible spaces* that controls the harsh light entries.

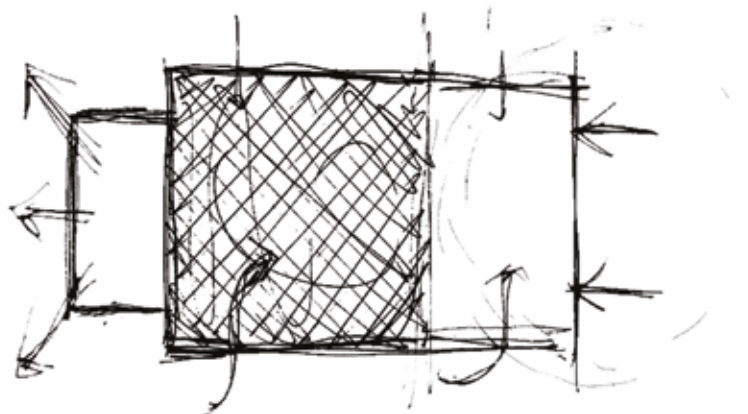

redesign interiors of the studio

POROUS BOX

STUDIO REDESIGN

ANALYSIS

LOCATION : AVANI INSTITUTE OF DESIGN
GROUND FLOOR
THAMARASSERY



BLACK



GREY



LIGHT BROWN



DARK BROWN



GREEN

COLOUR PALLETTE

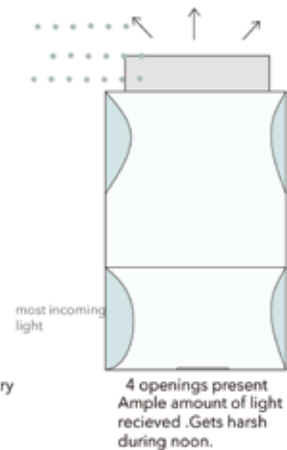
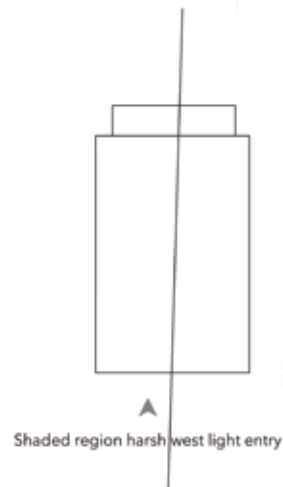
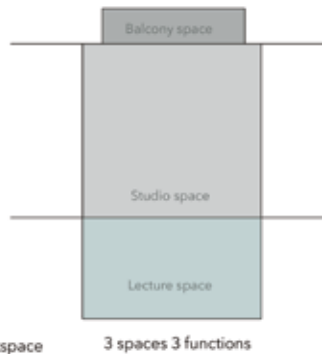
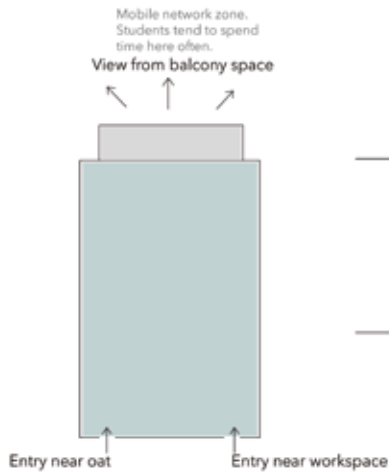

STEEL GRILLS
AND NET



BRICK WALL



CONCRETE WALL

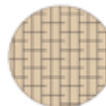

JUTE TAC BOARDS



PVS PIPE



TANDOOR TILES



POTS

MATERIAL PALLETTE

POROUS BOX

STUDIO REDESIGN

PARAMETERS

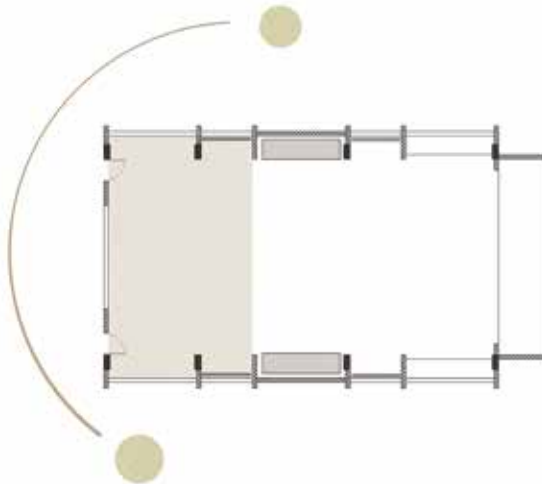

Intend

Providing space with ample amount of light entry .Creating flexible spaces for the user with easily movable furnitures . A furniture being a module and subtracting and adding features on it. Making the space more user friendly.

LIMITATIONS

Walls
Pillars
Beams

POSSIBILITIES

Light control
Furniture
Material
Colour

ISSUES

Entry of harsh light
No movable tables

Flexible tac
board scrollers

West light entry
reduced maximum
using louvres

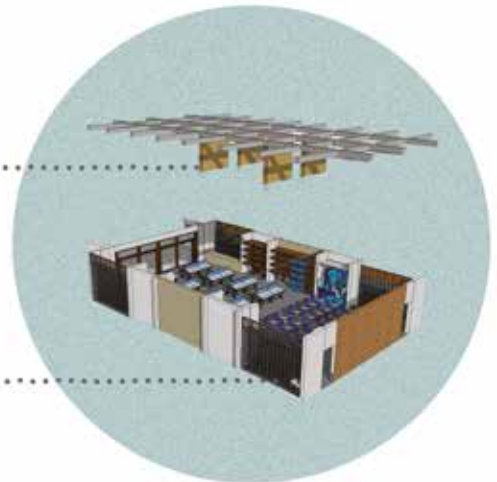

CROSS SECTIONAL VIEWS

INSIDE THE BOX



BLUE JUTE



LIGHT BROWN
BOARDS



DARK BROWN
VENEER



BLUE FABRIC



CLADDING



STUCCO WHITE



BRICK

MATERIAL COLOUR PALLETTE



FRAME 1

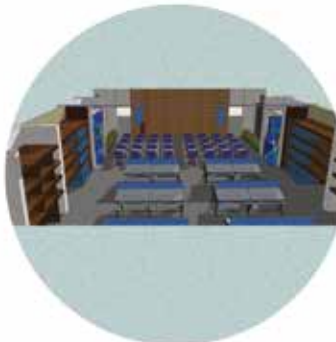

FRAME 2



FRAME 3

VIEWS

BRICK WALL
WITH BLUE
TAC BOARDS

OPENING

WOODEN
LOUVRES

SEATING
SPACE WITH
STORAGE

SHELVES

FOLDABLE
PINUP
BOARDS

SHELVES

LEVEL
DIFFERENCE

DRAWING BOARDS
WITH ROLLERS

SEATING SPACE

TAC
BOARDS

DISCUSSION
SPACE

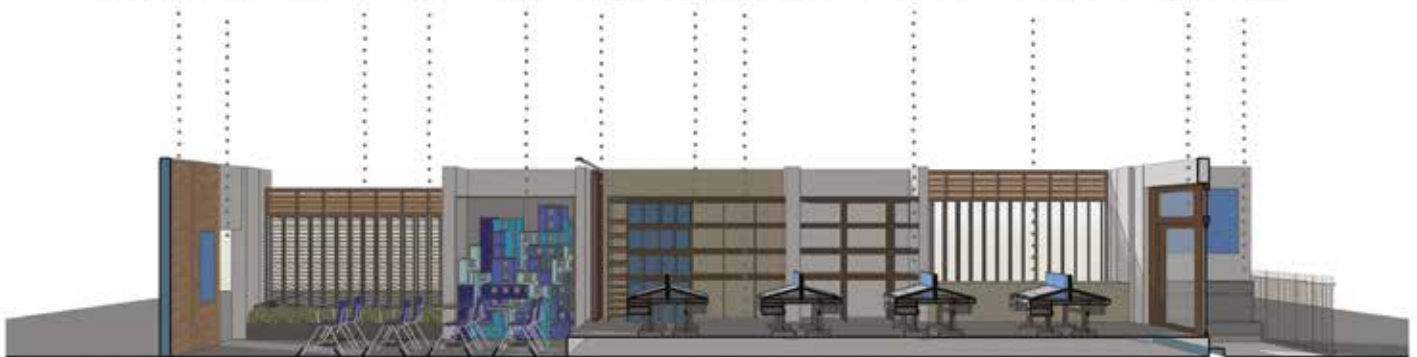

SECTIONAL VIEW

POROUS BOX

THE BOX



ADDITIONS

Wooden louveres controlling west light
Chairs with ample storage space
Plantscaping done wisely
Level difference provided differentiating functions
Discussion spaces provided at the balcony space
Ample storage space and tac boards



POROUS BOX

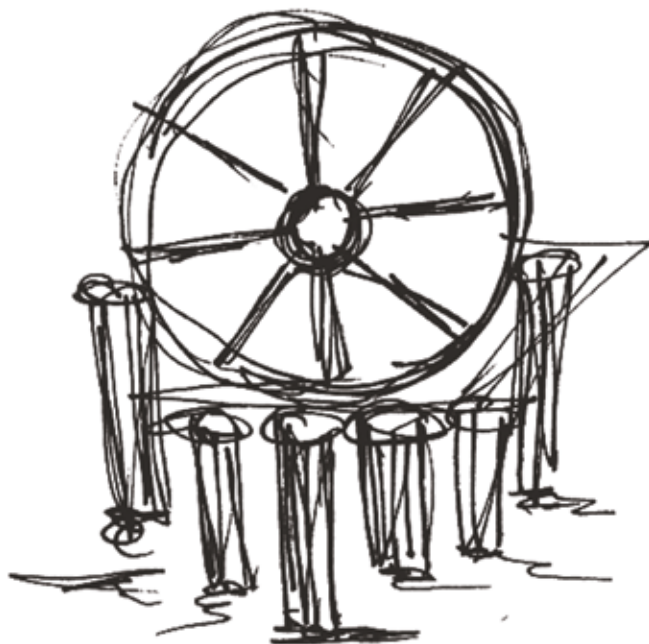

*a chair for the biennale pavilion
best out of waste*

VRITHAM

VRITHAM 0.1

THE COMFORT CUSHION



The back rest is made out of cycle tyre and threads of certain thickness used to support the leaning weight of the person.



The part that we had got was the arm rest which had intricate details like beading.



Seating is done out of bike tyre and a cushion is placed at the centre.



Person can either rest his/her foot at the rim or he/she can pull the extension with their foot itself.



VRITHAM 0.2

ROLLED UP



Inspiration from Shigu Ruban works



Best out of waste product
Material - Paper rolls







A cartoon illustration of a man with a distressed expression, shouting. He has two speech bubbles. The first bubble says "JURY HASN'T RULY, FRALLY". The second bubble says "CHECHNI AMMA VILLI RANU PO CHECHNI FOODZ".

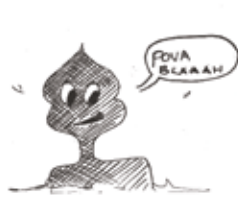



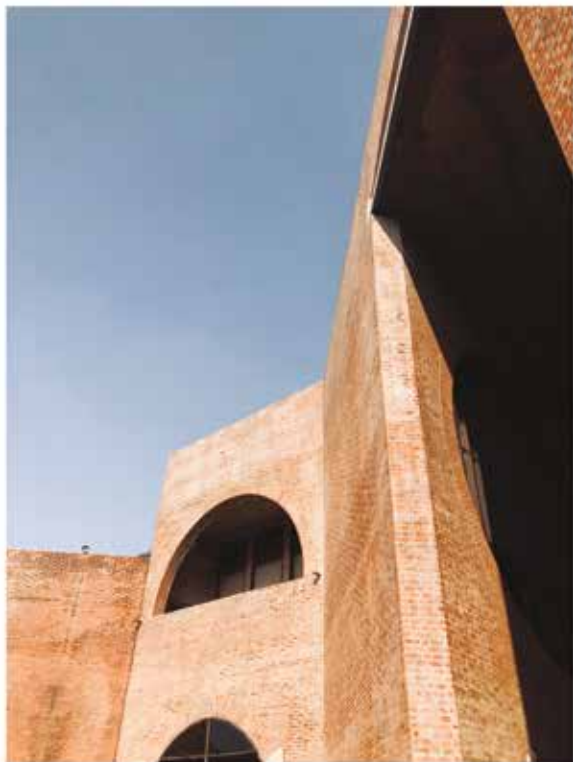





UNDERSTAND

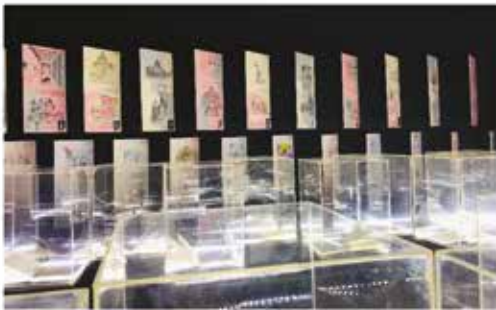

PARTICIPATE



9288288888

minna.e.16@avani.edu.in