

YU-WEN 'TWIGGY' CHEN



SELECTED WORKS

Twigg



I am a designer who passionately explores new ideas with emerging technology and timeless craft. With 9 years of experience, my work facilitates how we interact with space and how objects tell our stories.

Born and raised in Taiwan, I relocated to San Francisco after transferring my college studies to California College of the Arts. While building my skills in industrial design, I found a true voice in craft through studying furniture design. Since 2016, I've collaborated with furniture designers, craftsmen, and interior designers to further my understanding of creative pursuits. With both backgrounds in Eastern and Western life experiences, I blend both influences into my design practice.

PROJECTS

A_ Tahoe Lakehouse p.4 - p.11

B_ Sugarbowl Ski Cabin p.12 - p.15

C _ San Anselmo Residence p.16 - p.19

D _ Custom Shelf Unit p.20 - p.23

E _ BWL Lounge Chair Prototype p.24 - p.25

F _ Fold Dresser p.26 - p.27

G _ Inner Flame Liquor Cabinet p.28

H _ Cascade Coffee Table p.29

I _ Hidden Assembly p.30

J _ Experimental Furniture p.31

A_ TAHOE LAKEHOUSE

The west shore of Lake Tahoe, California, nestles a historical lakehouse designed by the architect Richard Whitaker.

This full-scale renovation honors the house's well-refined architectural elements while bridging a modern interior design that suits our client's aesthetic preferences.





A_ TAHOE LAKEHOUSE

Kitchen cabinetry and hardware design development

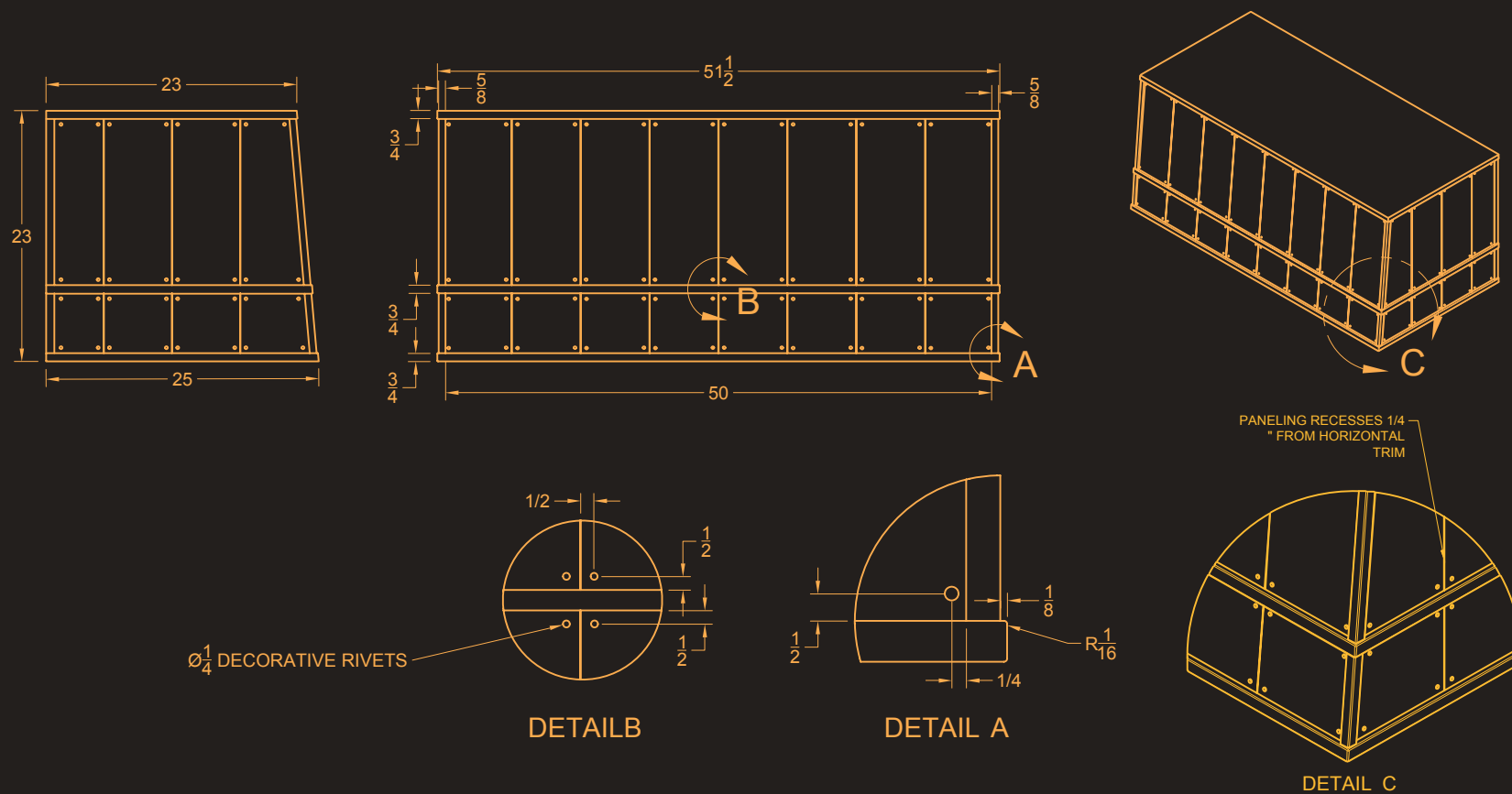

Custom hood design



Cabinetry material study

A_ TAHOE LAKEHOUSE





A_ TAHOE LAKEHOUSE

Custom Dining Table

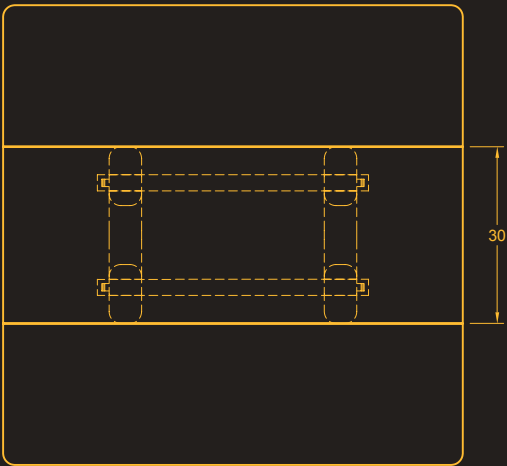

TOP ELEVATION

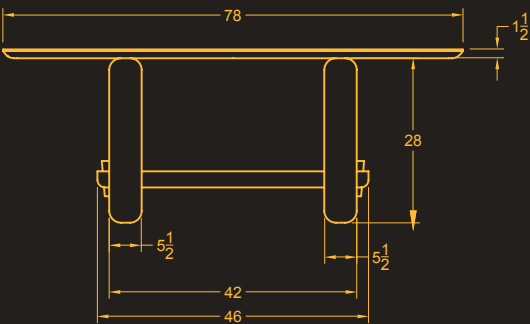

FRONT ELEVATION

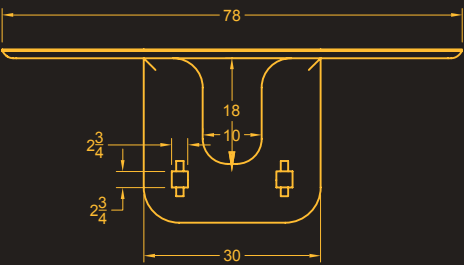

SIDE ELEVATION

A_ TAHOE LAKEHOUSE

Bar nook custom cabinetry and upholstery



A_ TAHOE LAKEHOUSE



A_ TAHOE LAKEHOUSE

Bedroom custom cabinetry and soft furnishings





A_ TAHOE LAKEHOUSE

Bedroom custom cabinetry and soft furnishings





B_ SUGARBOWL SKI CABIN

A Bavarian-inspired cabin, tucked away in a private ski resort in Sugarbowl, California.

This three-level, four-bedroom and four-bathroom cabin serves as a cozy vacation home for a family of five. Our designer and filmmaker clients had a unique vision of each room. I worked with the design team and fabricators to bring their inspirations to life.

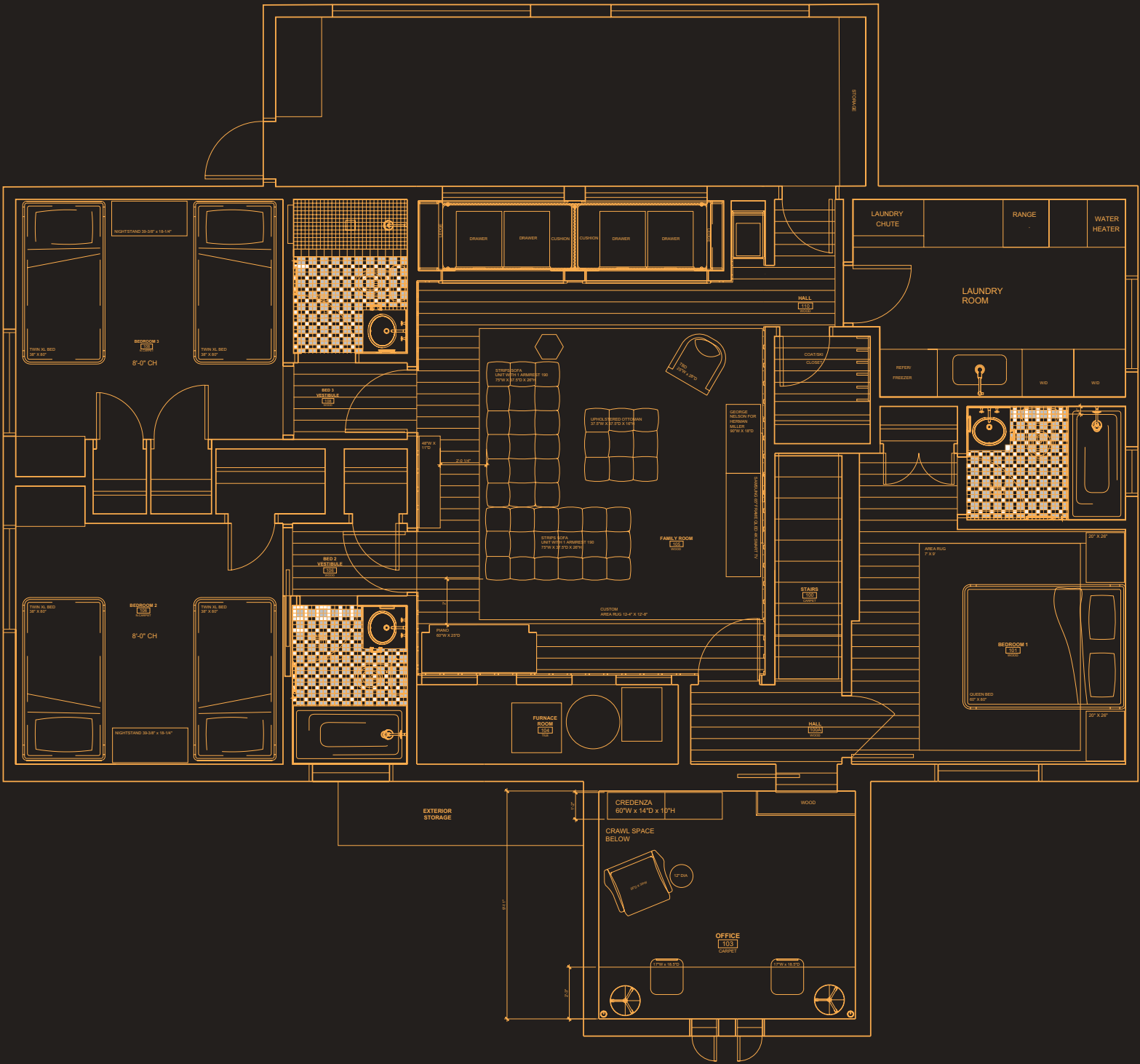

FIRST FLOOR OVERALL FLOOR PLAN



Custom seating, window covering, hardware



Family room reading nook



Custom lighting

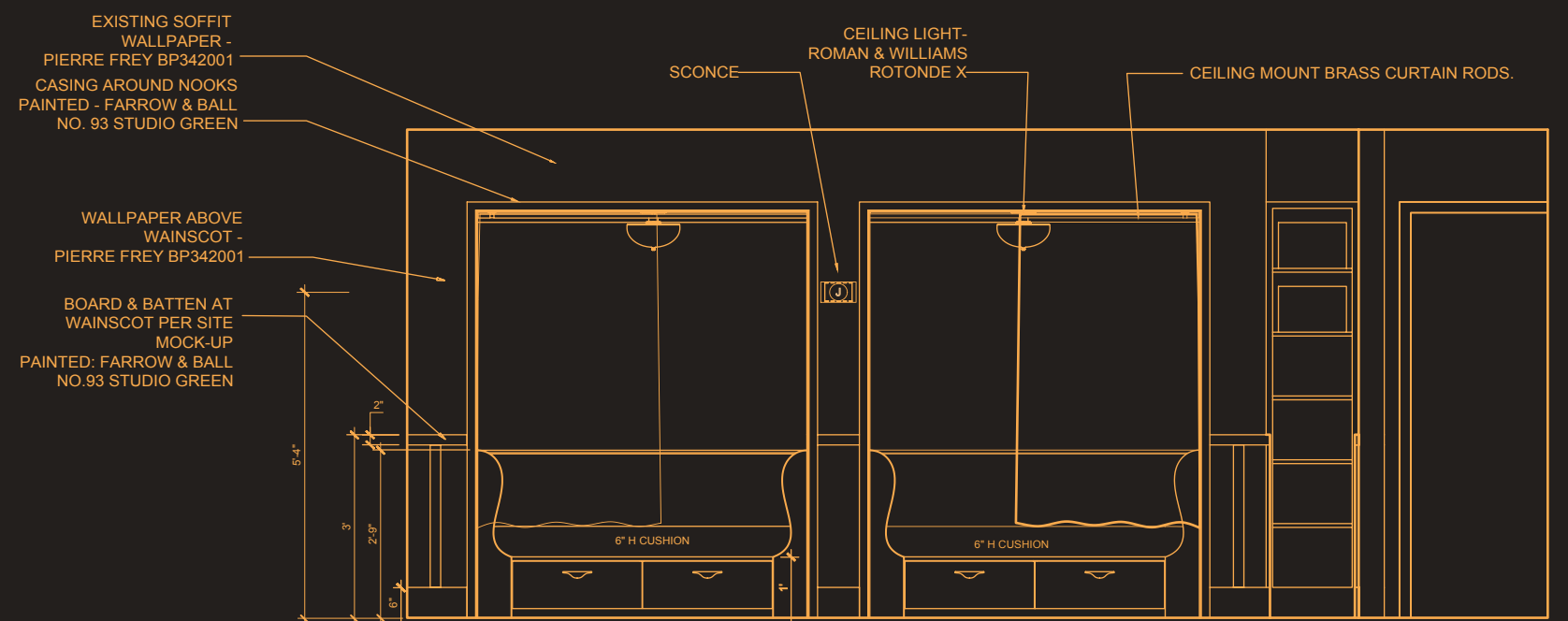

B_ SUGARBOWL SKI CABIN

Office custom built-in desk and window covering

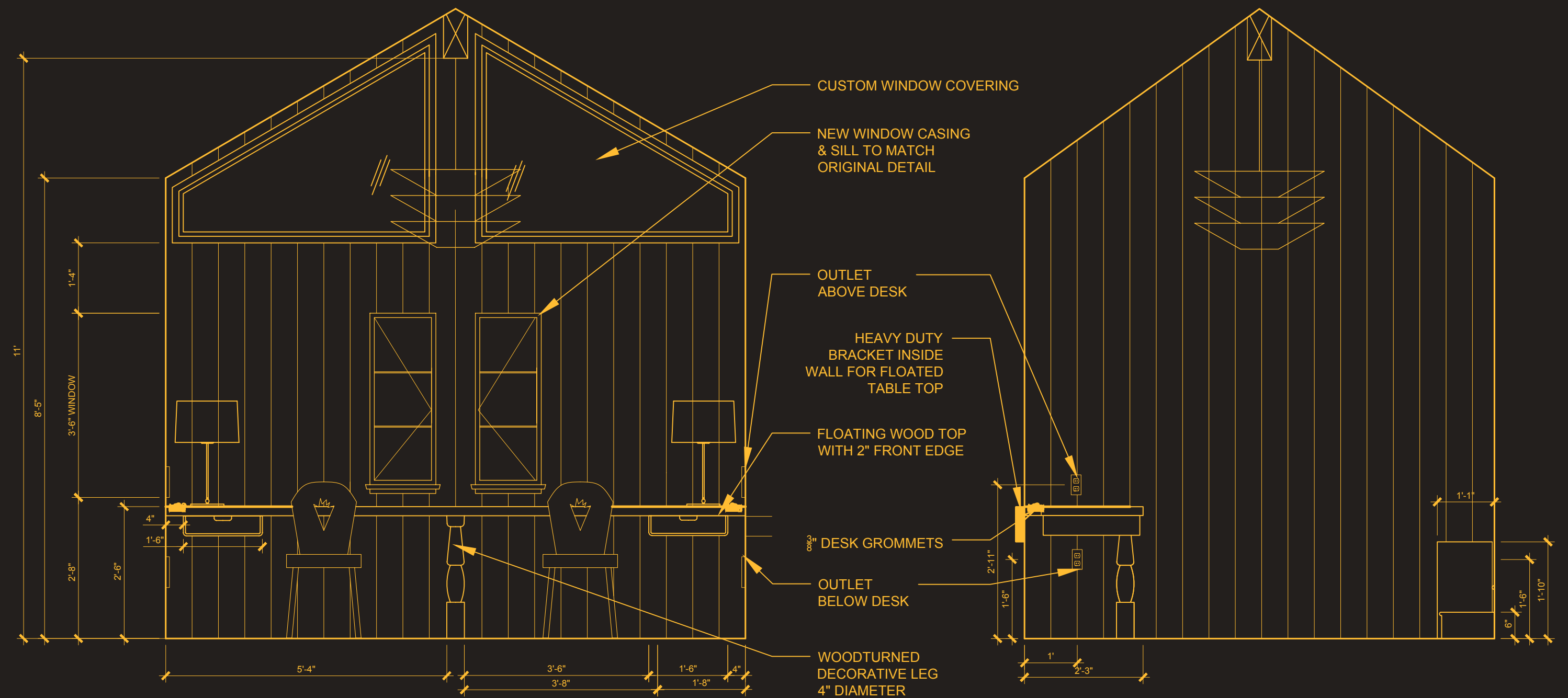





C_ SAN ANSELMO RESIDENCE

A whole house renovation for a retired couple in San Anselmo, California. The structure of this two-level house presents us with an exceptional opportunity to develop an unusual staircase design.





C_ SAN ANSELMO RESIDENCE

Kitchen cabinetry design development and prototype

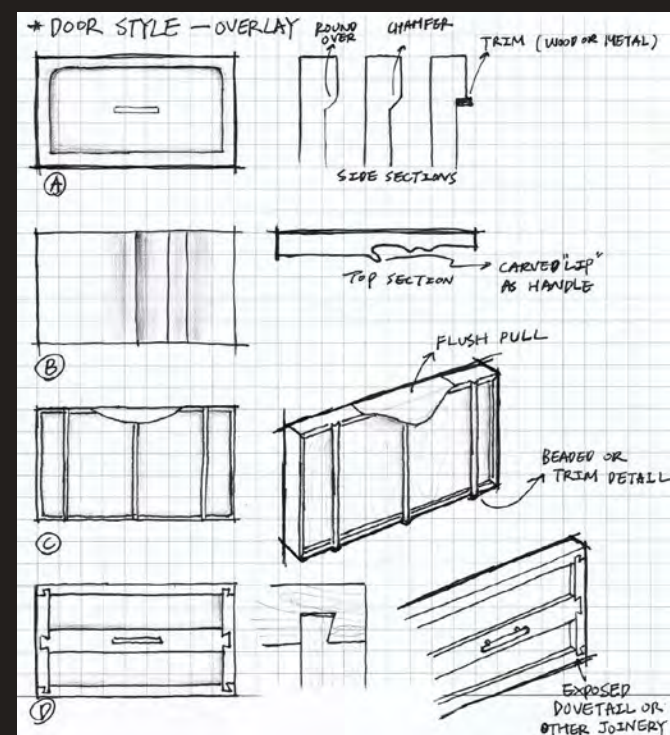

C_ SAN ANSELMO RESIDENCE

Powder room custom wall covering and lighting design development





D_ CUSTOM SHELF UNIT





Within existing living room layout, this corner shelf unit decorates the previously dead space with the client's book and art collections.

Material: Solid Maple, wood stains & finishes



TOP ELEVATION

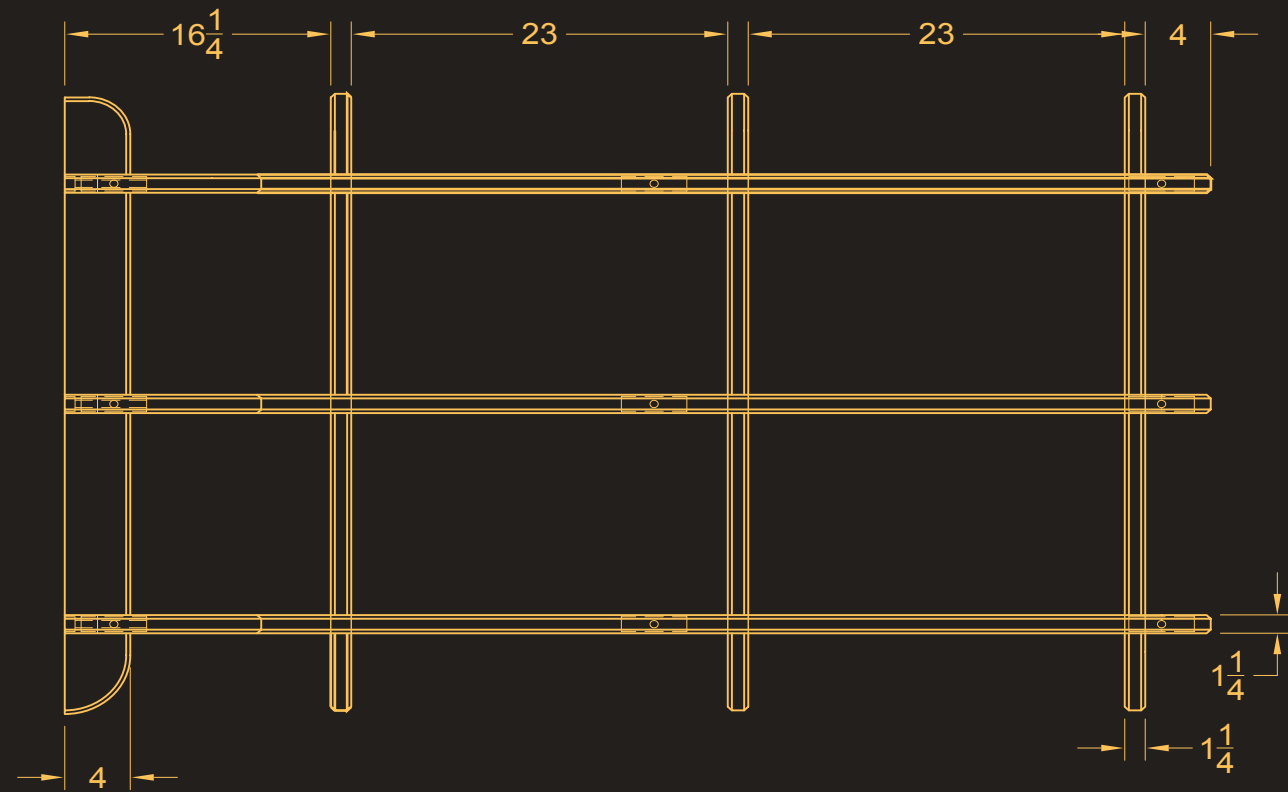

FRONT ELEVATION

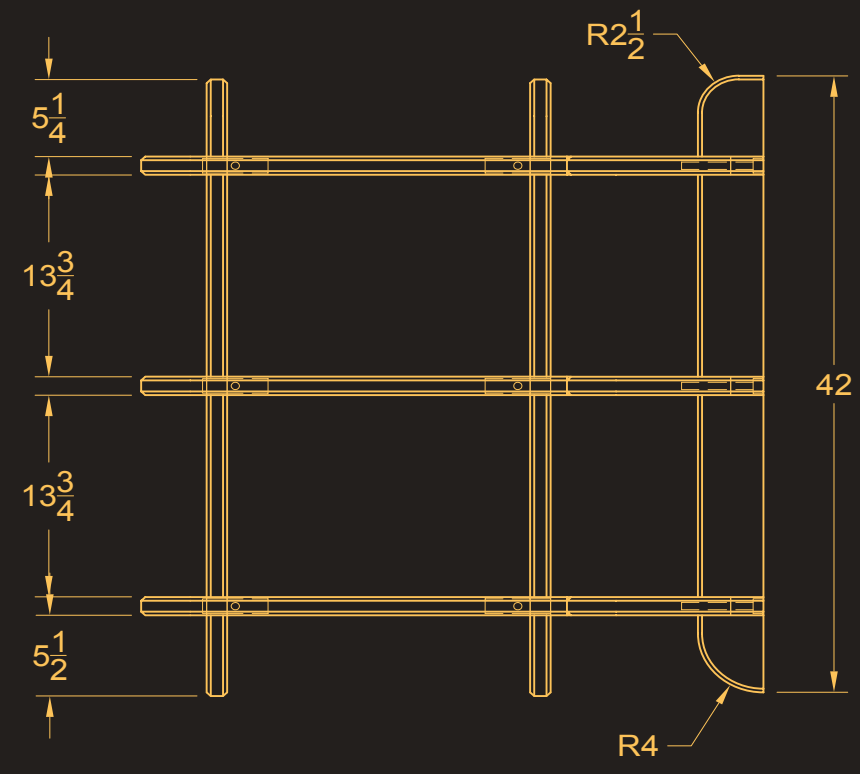
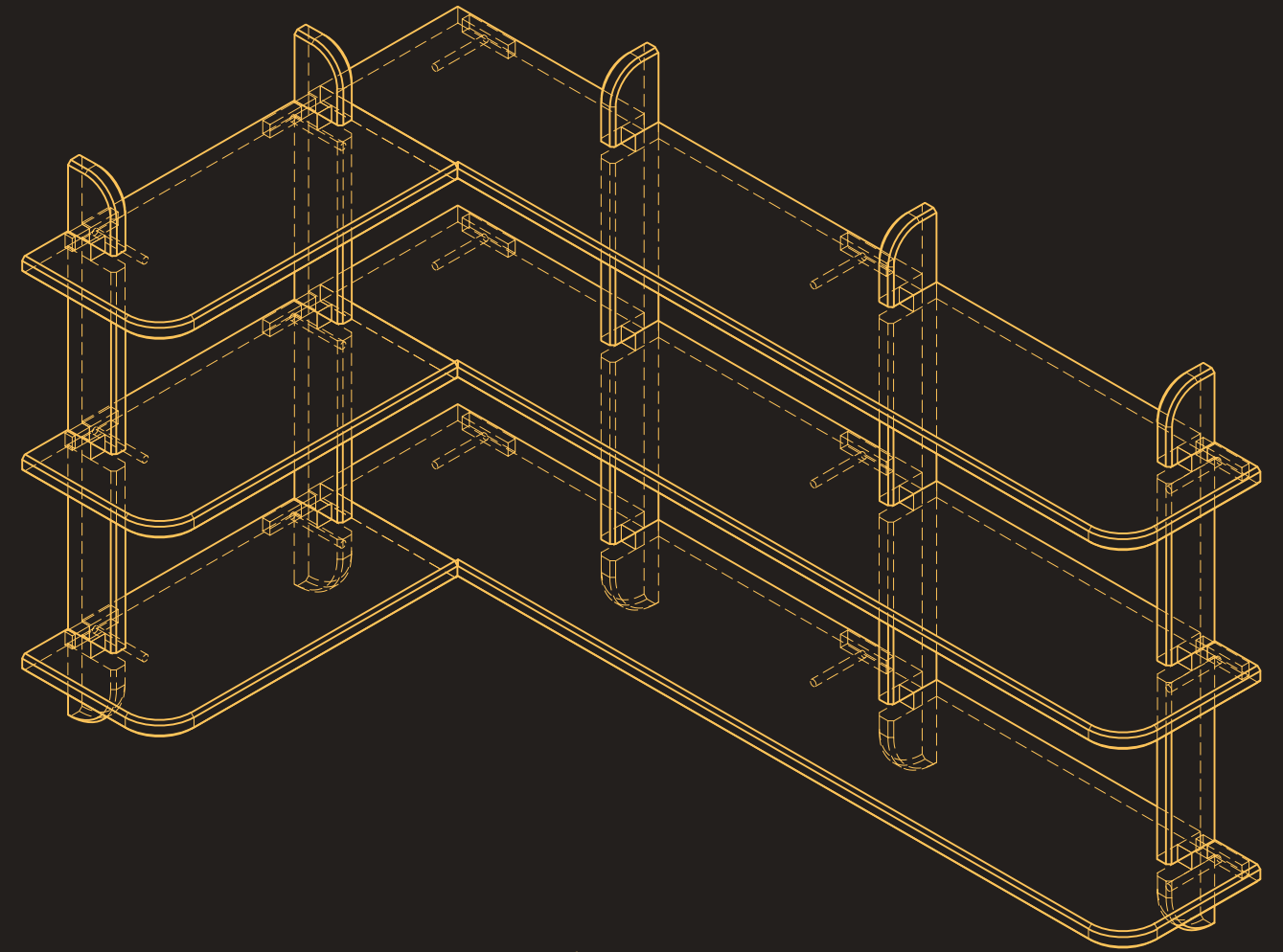

SIDE ELEVATION





E_ BWL LOUNGE CHAIR PROTOTYPE



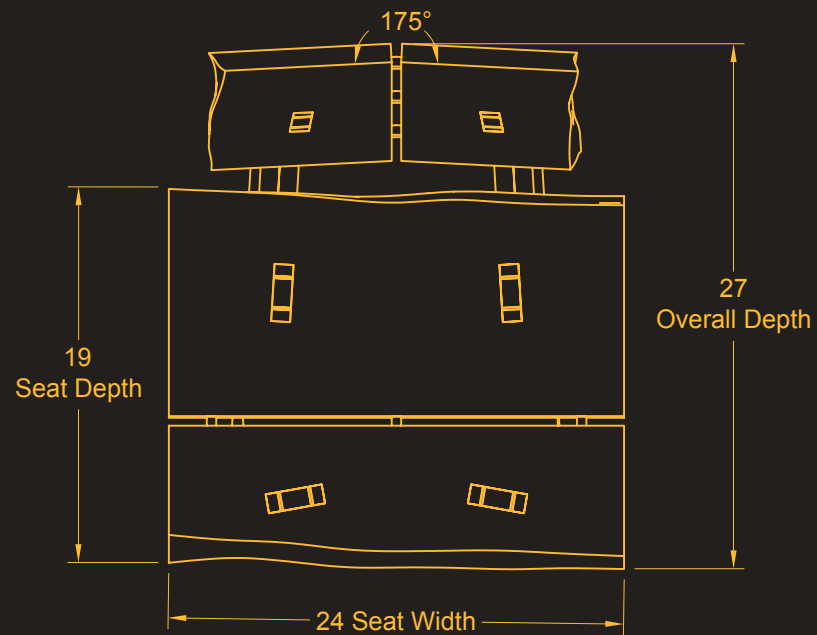

TOP ELEVATION

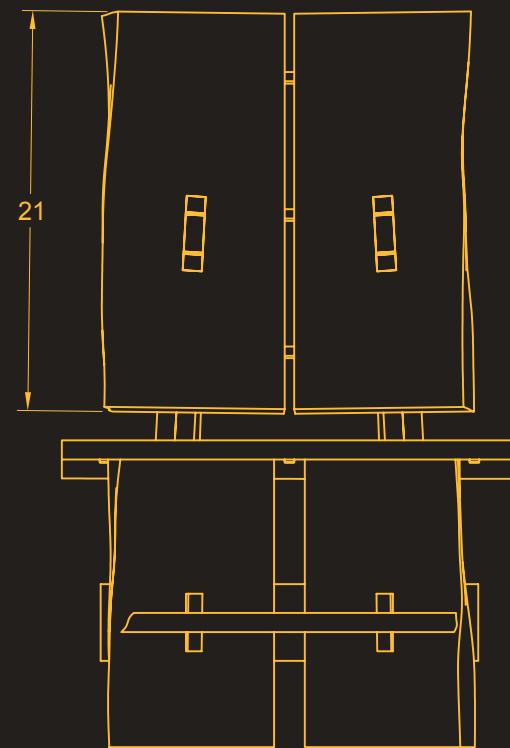

FRONT ELEVATION

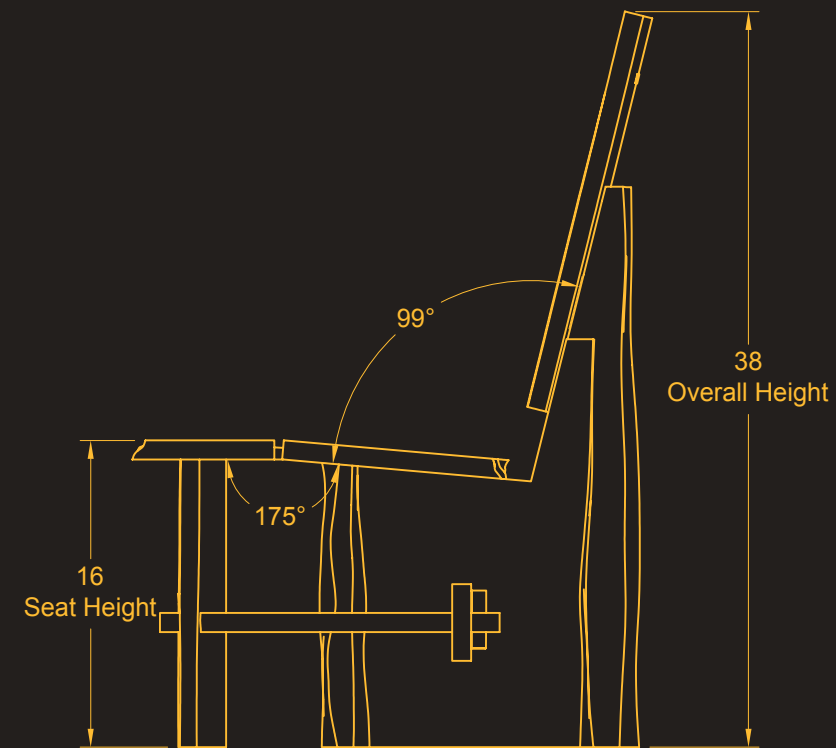

SIDE ELEVATION

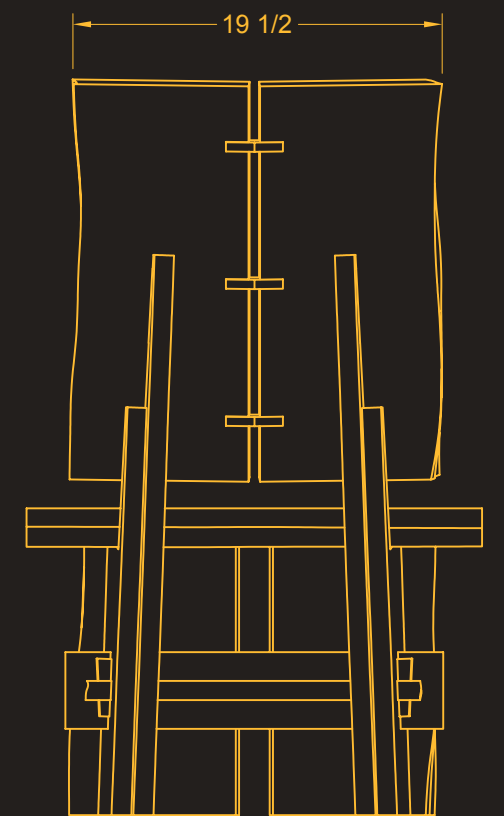

BACK ELEVATION

In collaboration with the UC Berkeley Wood lab, this lounge chair design examines the role of craft in our relationship with natural materials.

The chair uses side boards of milled lumber with live edge boards, an off-cut, or waste part from the typical milling process. The chair has a deeper seat angle, ideal for reflection and rest. Inspired by traditional mortise and tenon joinery, the wood joinery allows for future disassembly and repair. The live edge, a natural feature resulting from the milling process, is celebrated as an element of design, bringing softness and biophilia.

Material: Solid Pine, wood stains & finishes.



F_ FOLD DRESSER

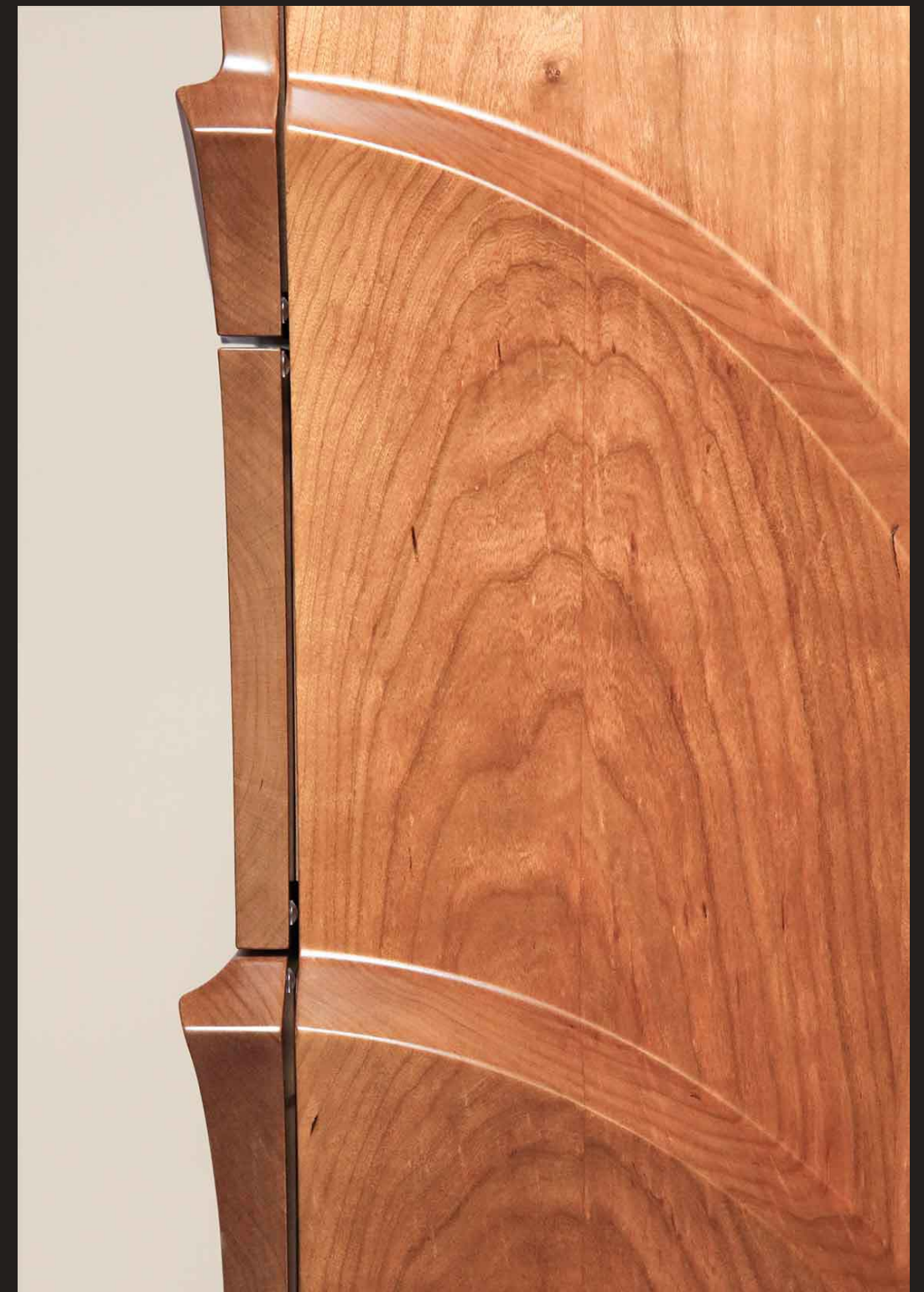



Fold dresser is a modern take on art deco forms. Asymmetrical folds expand from the drawer front to one side of the dresser. The transition between drawer fronts and the sculpted sidewall creates an eye-catching focal point as you walk around the dresser.

The flat side allows customizable configurations. One can use it as a stand-alone dresser in a corner or double up as a mirrored pair in a room.

Material: Solid Cherry & Maple, wood finishes.



G_ INNER FLAME LIQUOR CABINET



Inner Flame is a liquor cabinet design inspired by the burning fire pattern and a Taiwanese temple's rooftop design. The exterior carcass follows the arch shape of the stained glass. There's a floating shelf inside to store your drinking glasses and wine and liquor storage below.

Material: Solid Oak, Granite stone top, stained glass, wallpaper, wood stains & finishes.

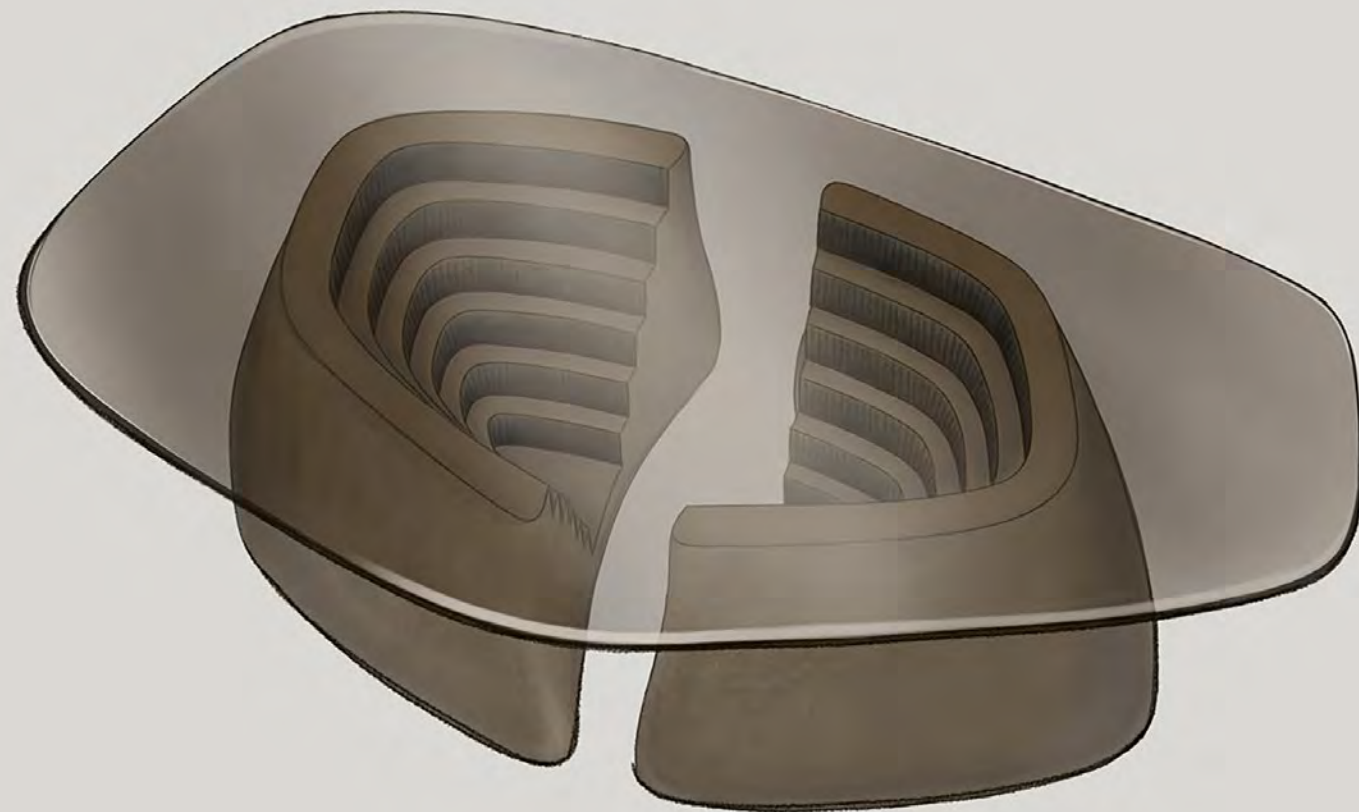

H_ CASCADE COFFEE TABLE

Cascade coffee table takes reference to stalactite forms and how they are reflected on still water lake. Each layer cascades down towards the earth, drawing attention as you approach closer.

Material: Solid Ash, smoky glass, stained glass tiles, wood stain and finishes

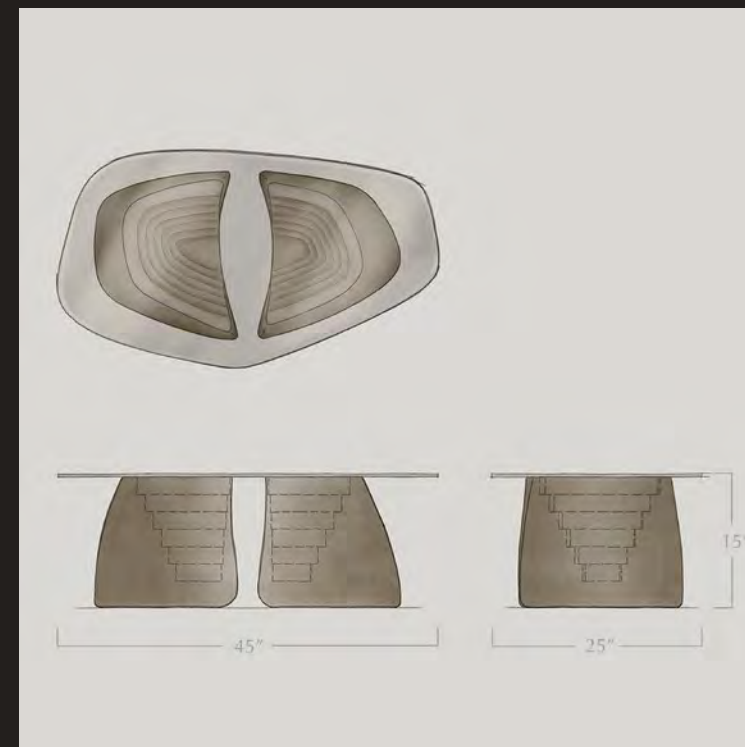

I_ HIDDEN ASSEMBLY

When a pianist performs on an elegantly crafted grand piano, the intricate mechanisms of the piano become alive, and the movements of the keys can be seen on the reflective surface of the piano finish. Drawing inspiration from moments of synergy between the pianist and the instrument, Hidden Assembly reimagines everyday interactions between humans and furniture.

A two-seat bench with a piano finish on the seat surface reflects the live edge wood grains of the bench back, subtly inviting curious minds to sit and share the bench. Upon closer look, Hidden Assembly can be found to form a small tabletop, as well as pillows for added comfort. When the assembly is revealed, the bench offers a space for individuals to share conversations and reflections with one another.

Material: Solid Walnut, indigo linen, wood stains and finishes.



J_ EXPERIMENTAL FURNITURE



Electric cello



Synesthesia organ



Infinity clock



THANK YOU.