

east los angeles transit park

East Los Angeles Transit Park will satisfy the underlying need from Caltrans for infrastructure development while providing for the community needs. The project will bring public transportation to the people, and the people to the park to increase social interaction and strengthen the community. The park space and infrastructure operate on various levels to create a layered network of movement systems. Park users experience slow speeds of informal activities layered above the fast speeds of vehicular motion. The Transit Center provides public bus transportation with mediation between the park by means of level alterations according to speeds. Through an intricate play of architecture, landscape architecture, infrastructure, transit, and park, the East Los Angeles Transit Park reconnects the community and sets a new tone for public transportation.

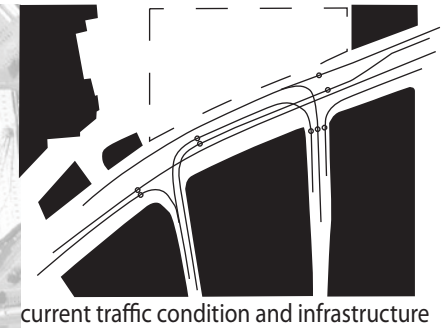

current traffic condition and infrastructure

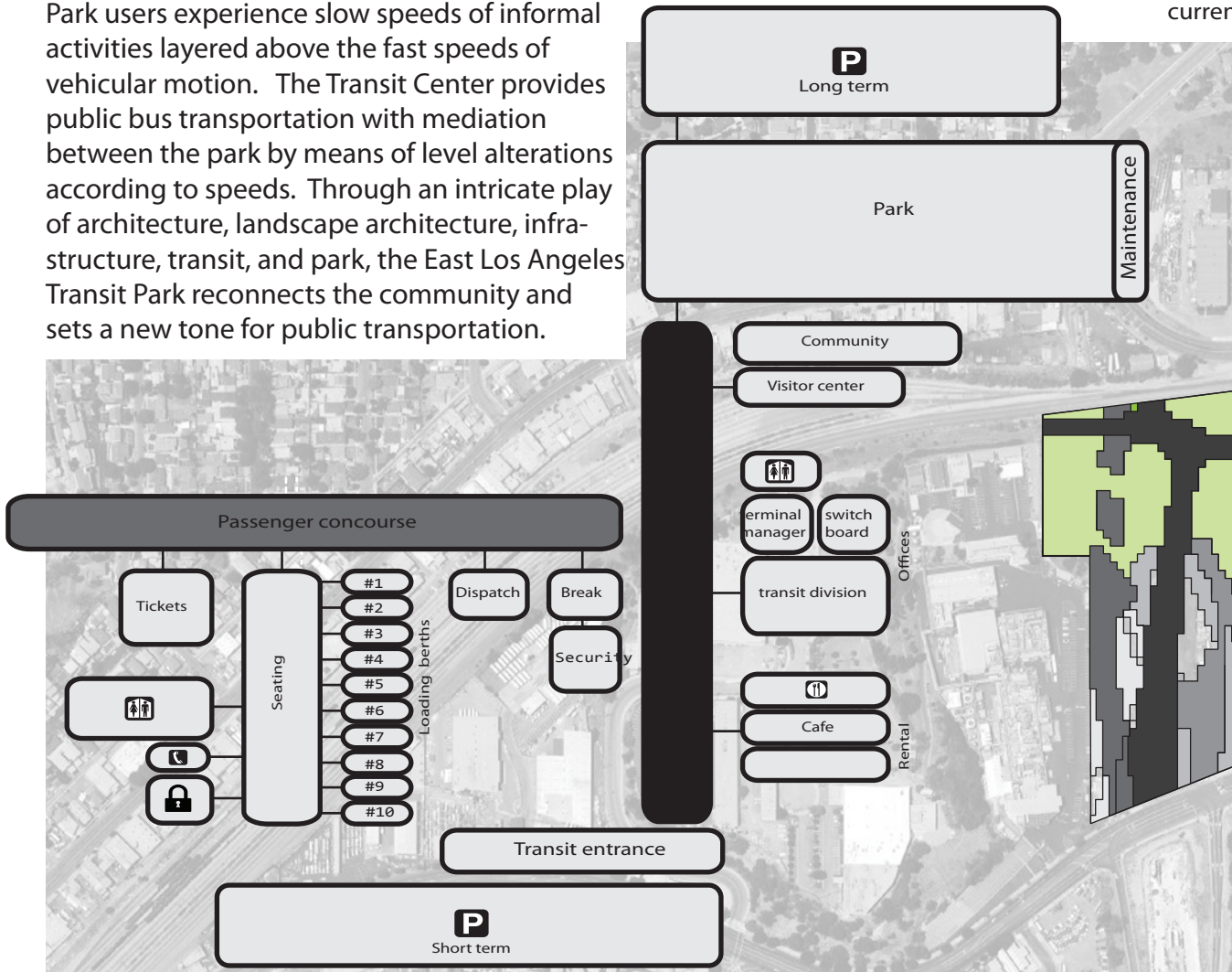
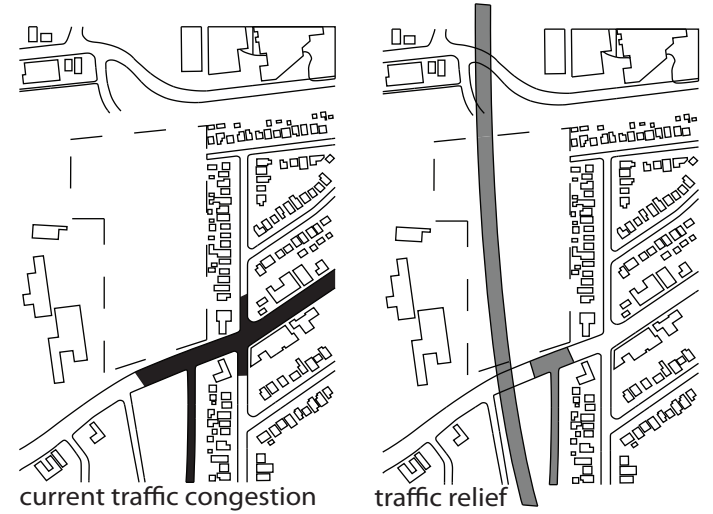
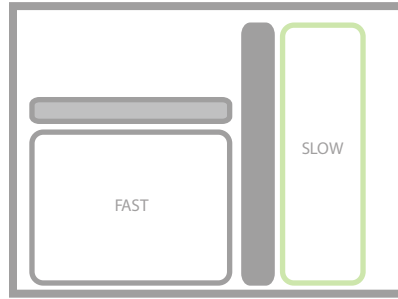
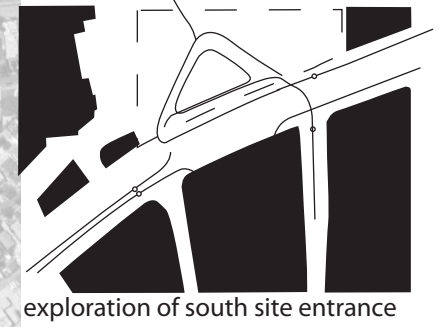

exploration of south site entrance

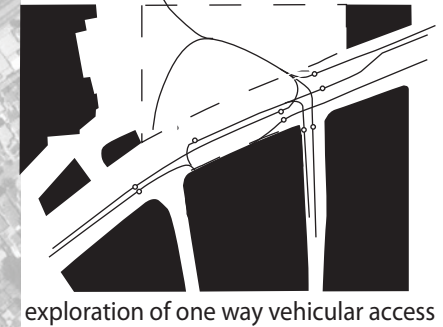

exploration of one way vehicular access

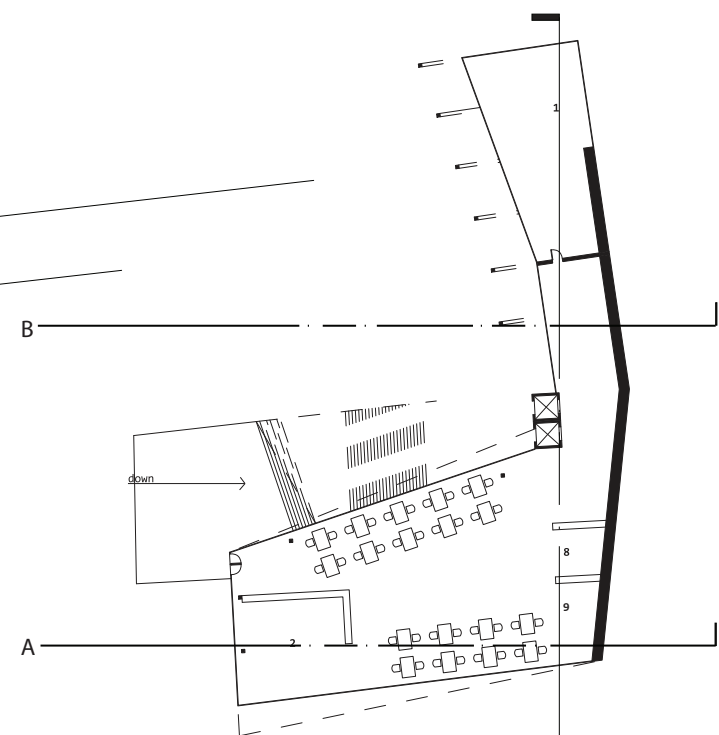
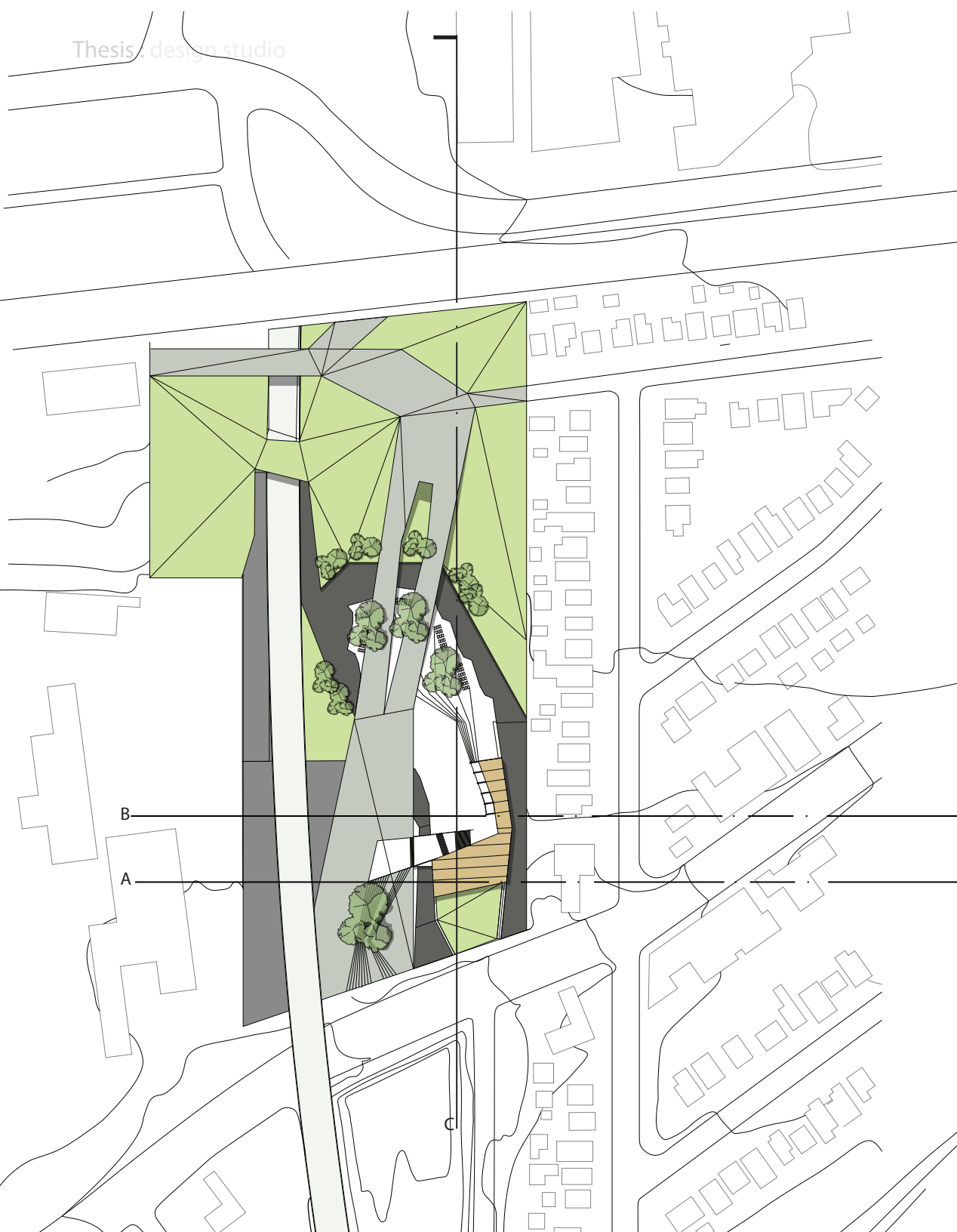

Upper Floor Plan

1	community room	1,800 sqft
2	visitor center	1,100 sqft
3	restroom	1,148 sqft
4	transit division offices	2,946 sqft
5	security	250 sqft
6	greyhound	250 sqft
7	tickets	250 sqft
8	cafe	200 sqft
9	deli	200 sqft
10	dispatch	250 sqft
11	break room	700 sqft
12	mechanical	850 sqft
13	trash	130 sqft

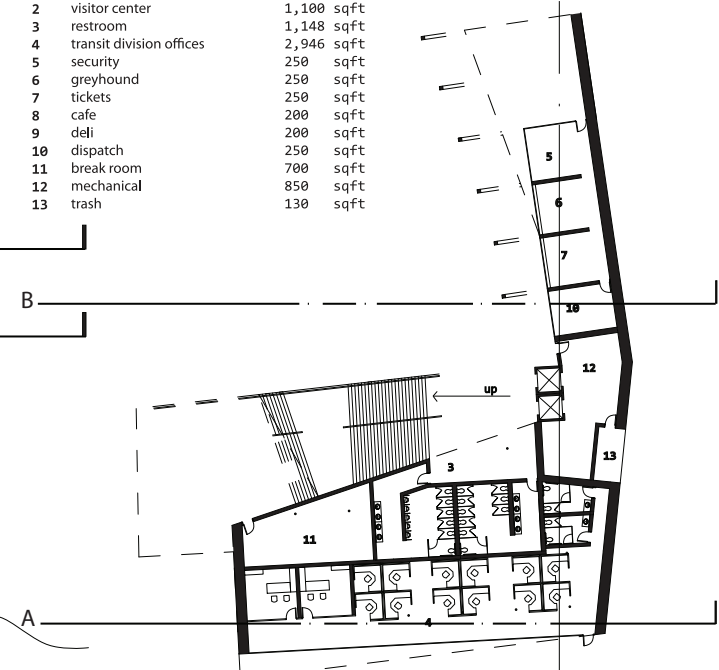

Lower Floor Plan