

POD DETAIL

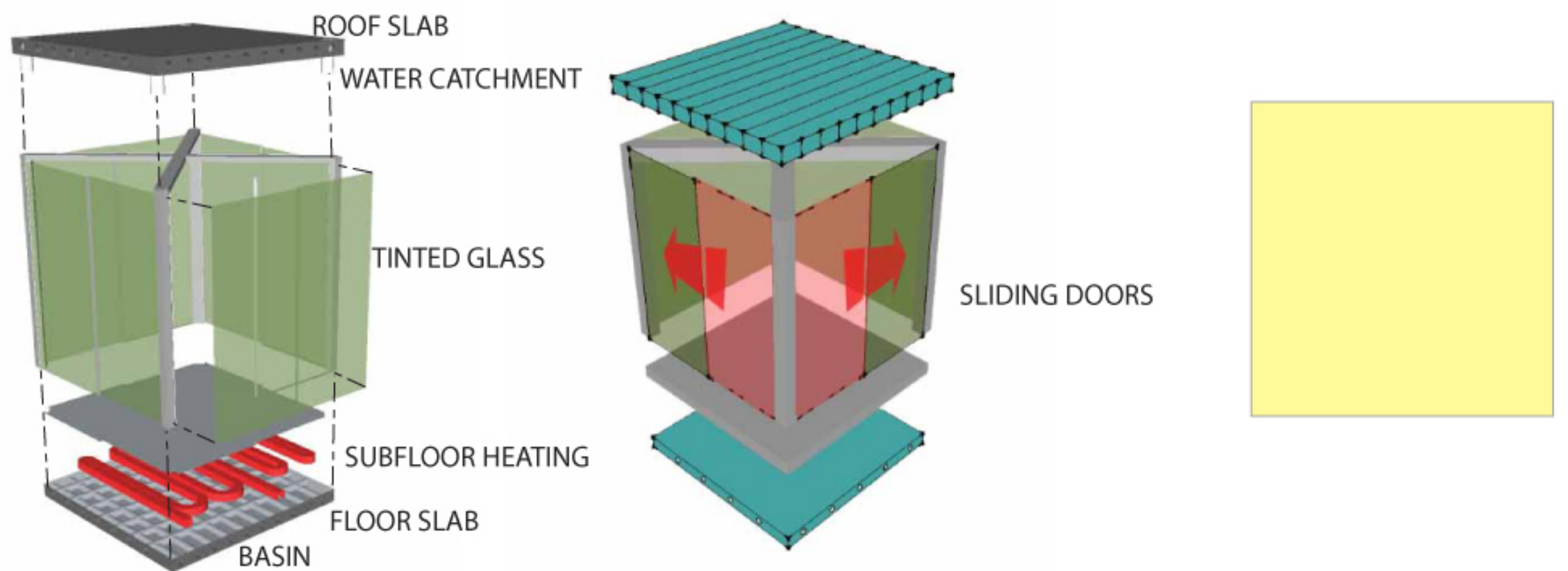

FUNCTIONS OF THE POD

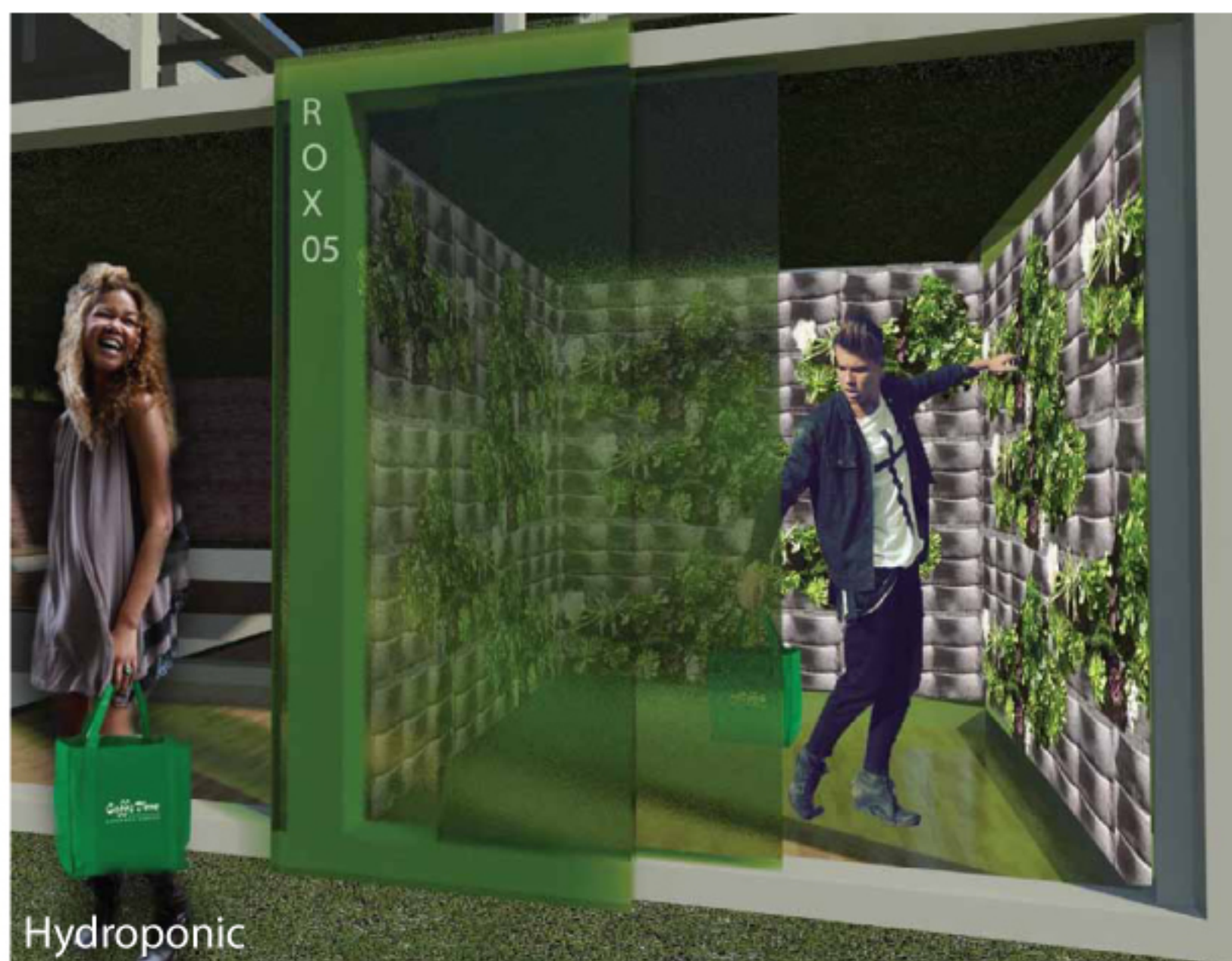
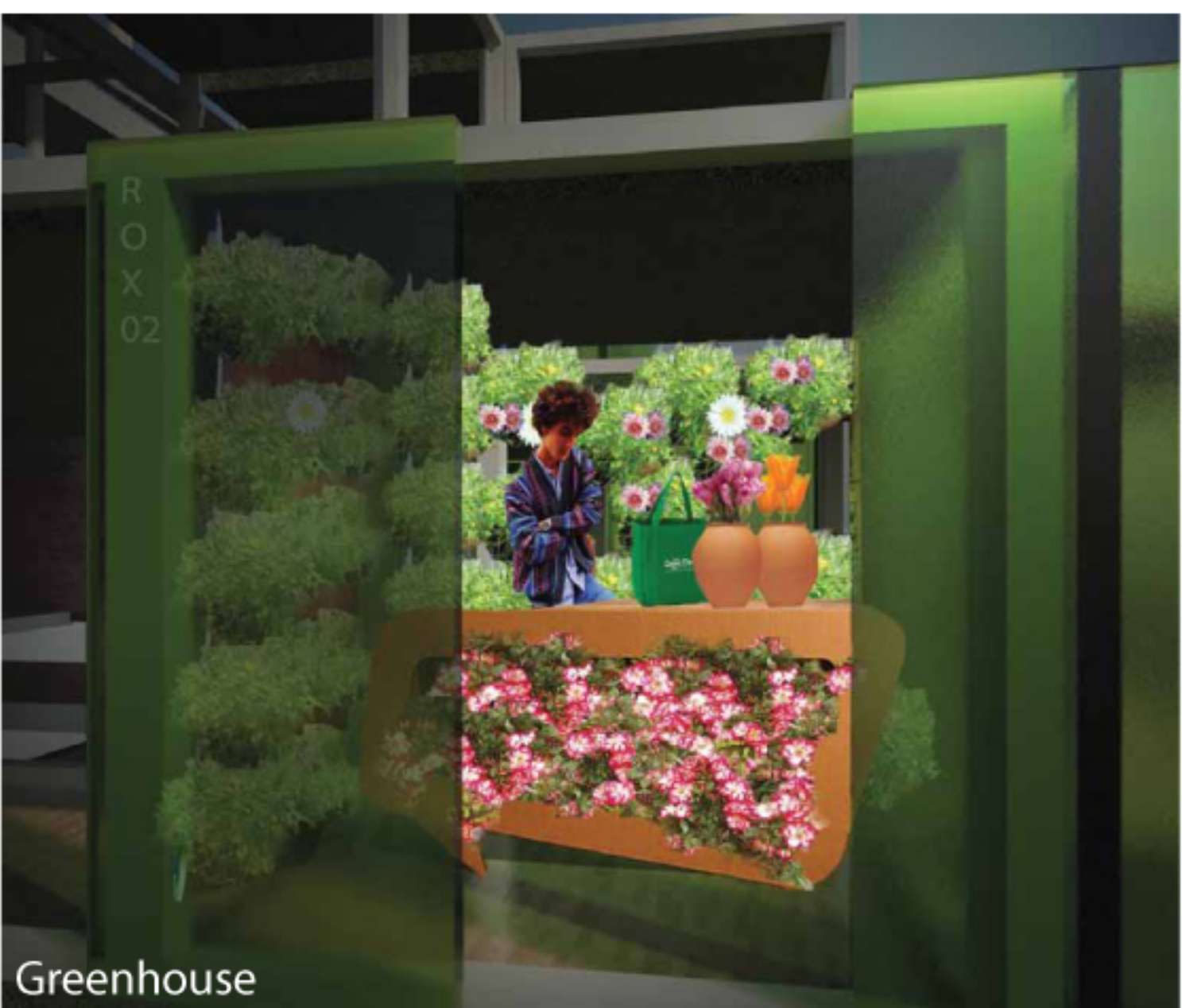

EAST ELEVATION

WEST ELEVATION

LEED 2009 for New Construction and Major Renovations
Project Checklist

Economy Through Ecology, Roxbury, Massachusetts
Oct 1, 2010

Category	Points	Subcategory	Points	Subcategory	Points		
0 0 0	Sustainable Sites	Possible Points: 26		Materials and Resources, Continued			
Y	Prereq 1	Construction Activity Pollution Prevention	1	X	Cred 4	Recycled Content	1 to 2
X	Cred 1	Site Selection	1	X	Cred 5	Regional Materials	1 to 2
X	Cred 2	Development Density and Community Connectivity	5	X	Cred 6	Rapidly Renewable Materials	1
X	Cred 3	Brownfield Redevelopment	1	X	Cred 7	Certified Wood	1
X	Cred 4.1	Alternative Transportation—Public Transportation Access	6				
X	Cred 4.2	Alternative Transportation—Bicycle Storage and Changing Rooms	1	13 0 1	Indoor Environmental Quality	Possible Points: 15	
X	Cred 4.3	Alternative Transportation—Low-Emitting and Fuel-Efficient Vehicles	3	Y	Prereq 1	Minimum Indoor Air Quality Performance	0
X	Cred 4.4	Alternative Transportation—Parking Capacity	2	Y	Prereq 2	Environmental Tobacco Smoke (ETS) Control	0
X	Cred 5.1	Site Development—Protect or Restore Habitat	1	X	Cred 1	Outdoor Air Delivery Monitoring	1
X	Cred 5.2	Site Development—Maximize Open Space	1	X	Cred 2	Increased Ventilation	1
X	Cred 6.1	Stormwater Design—Quantity Control	1	X	Cred 3.1	Construction IAQ Management Plan—During Construction	1
X	Cred 6.2	Stormwater Design—Quality Control	1	X	Cred 3.2	Construction IAQ Management Plan—Before Occupancy	1
X	Cred 7.1	Heat Island Effect—Non-roof	1	X	Cred 4.1	Low-Emitting Materials—Adhesives and Sealants	1
X	Cred 7.2	Heat Island Effect—Roof	1	X	Cred 4.2	Low-Emitting Materials—Paints and Coatings	1
X	Cred 8	Light Pollution Reduction	1	X	Cred 4.3	Low-Emitting Materials—Flooring Systems	1
				X	Cred 4.4	Low-Emitting Materials—Composite Wood and Agrifiber Products	1
17 0 9	Water Efficiency	Possible Points: 10		X	Cred 5	Indoor Chemical and Pollutant Source Control	1
Y	Prereq 1	Water Use Reduction—20% Reduction	2 to 4	X	Cred 6.1	Controllability of Systems—Lighting	1
X	Cred 1	Water Efficient Landscaping	2 to 4	X	Cred 6.2	Controllability of Systems—Thermal Comfort	1
X	Cred 2	Innovative Wastewater Technologies	2	X	Cred 7.1	Thermal Comfort—Design	1
X	Cred 3	Water Use Reduction	2 to 4	X	Cred 7.2	Thermal Comfort—Ventilation	1
				X	Cred 8.1	Daylight and Views—Daylight	1
				X	Cred 8.2	Daylight and Views—Views	1
10 0 0	Energy and Atmosphere	Possible Points: 35					
Y	Prereq 1	Fundamental Commissioning of Building Energy Systems	0	14 0 1	Innovation in Design Process	Possible Points: 6	
Y	Prereq 2	Minimum Energy Performance	0	Cred 1.1	Innovation in Design: Specific Title	1	
Y	Prereq 3	Fundamental Refrigerant Management	0	Cred 1.2	Innovation in Design: Specific Title	1	
X	Cred 1	Optimize Energy Performance	1 to 19	Cred 1.3	Innovation in Design: Specific Title	1	
Cred 2	On-Site Renewable Energy	1 to 7		Cred 1.4	Innovation in Design: Specific Title	1	
X	Cred 3	Enhanced Commissioning	2	Cred 1.5	Innovation in Design: Specific Title	1	
X	Cred 4	Enhanced Refrigerant Management	2	Cred 2	LEED Accredited Professional	1	
X	Cred 5	Measurement and Verification	3				
X	Cred 6	Green Power	2	0 0 0	Regional Priority Credits	Possible Points: 4	
				Cred 1.1	Regional Priority: Specific Credit	1	
28 0 7	Materials and Resources	Possible Points: 14		Cred 1.2	Regional Priority: Specific Credit	1	
Y	Prereq 1	Storage and Collection of Recyclables	0	X	Cred 1.3	Regional Priority: Specific Credit	1
Cred 1.1	Building Reuse—Maintain Existing Walls, Floors, and Roof	1 to 3		X	Cred 1.4	Regional Priority: Specific Credit	1
X	Cred 1.2	Building Reuse—Maintain 50% of Interior Non-Structural Elements	1				
X	Cred 2	Construction Waste Management	1 to 2				
X	Cred 3	Materials Reuse	1 to 2				
				82 0 18	Total	Possible Points: 110	