

OPTION 2



HIGH-RISE
MID-RISE

RETAIL/
COMMERCIAL

FAR = 2.21
107,974 m²

SMALL VILLA (31) x 400 = 12,400 12,800
 BIG VILLA (22) x 700 = 15,400
 LOW-RISE (36) x 230 x (5 STRY) = 41,400
 MID-RISE 302 x 190 = 57,380
 HIGH-RISE 10 x 560 x 25 = 140,000
 TOTAL 266,580
 COMMERCIAL/RETAIL = 18,200

OPTION 2

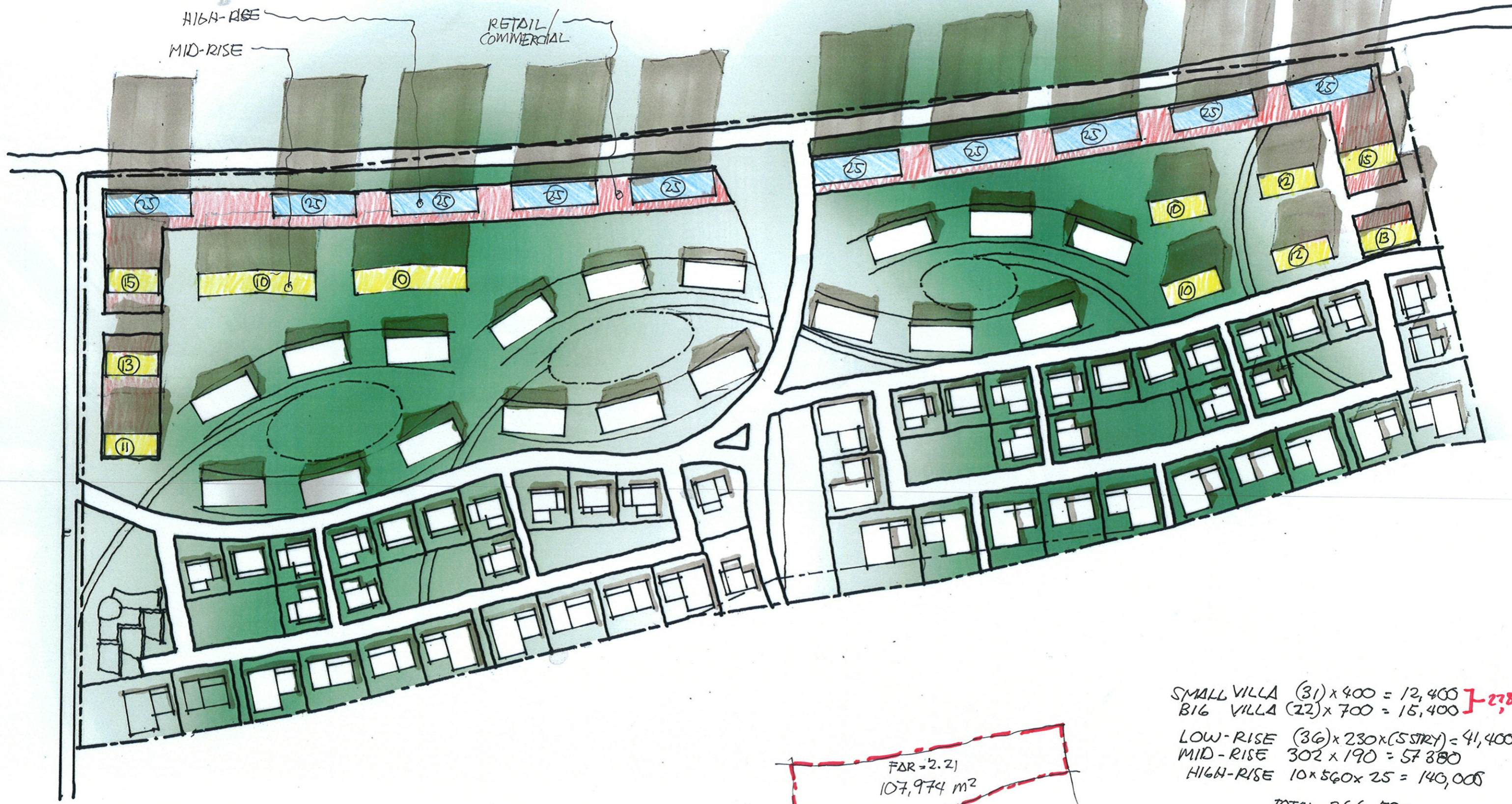

FAR = 2.21
107,974 m²

SMALL VILLA (31) x 400 = 12,400 + 2700
 BIG VILLA (22) x 700 = 15,400
 LOW-RISE (36) x 230 x (5 STRY) = 41,400 ✓
 MID-RISE 302 x 190 = 57,380
 HIGH-RISE 10 x 560 x 25 = 140,000
 TOTAL 266,580
 COMMERCIAL/RETAIL = 18,200